



Western Michigan University
ScholarWorks at WMU

Legacy Scout Tickets from Pure Oil Company

8-20-2021

**MGRRE_PureOilScoutTickets_Donovan, J. M.
(Mm-96)_1_21129021980000**

MGRRE
Western Michigan University

Follow this and additional works at: <https://scholarworks.wmich.edu/pure>



Part of the Geology Commons

WMU ScholarWorks Citation

MGRRE, "MGRRE_PureOilScoutTickets_Donovan, J. M. (Mm-96)_1_21129021980000" (2021). *Legacy Scout Tickets from Pure Oil Company*. 7780.
<https://scholarworks.wmich.edu/pure/7780>

This Document is brought to you for free and open access via ScholarWorks at WMU. It has been accepted for inclusion in Legacy Scout Tickets from Pure Oil Company by an authorized administrator of ScholarWorks at WMU. See the National Digital Catalogue - Science Base Catalogue for more collections submitted by MGRRE.



MGRRE_PureOilScoutTickets_Donovan, J. M. (Mm-96)_1_21129021980000

API 21129021980000

Permit Number 2198

Lease Name Donovan, J. M. (Mm-96)

Well Number 1

County Ogemaw

Township 22N

Range 02E

Section 19

2021 DEQ or Pure co_name Muskegon Development Company

Pure Number 85

Latitude 44.2864256

Longitude -84.2374172

WELL REPORT - OUTSIDE OPERATIONS

SERIAL NO. 85-111

STATE Michigan ^{PSEHC} CO. Ogemaw
OPERATOR Russell Schubert & Gertrude Schubert
FARM Jane M. Donavan WELL NO. 1-3
TWP. West Branch S. 19 T. 22N R. 2E
SURVEY
LOC.

WILDCAT ☐ FIELD ☐ FIELD NAME

MAP NO. CO-ORD. ELEV.

STATUS

Operator's name changed from:
Ide Oil & Gas Corporation

NORTH

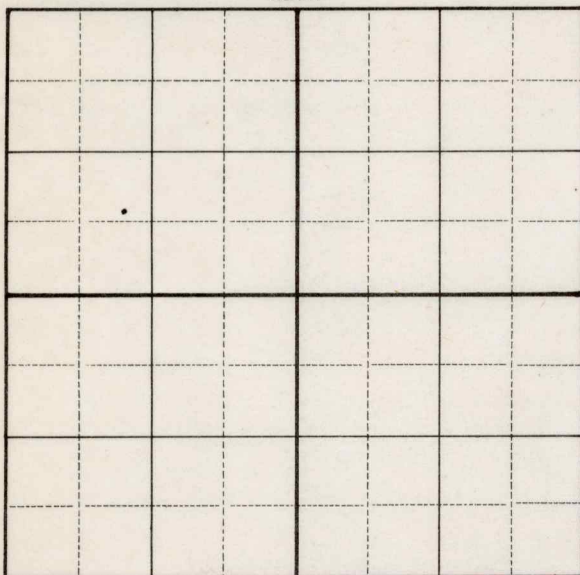
DATE 7-6-48 SCOUT H. J. G.

THE PURE OIL COMPANY

LOCATION REPORT

DATE October 11, 1934

No. 85

STATE Michigan COUNTY Ogemaw DIST. West Branch SEC. 19 TOWN 22N RANGE 2E

WELL No. 1 (SERIAL No. 85) FARM Jane M. Donovan ACRES NE-SE-NW, NE-SE-NW

NAME OF STREAM OR WATERS _____ QUADRANGLE NE-SE-NW, NE-SE-NW

OPERATOR Ide Oil & Gas Corporation Map West Branch Township, Ogemaw County
West Branch - Oge.

330 330 Feet from North Line of Farm

390 380 " " East " " "

" " South " " "

" " West " " "

Feet from North Line of Section

380 380 " " East " 1/4 "

990 990 " " South " 1/4 "

" " West " " "

LEGEND

- LOCATION
- ⊕ RIG
- ⊕ DRILLING
- ☀ GAS WELL
- OIL WELL
- ⊕ SMALL OIL WELL
- ⊕ DRY HOLE
- ⊕ DRY SHOWING OIL
- ⊕ DRY SHOWING GAS
- ⊕ ABANDONED LOCATION
- ☀ ABANDONED GAS WELL
- ⊕ ABANDONED OIL WELL

NOTE: Below make tracing from map, (when no map is obtainable make sketch) showing farm, center of section, this location with measurements and also wells, dry holes, or other locations in the vicinity of this location.

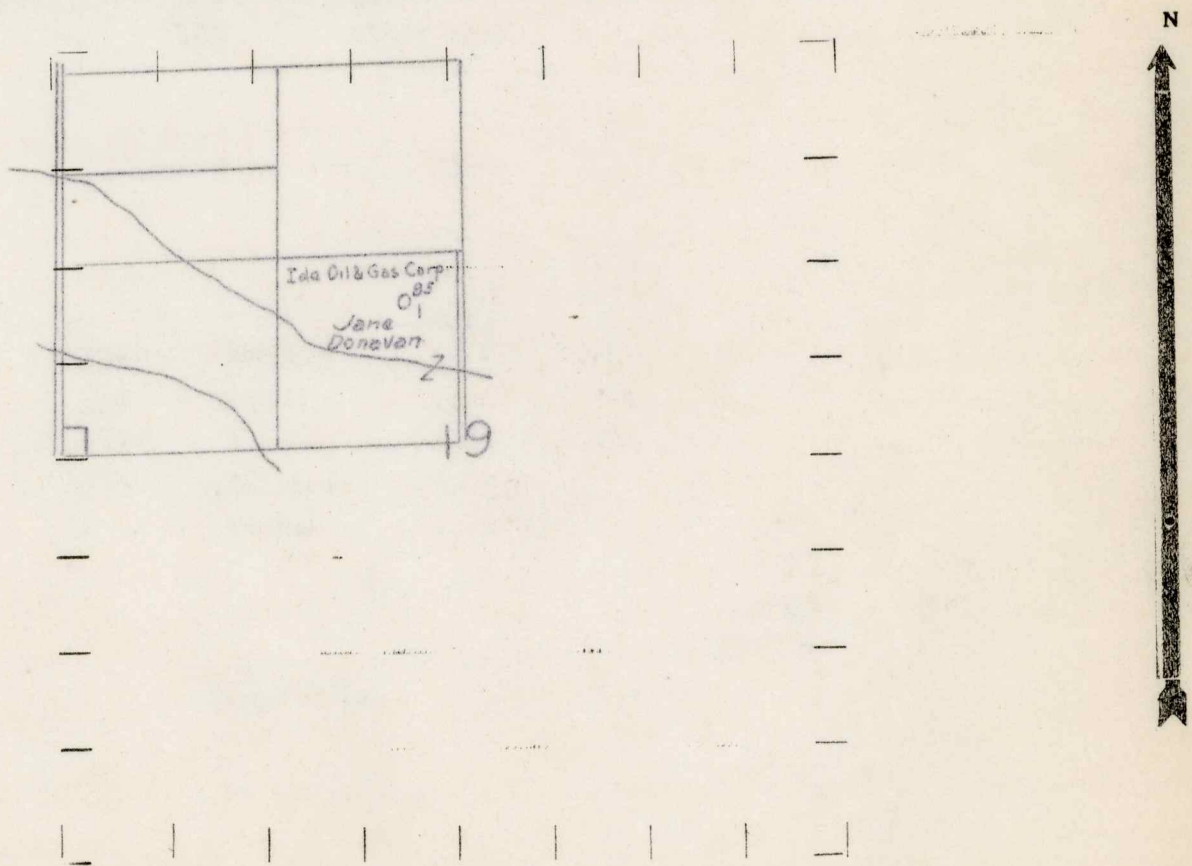

REMARKS:

SIGNED

R. L. Yeager
Superintendent or Foreman.

THE PURE OIL COMPANY

Michigan Producing DIVISION

COMPLETION RECORD

No. 85

DATE 12/6/34

STATE Michigan

COUNTY Ogemaw

DIST. TWP. WestBranch SEC. 19

TOWN 22N RANGE 2E

WELL No. 1 (SERIAL No. 85) FARM

Jane M. Donovan

ACRES

NAME OF STREAM OR WATERS

QUADRANGLE NE-SE-NW

OPERATOR Ide Oil & Gas Corporation

MAP West Branch Township, Ogemaw County

LOCATION REPORT SENT IN (DATE) 10/11/34

WELL STARTED (DATE) 10/14/34

WELL COMPLETED (DATE) 11/24/34

OIL WELL

WATER WELL

INDUSTRIAL WELL

GEOTHERMAL WELL

Elevation 966.1'

CROSS OUT THREE OF THE ABOVE
WELL RECORD

DATE OF acid 12/1/34

NUMBER OF gallons QUARTS 1000

1st 24 HOURS PRODUCTION 20 bbls., natural

BARRELS OR FEET

1st 2nd " " 121 " after acid

3rd " " "

4th " " "

5th " " "

SAND AND CASING

CASING SIZE	WEIGHT	CASING Feet Inches	SAND Name and Nature	TOP	BOTTOM	TOP PAY	BOTTOM PAY	SALT WATER
10"		339	Sunbury	1224	1250			
8 1/4"		527	Berea	1250	1325			
6-5/8		1826	Antrim	1325	1780			
5-3/16		2576	Traverse	1780				
			Dundee	2575		2585	Show	
						2593	2599	
						2660	2687	
						2736	2744	
			Total Depth		2744			

REMARKS

NOTE:—MAKE COPY TO KEEP FOR REFERENCE AND SEND ORIGINAL TO CHICAGO OFFICE. LIST MATERIAL CHARGEABLE TO WELL ON OTHER SIDE.

SIGNED

S. H. Bell

SUPT. OR FOREMAN