



Western Michigan University
ScholarWorks at WMU

Legacy Scout Tickets from Pure Oil Company

8-20-2021

MGRRE_PureOilScoutTickets_Finnerty, Clarence & Gertrude_1_21129022540000

MGRRE
Western Michigan University

Follow this and additional works at: <https://scholarworks.wmich.edu/pure>



Part of the Geology Commons

WMU ScholarWorks Citation

MGRRE, "MGRRE_PureOilScoutTickets_Finnerty, Clarence & Gertrude_1_21129022540000" (2021). *Legacy Scout Tickets from Pure Oil Company*. 7790.
<https://scholarworks.wmich.edu/pure/7790>

This Document is brought to you for free and open access via ScholarWorks at WMU. It has been accepted for inclusion in Legacy Scout Tickets from Pure Oil Company by an authorized administrator of ScholarWorks at WMU. See the National Digital Catalogue - Science Base Catalogue for more collections submitted by MGRRE.



MGRRE_PureOilScoutTickets_Finnerty, Clarence & Gertrude_1_21129022540000

API 21129022540000

Permit Number 2254

Lease Name Finnerty, Clarence & Gertrude

Well Number 1

County Ogemaw

Township 22N

Range 02E

Section 19

2021 DEQ or Pure co_name Sappington, Henry

Pure Number 95

Latitude 44.28105

Longitude -84.2276

WELL REPORT - OUTSIDE OPERATIONS

Oil Company

DRILLED BY OTHER OPERATORS

SERIAL NO. 95

STATE Michigan ~~PSH~~ Ogemaw CO.
OPERATOR Henry Sappington
FARM C. & G. Finnerty WELL NO. 1
TWP. West Branch S. 19 T. 22N R. 2E
LOC. SE NE SE

WILDCAT ☐ FIELD ☒ FIELD NAME West Branch

MAP NO. _____ CO-ORD. _____ ELEV. _____

STATUS Plugged & Abandoned 9-5-51Total Depth 2733'

NORTH

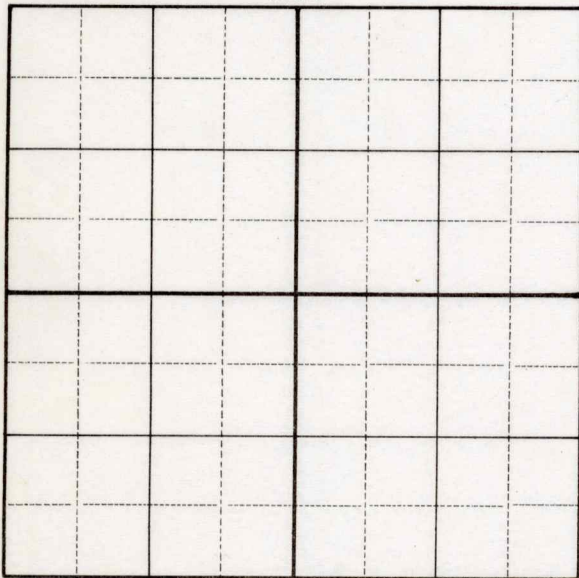
DATE 10-25-51 SCOUT DRS

WELL REPORT

SERIAL NO.

32

Oil Company

SERIAL NO. 95

STATE Michigan ^{XPSM} CO. Ogemaw
OPERATOR Henry Sappington
FARM Clarence & Gertrude Finnerty WELL NO. 1
TWP. West Branch S. 19 T. 22N R. 2E
LOC. SE NE SE

WILDCAT ☐ FIELD ☐ FIELD NAME _____

MAP NO. _____ CO-ORD. _____ ELEV. _____

STATUS _____

Operator changed from: William Kerr &
Associates

NORTH

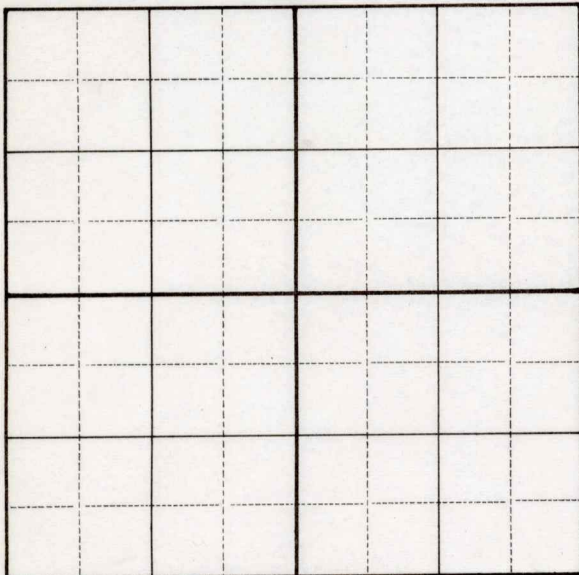
DATE 7-2-51 SCOUT DRS

THE PURE OIL COMPANY

DATE November 28, 1934

LOCATION REPORT

No. 95

22N.

2E.

STATE Michigan

COUNTY

Ogemaw

DIST.

TWP. West BranchSEC. 19TOWN 22NRANGE 2EWELL No. 1 (SERIAL No. 95) FARM

PREC.

Gertrude & Clarence Finnerty

ACRES

NAME OF STREAM OR WATERS

QUADRANGLE

SE-NE-SE
SE-NE-SEOPERATOR Wm. Kerr & Associates

Map

West Branch Township, Ogemaw CountyWm Kerr & Associates

Feet from North Line of Farm

185 185 " " East " " "290 290 " " South " " "

" " West " " "

1030 1030 Feet from North Line of Section465 465 " " East " " "

" " South " " "

" " West " " "

LEGEND

○ LOCATION

⊕ RIG

⊕ DRILLING

☀ GAS WELL

● OIL WELL

⊕ SMALL OIL WELL

⊕ DRY HOLE

⊕ DRY SHOWING OIL

⊕ DRY SHOWING GAS

⊕ ABANDONED LOCATION

☀ ABANDONED GAS WELL

⊕ ABANDONED OIL WELL

NOTE: Below make tracing from map, (when no map is obtainable make sketch) showing farm, center of section, this location with measurements and also wells, dry holes, or other locations in the vicinity of this location.

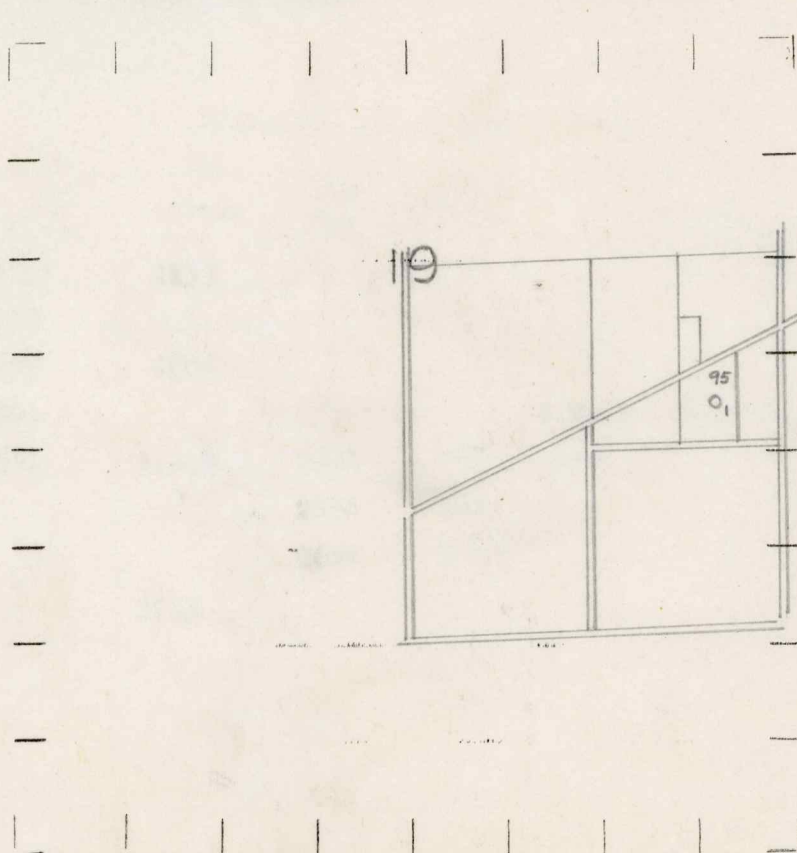

REMARKS:

SIGNED

R. L. Yeager

Superintendent or Foreman.

Signed

G. H. Bell

CORRECTED

PRODUCTION RECORD

FORMATION AND CASING RECORD

Remarks Recently deepened from 2733 to 2751 - Increase in Oil & Gas.

Signed S. N. Bell