



Western Michigan University
ScholarWorks at WMU

Legacy Scout Tickets from Pure Oil Company

8-20-2021

MGRRE_PureOilScoutTickets_Fisk_2_21129023510000

MGRRE

Western Michigan University

Follow this and additional works at: <https://scholarworks.wmich.edu/pure>



Part of the Geology Commons

WMU ScholarWorks Citation

MGRRE, "MGRRE_PureOilScoutTickets_Fisk_2_21129023510000" (2021). *Legacy Scout Tickets from Pure Oil Company*. 7828.

<https://scholarworks.wmich.edu/pure/7828>

This Document is brought to you for free and open access via ScholarWorks at WMU. It has been accepted for inclusion in Legacy Scout Tickets from Pure Oil Company by an authorized administrator of ScholarWorks at WMU. See the National Digital Catalogue - Science Base Catalogue for more collections submitted by MGRRE.



MGRRE_PureOilScoutTickets_Fisk_2_21129023510000

API 21129023510000

Permit Number 2351

Lease Name Fisk

Well Number 2

County Ogemaw

Township 22N

Range 02E

Section 20

2021 DEQ or Pure co_name Morris, Vanjeuren Oil and Gas Syndicate

Pure Number 133

Latitude 44.27985

Longitude -84.20977

THE PURE OIL COMPANY

DATE February 15, 1940

LOCATION REPORT

No. 133

STATE Michigan COUNTY Ogemaw ^{Oge} ~~DIST~~ ^{W-Branch} TWP West Branch SEC 20 TOWN 22 N RANGE 2 E
WELL No. 2 (SERIAL No. 133) FARM Fisk ~~PRBX~~ ACRES

NAME OF STREAM OR WATERS _____ QUADRANGLE NW SE SE

OPERATOR Morris-Van Keuren Map West Branch Township, Ogemaw County
Morris-Van Keuren W-Branch - Oge.

_____ Feet from North Line of Farm

_____ " " East " " "

_____ " " South " " "

_____ " " West " " "

_____ Feet from North Line of Section

_____ " " East " " "

_____ " " South " " "

_____ " " West " " "

LEGEND

○ LOCATION

① RIG

⊕ DRILLING

☼ GAS WELL

● OIL WELL

⦿ SMALL OIL WELL

⊙ DRY HOLE

⦿ DRY SHOWING OIL

⊙ DRY SHOWING GAS

⦿ ABANDONED LOCATION

☼ ABANDONED GAS WELL

⦿ ABANDONED OIL WELL

NOTE: Below make tracing from map, (when no map is obtainable make sketch) showing farm, center of section, this location with measurements and also wells, dry holes, or other locations in the vicinity of this location.

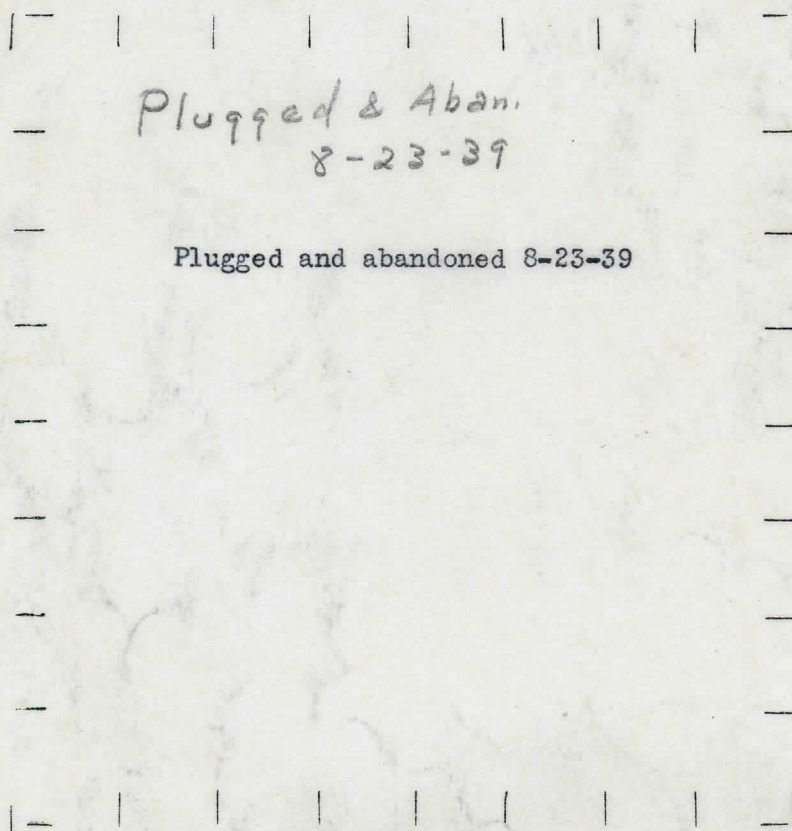

REMARKS:

SIGNED

Superintendent or Foreman.

LOCATION REPORT

No. 133

DATE February 21, 1935

STATE Michigan COUNTY Ogemaw DIST. West Branch. SEC. 20 TOWN 22N RANGE 2E
WELL No. 2 (SERIAL No. 133) FARM Floyd Fisk ACRES

NAME OF STREAM OR WATERS QUADRANGLE NW-SE-SE, NW-SE-SE

OPERATOR Morris-VanKeuren Oil & Gas Syndicate Map West Branch Township, Ogemaw County
Morris-VanKeuren O & G Synd. West Branch - Oge Co.

330 330 Feet from North Line of Farm

" " East " " "

" " South " " "

330 330 " " West " " "

Feet from North Line of Section

990 990 " " East " " "

990 990 " " South " " "

" " West " " "

LEGEND

○ LOCATION

⊙ RIG

⊕ DRILLING

☀ GAS WELL

● OIL WELL

⬮ SMALL OIL WELL

⊖ DRY HOLE

⬮ DRY SHOWING OIL

⬮ DRY SHOWING GAS

⊖ ABANDONED LOCATION

☀ ABANDONED GAS WELL

⬮ ABANDONED OIL WELL

NOTE: Below make tracing from map, (when no map is obtainable make sketch) showing farm, center of section, this location with measurements and also wells, dry holes, or other locations in the vicinity of this location.

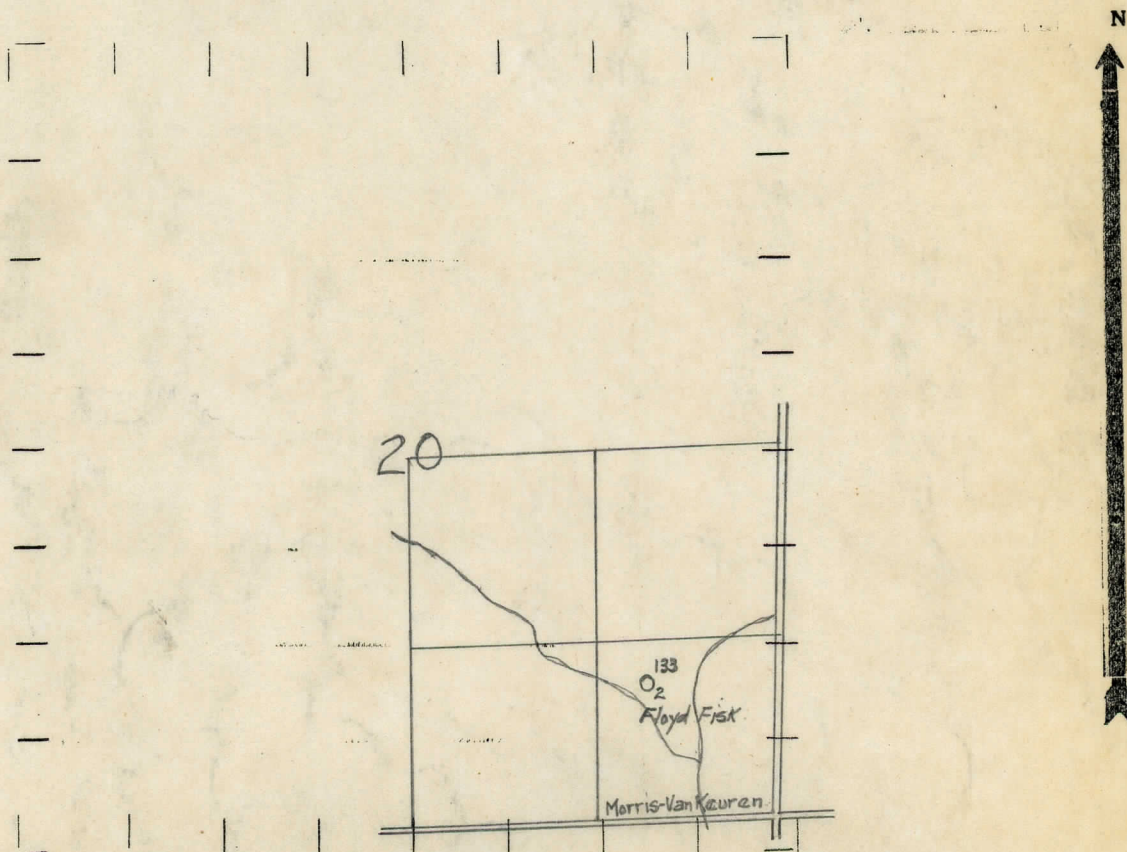

REMARKS:

SIGNED

Superintendent or Foreman.

Michigan Producing Division

PRODUCTION RECORD

FORMATION AND CASING RECORD

[illegible]

Signed J. H. Reed