



Western Michigan University
ScholarWorks at WMU

Legacy Scout Tickets from Pure Oil Company

8-20-2021

MGRRE_PureOilScoutTickets_Fisk, A._2_21129025430000

MGRRE

Western Michigan University

Follow this and additional works at: <https://scholarworks.wmich.edu/pure>



Part of the Geology Commons

WMU ScholarWorks Citation

MGRRE, "MGRRE_PureOilScoutTickets_Fisk, A._2_21129025430000" (2021). *Legacy Scout Tickets from Pure Oil Company*. 7845.

<https://scholarworks.wmich.edu/pure/7845>

This Document is brought to you for free and open access via ScholarWorks at WMU. It has been accepted for inclusion in Legacy Scout Tickets from Pure Oil Company by an authorized administrator of ScholarWorks at WMU. See the National Digital Catalogue - Science Base Catalogue for more collections submitted by MGRRE.



MGRRE_PureOilScoutTickets_Fisk, A._2_21129025430000

API 21129025430000

Permit Number 2543

Lease Name Fisk, A.

Well Number 2

County Ogemaw

Township 22N

Range 02E

Section 29

2021 DEQ or Pure co_name Muskegon Development Company

Pure Number 150

Latitude 44.2762999

Longitude -84.209707

WELL REPORT - OUTSIDE OPERATIONS

SERIAL NO. 150 - 169STATE Michigan ~~MSH~~ CO. OgemawOPERATOR Muskegon Development Co.FARM Arthur Fisk WELL NO. 2 & 3TWP. West Branch S. 29 T. 22N R. 2E
~~SURVEY~~

LOC. _____

WILDCAT ☐ FIELD ☐ FIELD NAME _____

MAP NO. _____ CO-ORD. _____ ELEV. _____

STATUS _____

Operator's name changed from
Muskegon Oil Corp.

NORTH

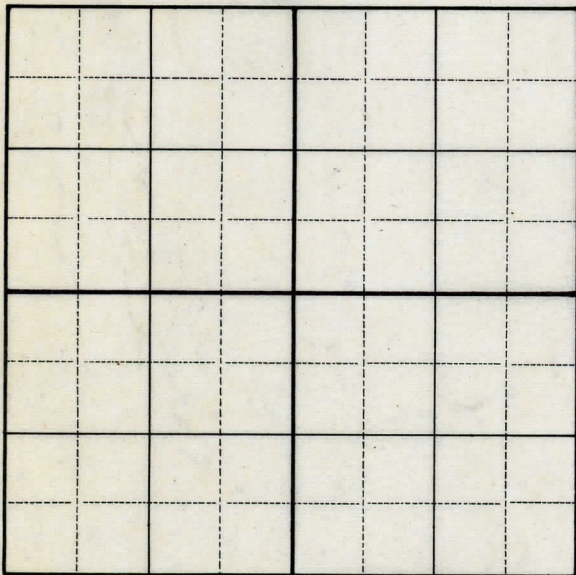
DATE 12-18-51 SCOUT DRS

DATE June 6, 1935

LOCATION REPORT

No. 150

STATE Michigan COUNTY Ogemaw

DIST. West Branch
TWP. West Branch
PREC. Arthur Fisk

SEC. 29 TOWN 22N RANGE 2E

WELL No. 2 (SERIAL No. 150) FARM

80 ACRES

NAME OF STREAM OR WATERS

QUADRANGLE NW-NE-NE
NW NE NE

OPERATOR Muskegon Oil Corporation

Map West Branch Township, Ogemaw County

330 330 Feet from North Line of Farm

" " East " " "

" " South " " "

330 330 " " West " " "

330 330 Feet from North Line of Section

990 990 " " East " " "

" " South " " "

" " West " " "

LEGEND

○ LOCATION

① RIG

⊕ DRILLING

☀ GAS WELL

● OIL WELL

⬮ SMALL OIL WELL

⊙ DRY HOLE

⬮ DRY SHOWING OIL

⊙ DRY SHOWING GAS

⊙ ABANDONED LOCATION

☀ ABANDONED GAS WELL

⬮ ABANDONED OIL WELL

NOTE: Below make tracing from map, (when no map is obtainable make sketch) showing farm, center of section, this location with measurements and also wells, dry holes, or other locations in the vicinity of this location.

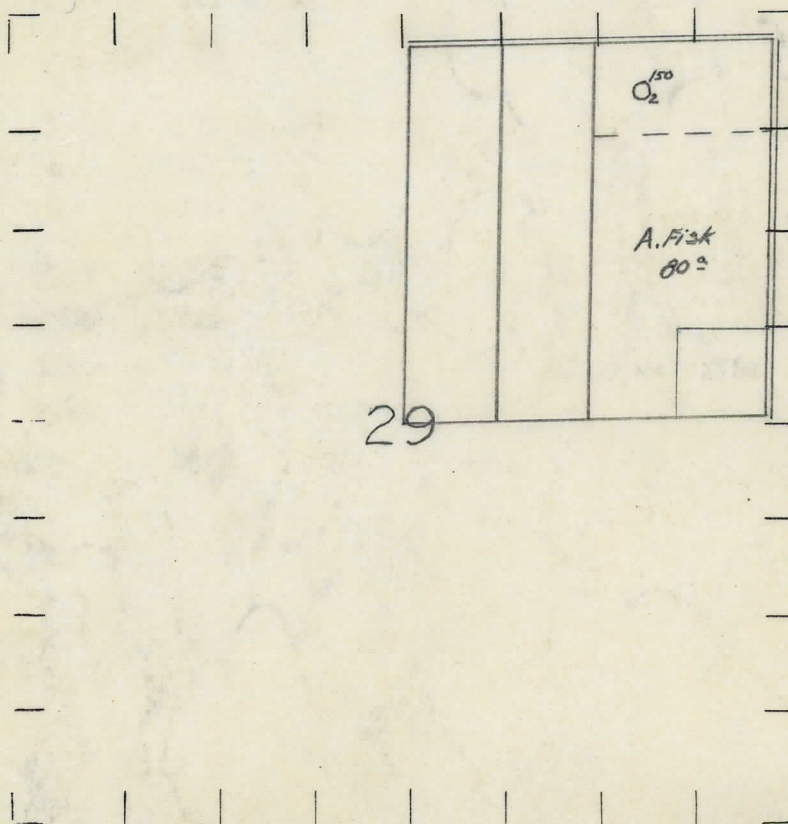

REMARKS:

SIGNED

R. L. Yerga
Superintendent or Foreman.

Signed E. H. Bell