



Western Michigan University
ScholarWorks at WMU

Legacy Scout Tickets from Pure Oil Company

8-20-2021

MGRRE_PureOilScoutTickets_Fisk A_3_21129027430000

MGRRE

Western Michigan University

Follow this and additional works at: <https://scholarworks.wmich.edu/pure>



Part of the Geology Commons

WMU ScholarWorks Citation

MGRRE, "MGRRE_PureOilScoutTickets_Fisk A_3_21129027430000" (2021). *Legacy Scout Tickets from Pure Oil Company*. 7864.

<https://scholarworks.wmich.edu/pure/7864>

This Document is brought to you for free and open access via ScholarWorks at WMU. It has been accepted for inclusion in Legacy Scout Tickets from Pure Oil Company by an authorized administrator of ScholarWorks at WMU. See the National Digital Catalogue - Science Base Catalogue for more collections submitted by MGRRE.



MGRRE_PureOilScoutTickets_Fisk A_3_21129027430000

API 21129027430000

Permit Number 2743

Lease Name Fisk A

Well Number 3

County Ogemaw

Township 22N

Range 02E

Section 29

2021 DEQ or Pure co_name Muskegon Development Company

Pure Number 169

Latitude 44.2724952

Longitude -84.2070386

The Pure Oil Company
THE PURE OIL COMPANYDATE 9-12-35

LOCATION REPORT

No. 169

STATE Michigan COUNTY Ogemaw DIST. West Branch SEC. 29 TOWN 22-N RANGE 2-E
 WELL No. 3 (SERIAL No. 169) FARM A. Fisk A. Fisk ACRES

NAME OF STREAM OR WATERS _____ QUADRANGLE NE-SE-NE
NE - SE - NE

OPERATOR Muskegon Oil Corp. Dev. Co. Map West Branch Twp. Ogemaw County
Muskegon Oil Corp. 12-18-51 West Branch - Oge Co
 Feet from North Line of Farm

330 330 " " East " " "

350 350 " " South " " "

" " West " " "

Feet from North Line of Section

330 330 " " East " $\frac{1}{4}$ "1010 1010 " " South " $\frac{1}{4}$ "

" " West " " "

LEGEND

○ LOCATION

⊕ RIG

⊕ DRILLING

☀ GAS WELL

● OIL WELL

● SMALL OIL WELL

⊕ DRY HOLE

⊕ DRY SHOWING OIL

⊕ DRY SHOWING GAS

⊕ ABANDONED LOCATION

☀ ABANDONED GAS WELL

● ABANDONED OIL WELL

NOTE: Below make tracing from map, (when no map is obtainable make sketch) showing farm, center of section, this location with measurements and also wells, dry holes, or other locations in the vicinity of this location.

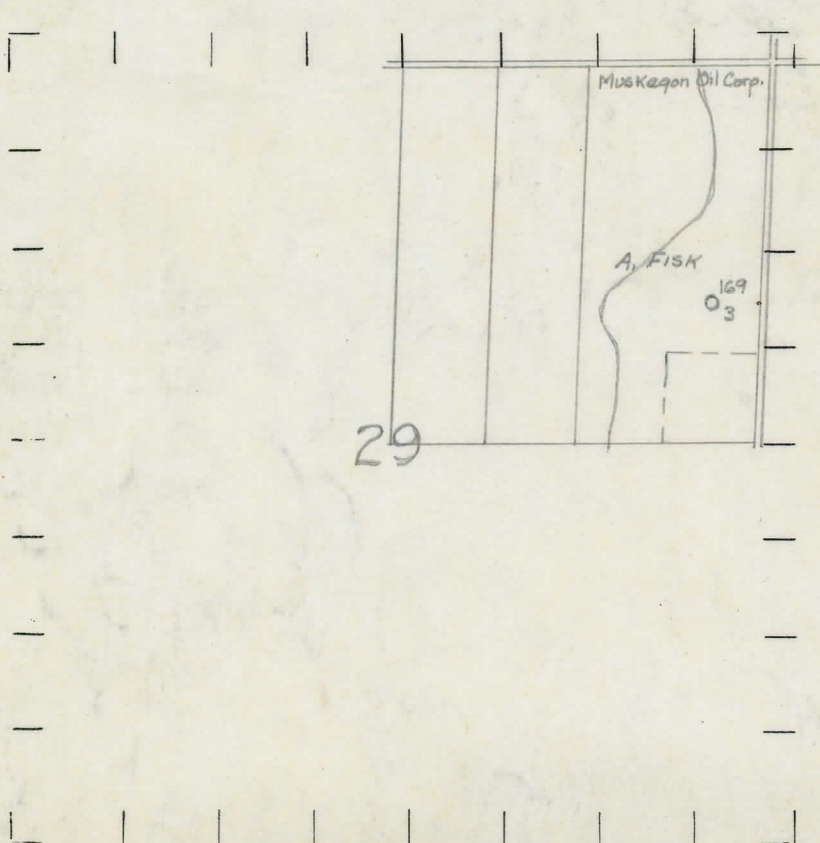

REMARKS:

SIGNED

R. L. Yeager
 Superintendent or Foreman.

Michigan Producing Division

PRODUCTION RECORD

FORMATION AND CASING RECORD

[illegible]

Signed S. N. Bell
2