



Western Michigan University  
ScholarWorks at WMU

---

Legacy Scout Tickets from Pure Oil Company

---

8-20-2021

**MGRRE\_PureOilScoutTickets\_Crow, Evan\_2\_21129030000000**

MGRRE

*Western Michigan University*

Follow this and additional works at: <https://scholarworks.wmich.edu/pure>



Part of the Geology Commons

---

#### WMU ScholarWorks Citation

MGRRE, "MGRRE\_PureOilScoutTickets\_Crow, Evan\_2\_21129030000000" (2021). *Legacy Scout Tickets from Pure Oil Company*. 7891.

<https://scholarworks.wmich.edu/pure/7891>

This Document is brought to you for free and open access via ScholarWorks at WMU. It has been accepted for inclusion in Legacy Scout Tickets from Pure Oil Company by an authorized administrator of ScholarWorks at WMU. See the National Digital Catalogue - Science Base Catalogue for more collections submitted by MGRRE.



---

MGRRE\_PureOilScoutTickets\_Crow, Evan\_2\_21129030000000

API 21129030000000

Permit Number 3000

Lease Name Crow, Evan

Well Number 2

County Ogemaw

Township 22N

Range 02E

Section 36

2021 DEQ or Pure co\_name New Consolidated Petroleum Corporation

Pure Number 196

Latitude 44.2527

Longitude -84.1369

## WELL REPORT - OUTSIDE OPERATIONS

SERIAL NO. 196STATE Michigan ~~PSH~~ CO. OgemawOPERATOR New Consolidated Petroleum Corp.FARM E. Crow WELL NO. 2TWP. West Branch S. 36 T. 22N R. 2ELOC. SE NE SWWILDCAT ☐ FIELD ☐ FIELD NAME \_\_\_\_\_

MAP NO. \_\_\_\_\_ CO-ORD. \_\_\_\_\_ ELEV. \_\_\_\_\_

STATUS Plugged and Abandoned 6-13-48.Total Depth 2606'.

NORTH

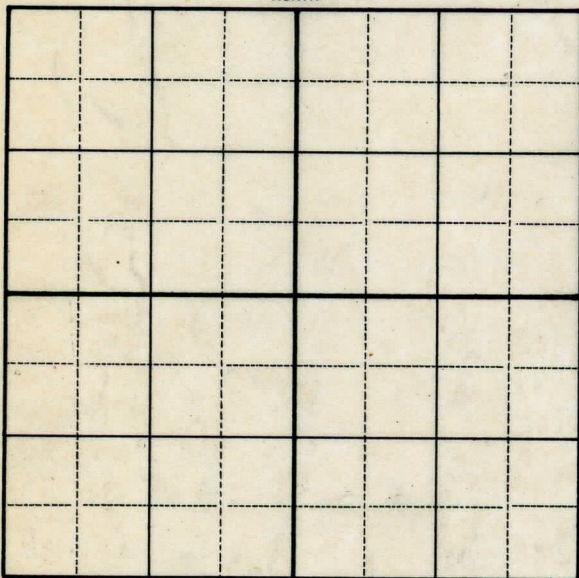
DATE 9-23-48 SCOUT H. J. G.



Feet from North Line of Farm  
330 330 " " East " " "  
330 330 " " South " " "  
" " West " " "  
990 990 Feet from North Line of Section  
330 330 " " East " 1/4 "  
" " South " " "  
" " West " " "

*Spdy. 12-30-35*

- LEGEND
- |                  |                      |
|------------------|----------------------|
| ○ LOCATION       | ⊙ DRY HOLE           |
| ⊕ RIG            | ◆ DRY SHOWING OIL    |
| ⊕ DRILLING       | ⊙ DRY SHOWING GAS    |
| ⊙ GAS WELL       | ⊙ ABANDONED LOCATION |
| ● OIL WELL       | ⊙ ABANDONED GAS WELL |
| ◆ SMALL OIL WELL | ● ABANDONED OIL WELL |

NOTE: Below make tracing from map, (when no map is obtainable make sketch) showing farm, center of section, this location with measurements and also wells, dry holes, or other locations in the vicinity of this location.

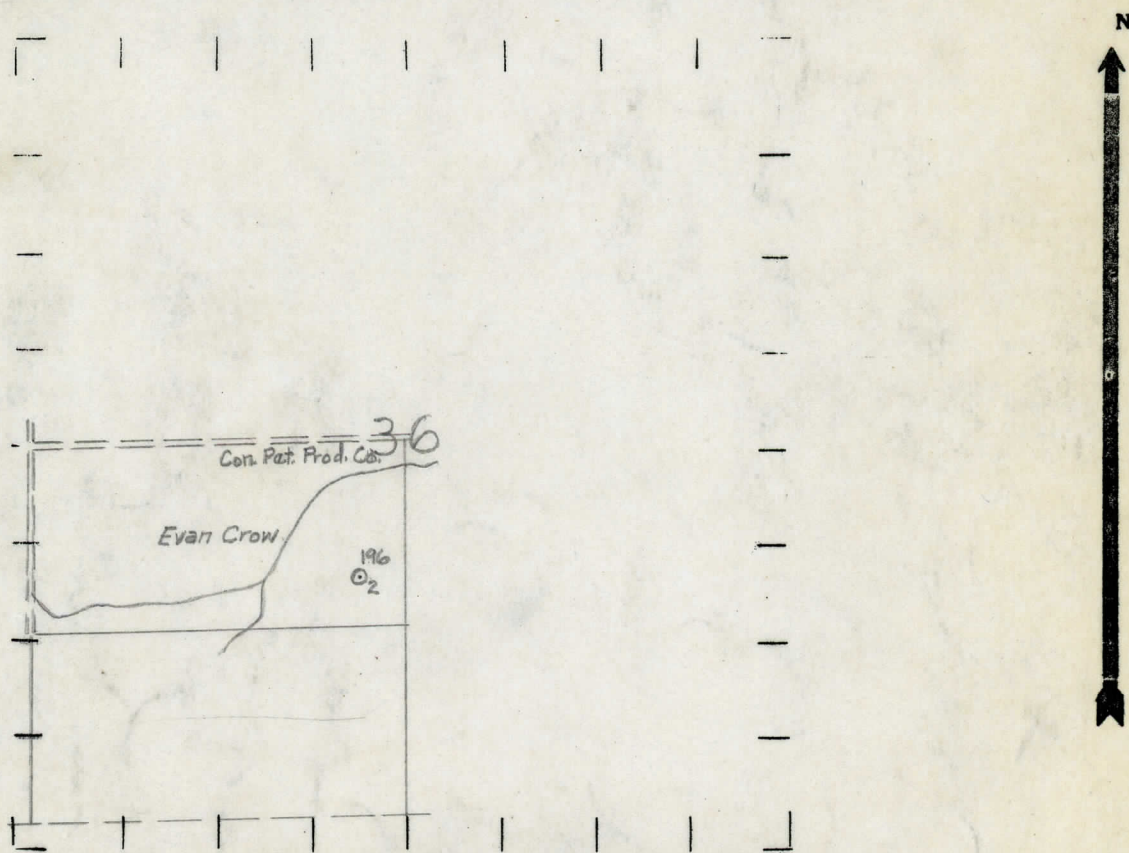

REMARKS:

SIGNED  
Superintendent or Foreman.



# PRODUCTION RECORD

2nd 24 hours after acid

# FORMATION AND CASING RECORD

Remarks Show oil, gas, and water 1797 - produced in Traverse about three months before deepening to Dundee.

Signed

24. Bell