



Western Michigan University
ScholarWorks at WMU

Legacy Scout Tickets from Pure Oil Company

8-20-2021

MGRRE_PureOilScoutTickets_Barber, Cora_2_21129032040000

MGRRE

Western Michigan University

Follow this and additional works at: <https://scholarworks.wmich.edu/pure>



Part of the Geology Commons

WMU ScholarWorks Citation

MGRRE, "MGRRE_PureOilScoutTickets_Barber, Cora_2_21129032040000" (2021). *Legacy Scout Tickets from Pure Oil Company*. 7911.

<https://scholarworks.wmich.edu/pure/7911>

This Document is brought to you for free and open access via ScholarWorks at WMU. It has been accepted for inclusion in Legacy Scout Tickets from Pure Oil Company by an authorized administrator of ScholarWorks at WMU. See the National Digital Catalogue - Science Base Catalogue for more collections submitted by MGRRE.



MGRRE_PureOilScoutTickets_Barber, Cora_2_21129032040000

API 21129032040000

Permit Number 3204

Lease Name Barber, Cora

Well Number 2

County Ogemaw

Township 22N

Range 02E

Section 28

2021 DEQ or Pure co_name Muskegon Development Company

Pure Number 216

Latitude 44.2704963

Longitude -84.2019676

COMPLETION RECORD OF WELLS DRILLED BY OTHER OPERATORS

DATE April 23, 1936

LOCATION REPORT

No. 216STATE Michigan COUNTY Ogemaw DIST. West Branch SEC. 28 TOWN 22 N RANGE 25 EWELL No. 22 (SERIAL No. 216) FARM Cora Barber ACRESNAME OF STREAM OR WATERS QUADRANGLE SE-SW-NWOPERATOR Muskegon Development Company Map West Branch Township, Ogemaw County

Feet from North Line of Farm

" " East " " "

330 330 " " South " " "990 990 " " West " " "

Feet from North Line of Section

" " East " " "

330 330 " " South " 1 1/4 "990 990 " " West " " "

O LOCATION

① RIG

⊕ DRILLING

☼ GAS WELL

● OIL WELL

◆ SMALL OIL WELL

⊙ DRY HOLE

◆ DRY SHOWING OIL

⊙ DRY SHOWING GAS

⊙ ABANDONED LOCATION

☼ ABANDONED GAS WELL

● ABANDONED OIL WELL

NOTE: Below make tracing from map, (when no map is obtainable make sketch) showing farm, center of section, this location with measurements and also wells, dry holes, or other locations in the vicinity of this location.

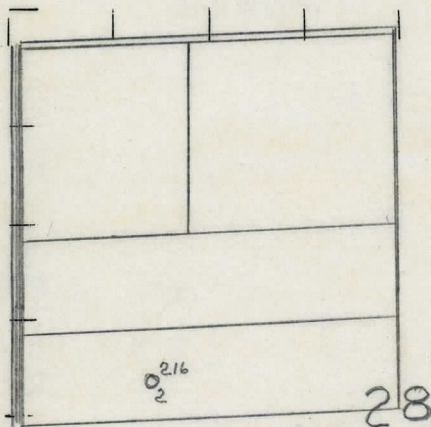

REMARKS:

SIGNED

P. L. Yeager
Superintendent or Foreman.

