



Western Michigan University
ScholarWorks at WMU

Legacy Scout Tickets from Pure Oil Company

8-20-2021

MGRRE_PureOilScoutTickets_Fisk, Mary_2_21129035090000

MGRRE

Western Michigan University

Follow this and additional works at: <https://scholarworks.wmich.edu/pure>



Part of the Geology Commons

WMU ScholarWorks Citation

MGRRE, "MGRRE_PureOilScoutTickets_Fisk, Mary_2_21129035090000" (2021). *Legacy Scout Tickets from Pure Oil Company*. 7945.

<https://scholarworks.wmich.edu/pure/7945>

This Document is brought to you for free and open access via ScholarWorks at WMU. It has been accepted for inclusion in Legacy Scout Tickets from Pure Oil Company by an authorized administrator of ScholarWorks at WMU. See the National Digital Catalogue - Science Base Catalogue for more collections submitted by MGRRE.



MGRRE_PureOilScoutTickets_Fisk, Mary_2_21129035090000

API 21129035090000

Permit Number 3509

Lease Name Fisk, Mary

Well Number 2

County Ogemaw

Township 22N

Range 02E

Section 27

2021 DEQ or Pure co_name Sappington, Henry

Pure Number 250

Latitude 44.26492

Longitude -84.18374

THE PURE OIL COMPANY

DATE December 3, 1936*Corrected*
Corrected
Ogemaw

LOCATION REPORT

No. 250STATE MichiganCOUNTY OgemawDIST. W. BranchTWP. West BranchSEC. 27TOWN 22 NRANGE 2 EWELL No. 2 2 (SERIAL No. 250) FARM*Fisk Bros.*
Fisk Brothers

ACRES

NAME OF STREAM OR WATERS

QUADRANGLE NW-SW-SW
NW SW SWOPERATOR Wm. Kerr and AssociatesMap West Branch Township, Ogemaw County*Wm Kerr & Associates**W. Branch - Oge.*330 330 Feet from North Line of Farm

" " East " " "

" " South " " "

330 330 " " West " " "

Feet from North Line of Section

" " East " " "

990 990 " " South " " "330 330 " " West " " "

LEGEND

○ LOCATION

① RIG

⊕ DRILLING

☼ GAS WELL

● OIL WELL

◆ SMALL OIL WELL

⊙ DRY HOLE

⊙ DRY SHOWING OIL

⊙ DRY SHOWING GAS

⊙ ABANDONED LOCATION

⊙ ABANDONED GAS WELL

⊙ ABANDONED OIL WELL

NOTE: Below make tracing from map, (when no map is obtainable make sketch) showing farm, center of section, this location with measurements and also wells, dry holes, or other locations in the vicinity of this location.

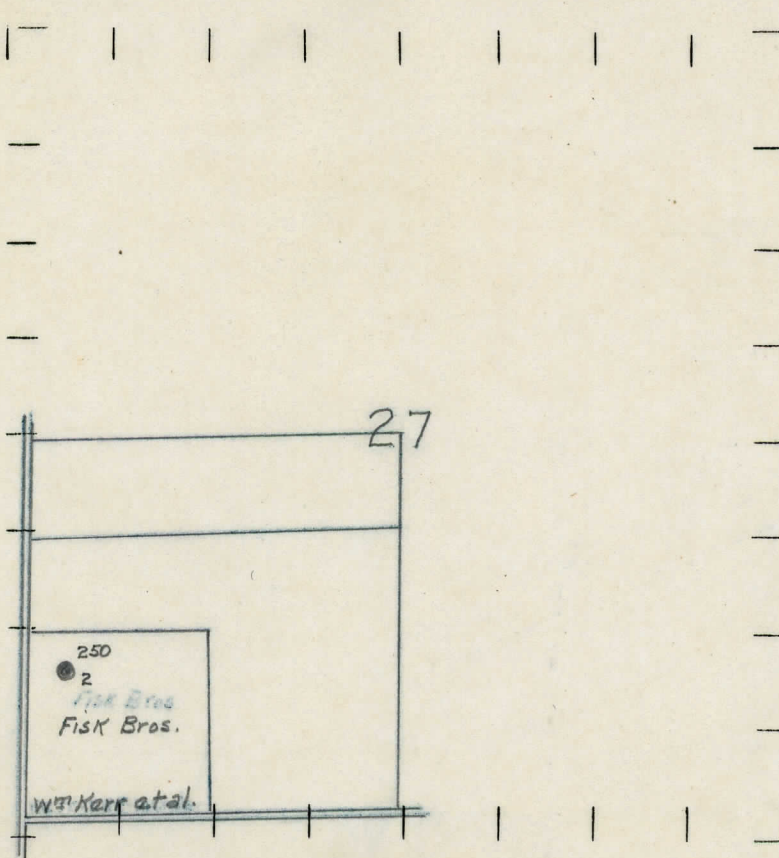
REMARKS: Change in Operator

SIGNED

Superintendent or Foreman.

DATE December 2, 1936

Collected

LOCATION KEBOEL

DATE August 27, 1936

LOCATION REPORT

No. 250

STATE Michigan

COUNTY

Ogemaw

DIST.

West Branch

TWP.

West Branch

SEC.

27

TOWN

22 N

RANGE

2 E

WELL No. 22

(SERIAL No. 250)

FARM

Fisk Bros

ACRES

NAME OF STREAM OR WATERS

QUADRANGLE

NW-SW-SW

OPERATOR Wm. Kerr, J. Stanley See, Homer Nichols

Map

West Branch Township, Ogemaw County

33830

Feet from North Line of Farm

" " East " " "

" " South " " "

33830

" " West " " "

Feet from North Line of Section

" " East " " "

99990

" " South " " "

33830

" " West " " "

LEGEND

○ LOCATION

⊙ DRY HOLE

⊕ RIG

⊙ DRY SHOWING OIL

⊕ DRILLING

⊙ DRY SHOWING GAS

⊙ GAS WELL

⊙ ABANDONED LOCATION

● OIL WELL

⊙ ABANDONED GAS WELL

⊙ SMALL OIL WELL

⊙ ABANDONED OIL WELL

NOTE: Below make tracing from map, (when no map is obtainable make sketch) showing farm, center of section, this location with measurements and also wells, dry holes, or other locations in the vicinity of this location.

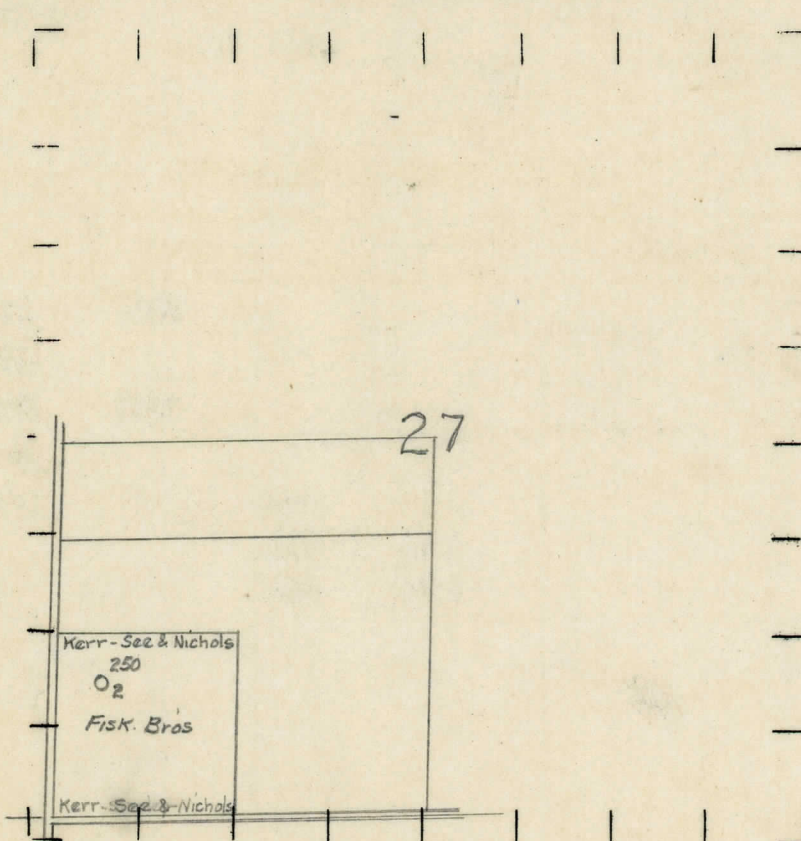

REMARKS:

SIGNED

R. L. Yeager

Superintendent or Foreman.

Signed