



Western Michigan University
ScholarWorks at WMU

Legacy Scout Tickets from Pure Oil Company

8-20-2021

MGRRE_PureOilScoutTickets_Fisk_2_21129044830000

MGRRE

Western Michigan University

Follow this and additional works at: <https://scholarworks.wmich.edu/pure>



Part of the Geology Commons

WMU ScholarWorks Citation

MGRRE, "MGRRE_PureOilScoutTickets_Fisk_2_21129044830000" (2021). *Legacy Scout Tickets from Pure Oil Company*. 8022.

<https://scholarworks.wmich.edu/pure/8022>

This Document is brought to you for free and open access via ScholarWorks at WMU. It has been accepted for inclusion in Legacy Scout Tickets from Pure Oil Company by an authorized administrator of ScholarWorks at WMU. See the National Digital Catalogue - Science Base Catalogue for more collections submitted by MGRRE.



MGRRE_PureOilScoutTickets_Fisk_2_21129044830000

API 21129044830000

Permit Number 4483

Lease Name Fisk

Well Number 2

County Ogemaw

Township 22N

Range 02E

Section 28

2021 DEQ or Pure co_name Sappington, Henry

Pure Number 328

Latitude 44.27405

Longitude -84.18596

COMPLETION RECORD OF WELLS DRILLED BY OTHER OPERATORS

DATE September 16, 1937

LOCATION REPORT

No. 328STATE Michigan

COUNTY

Ogemaw

DIST.

West Branch

TWP.

West Branch

SEC.

28

TOWN

22 N

RANGE

2EWELL No. 22(SERIAL No. 328)

FARM

Fisk

ACRES

NAME OF STREAM OR WATERS

QUADRANGLE

SE-NE-NEOPERATOR Stamy & Wade

Map

West Branch Township, Ogemaw CountyStamy & Wade

Feet from North Line of Farm

330330

" " East " " "

330330

" " South " " "

" " West " " "

990990

Feet from North Line of Section

330330

" " East " " "

" " South " " "

" " West " " "

LEGEND

○ LOCATION

① RIG

⊕ DRILLING

☀ GAS WELL

● OIL WELL

● SMALL OIL WELL

⊙ DRY HOLE

⊙ DRY SHOWING OIL

⊙ DRY SHOWING GAS

⊙ ABANDONED LOCATION

⊙ ABANDONED GAS WELL

⊙ ABANDONED OIL WELL

NOTE: Below make tracing from map, (when no map is obtainable make sketch) showing farm, center of section, this location with measurements and also wells, dry holes, or other locations in the vicinity of this location.

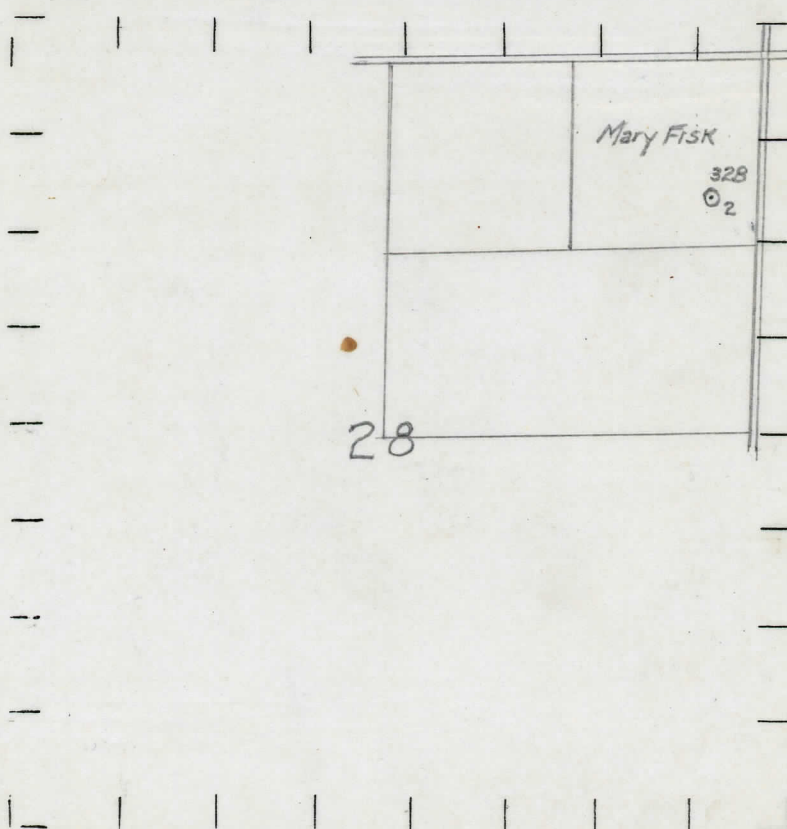

REMARKS:

SIGNED

B. L. Ysager

Superintendent or Foreman

Signed D. C. Shackelford