



Western Michigan University
ScholarWorks at WMU

Legacy Scout Tickets from Pure Oil Company

8-20-2021

MGRRE_PureOilScoutTickets_BuckIngham,
Fred_2_21129050820000

MGRRE
Western Michigan University

Follow this and additional works at: <https://scholarworks.wmich.edu/pure>



Part of the Geology Commons

WMU ScholarWorks Citation

MGRRE, "MGRRE_PureOilScoutTickets_BuckIngham, Fred_2_21129050820000" (2021). *Legacy Scout Tickets from Pure Oil Company*. 8058.
<https://scholarworks.wmich.edu/pure/8058>

This Document is brought to you for free and open access via ScholarWorks at WMU. It has been accepted for inclusion in Legacy Scout Tickets from Pure Oil Company by an authorized administrator of ScholarWorks at WMU. See the National Digital Catalogue - Science Base Catalogue for more collections submitted by MGRRE.



MGRRE_PureOilScoutTickets_BuckIngham, Fred_2_21129050820000

API 21129050820000

Permit Number 5082

Lease Name BuckIngham, Fred

Well Number 2

County Ogemaw

Township 22N

Range 02E

Section 35

2021 DEQ or Pure co_name Marathon Oil Company

Pure Number 366

Latitude 44.25255

Longitude -84.16202

The Pure Oil Company
THE PURE OIL COMPANYDATE June 9, 1938

LOCATION REPORT

No. 366STATE Michigan COUNTY Ogemaw DIST. W-Branch TWP. West Branch SEC. 35 TOWN 22 N RANGE 2 EWELL No. 2 (SERIAL No. 366) FARM Fred Buckingham ACRESNAME OF STREAM OR WATERS QUADRANGLE SE NW SWOPERATOR Weber Oil Company Map West Branch Township, Ogemaw CountyWeber Oil Co.

Feet from North Line of Farm

330 330

" " East " " "

330 330

" " South " " "

" " West " " "

990 990

Feet from North Line of Section

" " East " " "

" " South " " "

990 990

" " West " " "

LEGEND

O LOCATION

① RIG

⊕ DRILLING

☼ GAS WELL

● OIL WELL

● SMALL OIL WELL

⊙ DRY HOLE

⊙ DRY SHOWING OIL

⊙ DRY SHOWING GAS

⊙ ABANDONED LOCATION

⊙ ABANDONED GAS WELL

⊙ ABANDONED OIL WELL

NOTE: Below make tracing from map, (when no map is obtainable make sketch) showing farm, center of section, this location with measurements and also wells, dry holes, or other locations in the vicinity of this location.

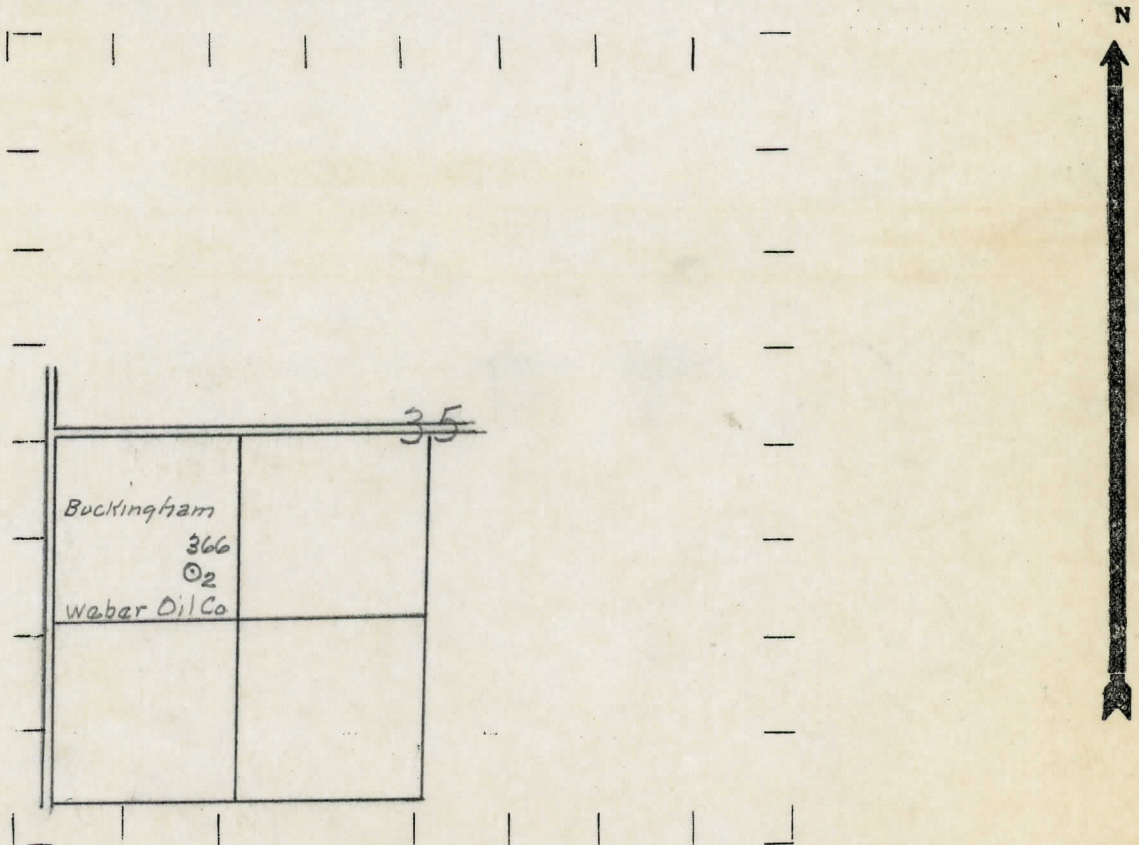

REMARKS:

SIGNED

R. A. J.

Superintendent or Foreman.

Michigan Producing Division

No. 366

~~Dist~~

(Serial No.)

(County No.

By

Not started

Location temporarily abandoned.

2nd 24 hours natural

No. of

No. of gallons

shot

shot

shot

Location temporarily abandoned 12-20-38.

Formation

Top

Bottom

Top
Pay

Bottom
Pay

Remarks

Casing

Size

Set at

Remarks

Signed D. C. Shackelford

