



Western Michigan University
ScholarWorks at WMU

Legacy Scout Tickets from Pure Oil Company

8-20-2021

**MGRRE_PureOilScoutTickets_Crawford, W S & E
H_6_21129050850000**

MGRRE
Western Michigan University

Follow this and additional works at: <https://scholarworks.wmich.edu/pure>



Part of the Geology Commons

WMU ScholarWorks Citation

MGRRE, "MGRRE_PureOilScoutTickets_Crawford, W S & E H_6_21129050850000" (2021). *Legacy Scout Tickets from Pure Oil Company*. 8061.
<https://scholarworks.wmich.edu/pure/8061>

This Document is brought to you for free and open access via ScholarWorks at WMU. It has been accepted for inclusion in Legacy Scout Tickets from Pure Oil Company by an authorized administrator of ScholarWorks at WMU. See the National Digital Catalogue - Science Base Catalogue for more collections submitted by MGRRE.



MGRRE_PureOilScoutTickets_Crawford, W S & E H_6_21129050850000

API 21129050850000

Permit Number 5085

Lease Name Crawford, W S & E H

Well Number 6

County Ogemaw

Township 22N

Range 02E

Section 28

2021 DEQ or Pure co_name Marathon Oil Company

Pure Number 369

Latitude 44.27227

Longitude -84.18602

The Pure Oil Company
THE PURE OIL COMPANY

DATE June 9, 1938

LOCATION REPORT

No. 369

STATE Michigan COUNTY Ogemaw TWP. West Branch SEC. 28 TOWN 22 N RANGE 2 E

WELL No. 6 (SERIAL No. 369) FARM W. S. & E. H. Crawford ACRES

NAME OF STREAM OR WATERS QUADRANGLE NE SE NE

OPERATOR Weber Oil Company Map West Branch Township, Ogemaw County

330 330 Feet from North Line of Farm

330 330 " " East " " "

" " South " " "

" " West " " "

Feet from North Line of Section

330 330 " " East " " "

990 990 " " South " 1 1/4 "

" " West " " "

Low

LEGEND

○ LOCATION

① RIG

⊕ DRILLING

☼ GAS WELL

● OIL WELL

⦿ SMALL OIL WELL

⊙ DRY HOLE

⦿ DRY SHOWING OIL

⦿ DRY SHOWING GAS

⦿ ABANDONED LOCATION

☼ ABANDONED GAS WELL

⦿ ABANDONED OIL WELL

NOTE: Below make tracing from map, (when no map is obtainable make sketch) showing farm, center of section, this location with measurements and also wells, dry holes, or other locations in the vicinity of this location.

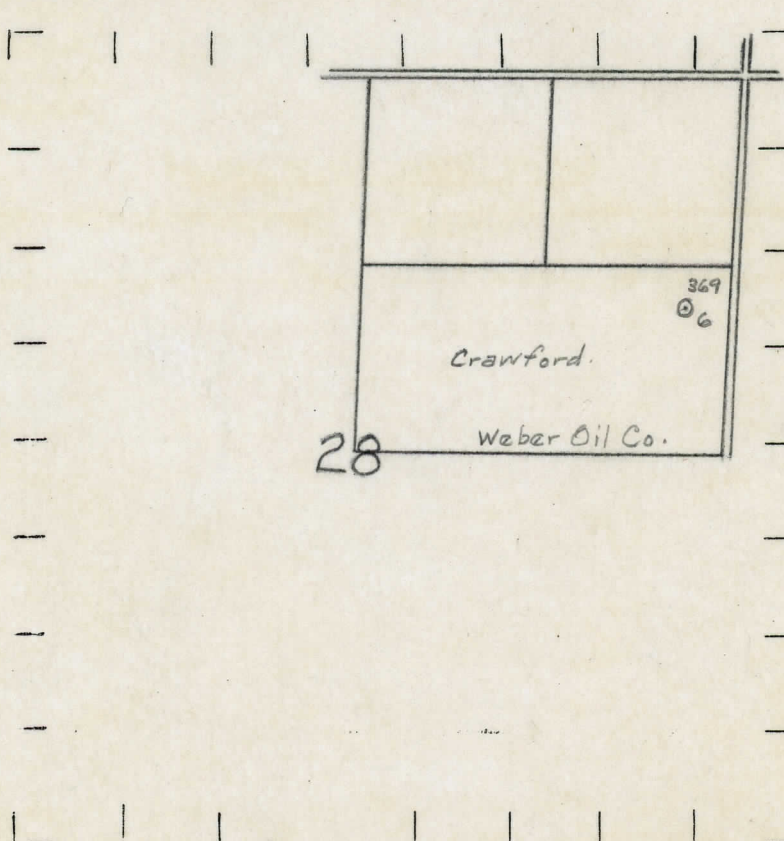

REMARKS:

SIGNED

R. A. J.

Superintendent or Foreman.

Michigan Producing Division

No. 369

(Serial No.)

Operator Weber Oil Company Information secured ^{By} ~~from~~ Scouting Department

Date well started **9-28-38** Date well completed **11-10-38** Elevation **937.3**

1st 24 hours natural 10 Barrels (Swabbed)

Date of shot..... No. of
quarts..... From..... to..... From..... to.....

Date of acid **11-19-38** No. of gallons **1500**

1st 24 hours after acid shot 50 Barrels

2nd 24 hours after acid

[illegible]

Remarks

Signed D. C. Shackelford