



Western Michigan University
ScholarWorks at WMU

Legacy Scout Tickets from Pure Oil Company

8-20-2021

**MGRRE_PureOilScoutTickets_Crawford, W S & E
H_7_21129050860000**

MGRRE
Western Michigan University

Follow this and additional works at: <https://scholarworks.wmich.edu/pure>



Part of the Geology Commons

WMU ScholarWorks Citation

MGRRE, "MGRRE_PureOilScoutTickets_Crawford, W S & E H_7_21129050860000" (2021). *Legacy Scout Tickets from Pure Oil Company*. 8062.
<https://scholarworks.wmich.edu/pure/8062>

This Document is brought to you for free and open access via ScholarWorks at WMU. It has been accepted for inclusion in Legacy Scout Tickets from Pure Oil Company by an authorized administrator of ScholarWorks at WMU. See the National Digital Catalogue - Science Base Catalogue for more collections submitted by MGRRE.



MGRRE_PureOilScoutTickets_Crawford, W S & E H_7_21129050860000

API 21129050860000

Permit Number 5086

Lease Name Crawford, W S & E H

Well Number 7

County Ogemaw

Township 22N

Range 02E

Section 28

2021 DEQ or Pure co_name Muskegon Development Company

Pure Number 370

Latitude 44.2667385

Longitude -84.1862173

The Pure Oil Company
THE PURE OIL COMPANYDATE June 9, 1938

LOCATION REPORT

No. 370STATE Michigan COUNTY Ogemaw DIST. W-Branch TWP. West Branch SEC. 28 TOWN 22 N RANGE 2 E
WELL No. 7 (SERIAL No. 370) FARM W. S. & E. H. Crawford ACRESNAME OF STREAM OR WATERS _____ QUADRANGLE SE-NE-SEOPERATOR Weber Oil Company Map West Branch Township, Ogemaw County

Feet from North Line of Farm

330 330 " " East " " "1680 1680 " " South " " "

" " West " " "

Feet from North Line 1/4 Section990 990 " " East " " "330 330 " " South " " "

" " West " " "

LEGEND

O LOCATION

① RIG

⊕ DRILLING

☀ GAS WELL

● OIL WELL

⬮ SMALL OIL WELL

⊖ DRY HOLE

⬮ DRY SHOWING OIL

⬮ DRY SHOWING GAS

⊖ ABANDONED LOCATION

☀ ABANDONED GAS WELL

⬮ ABANDONED OIL WELL

NOTE: Below make tracing from map, (when no map is obtainable make sketch) showing farm, center of section, this location with measurements and also wells, dry holes, or other locations in the vicinity of this location.

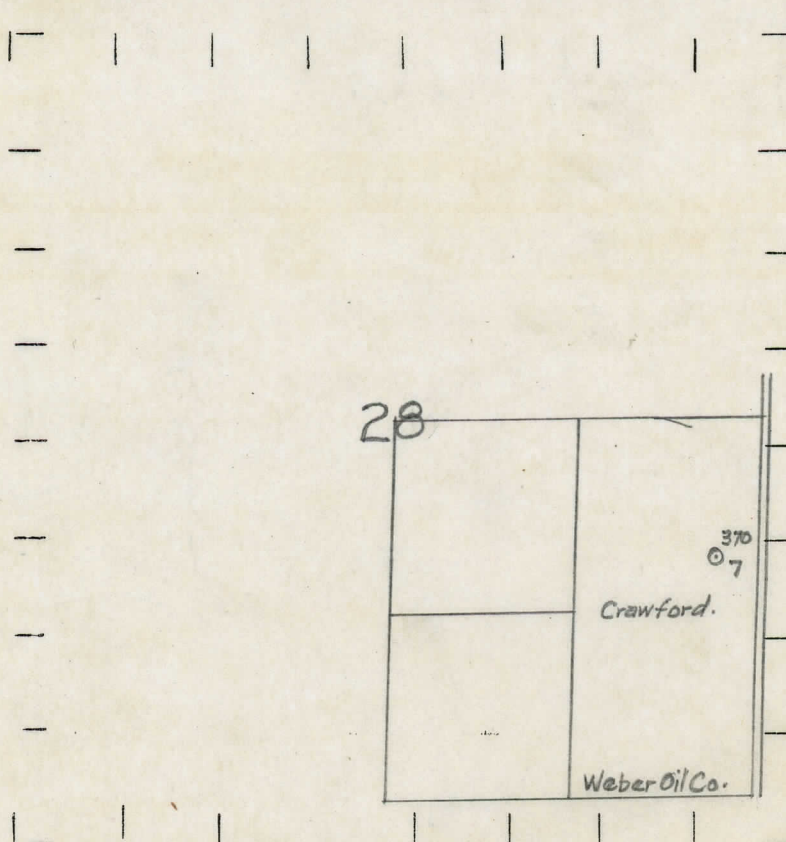

REMARKS:

SIGNED

Superintendent or Foreman.

STOUT AND COMPANY, DISTRICT

No. **370**

Dist.

(Serial No.)

By

8-12-39

PRODUCTION RECORD

Filled up 300 ft.

2nd 24 hours natural

No. of

No. of gallons **2000**

short:

shot

FORMATION AND CASING RECORD

[illegible]

Remarks This was an old well drilled deeper - formerly completed as an oil well at a total depth of 1761' - pumping 100 bbls. oil and 30 bbls. salt water 1st. 24 hrs. natural. Additional information to our former Completion Report.

Signed D. C. Shackelford