



Western Michigan University  
ScholarWorks at WMU

---

Legacy Scout Tickets from Pure Oil Company

---

8-20-2021

**MGRRE\_PureOilScoutTickets\_Crow, Chris G.\_1\_21129051610000**

MGRRE

*Western Michigan University*

Follow this and additional works at: <https://scholarworks.wmich.edu/pure>



Part of the Geology Commons

---

#### **WMU ScholarWorks Citation**

MGRRE, "MGRRE\_PureOilScoutTickets\_Crow, Chris G.\_1\_21129051610000" (2021). *Legacy Scout Tickets from Pure Oil Company*. 8065.

<https://scholarworks.wmich.edu/pure/8065>

This Document is brought to you for free and open access via ScholarWorks at WMU. It has been accepted for inclusion in Legacy Scout Tickets from Pure Oil Company by an authorized administrator of ScholarWorks at WMU. See the National Digital Catalogue - Science Base Catalogue for more collections submitted by MGRRE.



---

**MGRRE\_PureOilScoutTickets\_Crow, Chris G.\_1\_21129051610000**

API 21129051610000

Permit Number 5161

Lease Name Crow, Chris G.

Well Number 1

County Ogemaw

Township 21N

Range 01E

Section 4

2021 DEQ or Pure co\_name Atha, Robert W.

Pure Number 375

Latitude 44.23471

Longitude -84.32338

The Pure Oil Company  
THE PURE OIL COMPANY

## COMPLETION RECORD OF WELLS DRILLED BY OTHER OPERATORS

DATE July 21, 1938

## LOCATION REPORT

No. 375

STATE Michigan COUNTY Ogemaw ~~DIST~~ Edwards TWP. Edwards SEC. 4 TOWN 21 N RANGE 1 E  
 WELL No. 1 (SERIAL No. 375) FARM Chris G. Crow ACRES 1 E

NAME OF STREAM OR WATERS \_\_\_\_\_ QUADRANGLE SE SW SWOPERATOR Robert W. Atha Map Edwards Township, Ogemaw County\_\_\_\_\_ Robt. W. Atha \_\_\_\_\_ Edwards - Ogemaw

\_\_\_\_\_ Feet from North Line of Farm

\_\_\_\_\_ " " East " " "

417 417 " " South " " "845 845 " " West " " "

\_\_\_\_\_ Feet from North Line of Section

\_\_\_\_\_ " " East " " "

417 417 " " South " " "845 845 " " West " " "4 1/4 980  
Sp 6-28-3810" 3588 1/4 9507 Mar 780RR 897-930

## LEGEND

○ LOCATION

① RIG

⊕ DRILLING

☼ GAS WELL

● OIL WELL

● SMALL OIL WELL

⊙ DRY HOLE

⊙ DRY SHOWING OIL

⊙ DRY SHOWING GAS

⊙ ABANDONED LOCATION

⊙ ABANDONED GAS WELL

⊙ ABANDONED OIL WELL

NOTE: Below make tracing from map, (when no map is obtainable make sketch) showing farm, center of section, this location with measurements and also wells, dry holes, or other locations in the vicinity of this location.

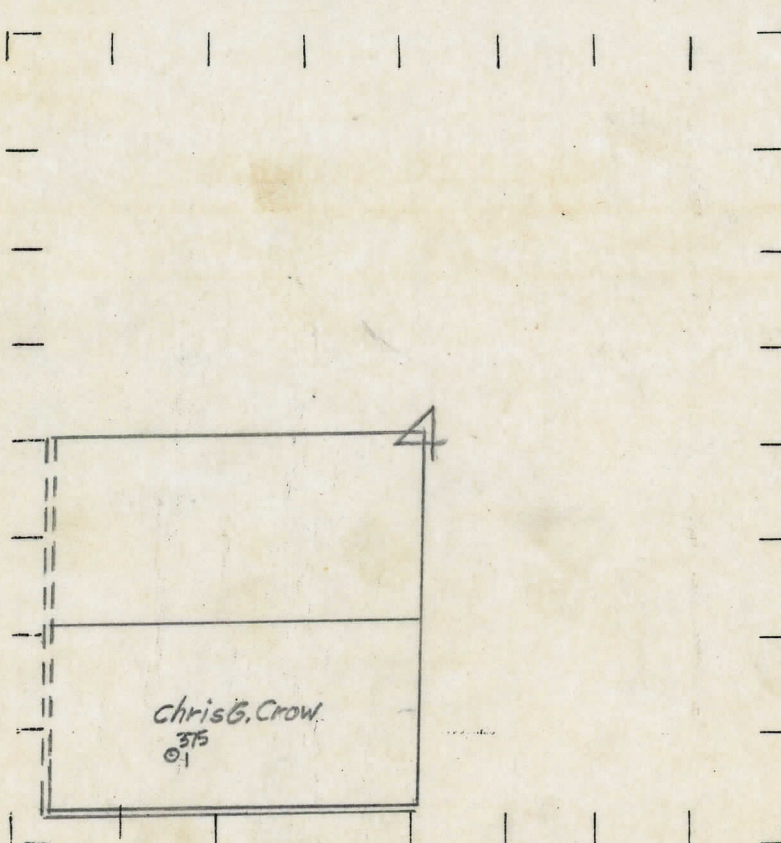

REMARKS:

SIGNED

R. L. G.

Superintendent or Foreman.



D. C. Shackelford