



Western Michigan University
ScholarWorks at WMU

Legacy Scout Tickets from Pure Oil Company

8-20-2021

MGRRE_PureOilScoutTickets_Everett_1_21129057700000

MGRRE

Western Michigan University

Follow this and additional works at: <https://scholarworks.wmich.edu/pure>



Part of the Geology Commons

WMU ScholarWorks Citation

MGRRE, "MGRRE_PureOilScoutTickets_Everett_1_21129057700000" (2021). *Legacy Scout Tickets from Pure Oil Company*. 8072.

<https://scholarworks.wmich.edu/pure/8072>

This Document is brought to you for free and open access via ScholarWorks at WMU. It has been accepted for inclusion in Legacy Scout Tickets from Pure Oil Company by an authorized administrator of ScholarWorks at WMU. See the National Digital Catalogue - Science Base Catalogue for more collections submitted by MGRRE.



MGRRE_PureOilScoutTickets_Everett_1_21129057700000

API 21129057700000

Permit Number 5770

Lease Name Everett

Well Number 1

County Ogemaw

Township 23N

Range 03E

Section 19

2021 DEQ or Pure co_name Molloy and Gallaher

Pure Number 382

Latitude 44.37709

Longitude -84.11993

THE PURE OIL COMPANY
 COMPLETION RECORD OF WELLS DRILLED BY OTHER OPERATORS
 LOCATION REPORT

DATE January 26, 1939No. 382

STATE Michigan COUNTY Ogemaw DISTX Cumming TWP. Cumming SEC. 19 TOWN 23 N RANGE 3 E
 WELL No. 1 (SERIAL No. 382) FARM Everett ACRES

NAME OF STREAM OR WATERS _____ QUADRANGLE NW-NE-NWOPERATOR Molloy & Gallaher Map Cumming Township, Ogemaw County330330Molloy & Gallaher

Feet from North Line of Farm

" " East " " "

" " South " " "

" " West " " "

330330

Feet from North Line of Section

990990" " East " 1/4 "

" " South " " "

" " West " " "

LEGEND

○ LOCATION

① RIG

⊕ DRILLING

☀ GAS WELL

● OIL WELL

⦿ SMALL OIL WELL

⊖ DRY HOLE

⦿ DRY SHOWING OIL

⊖ DRY SHOWING GAS

⊖ ABANDONED LOCATION

⦿ ABANDONED GAS WELL

⦿ ABANDONED OIL WELL

NOTE: Below make tracing from map, (when no map is obtainable make sketch) showing farm, center of section, this location with measurements and also wells, dry holes, or other locations in the vicinity of this location.

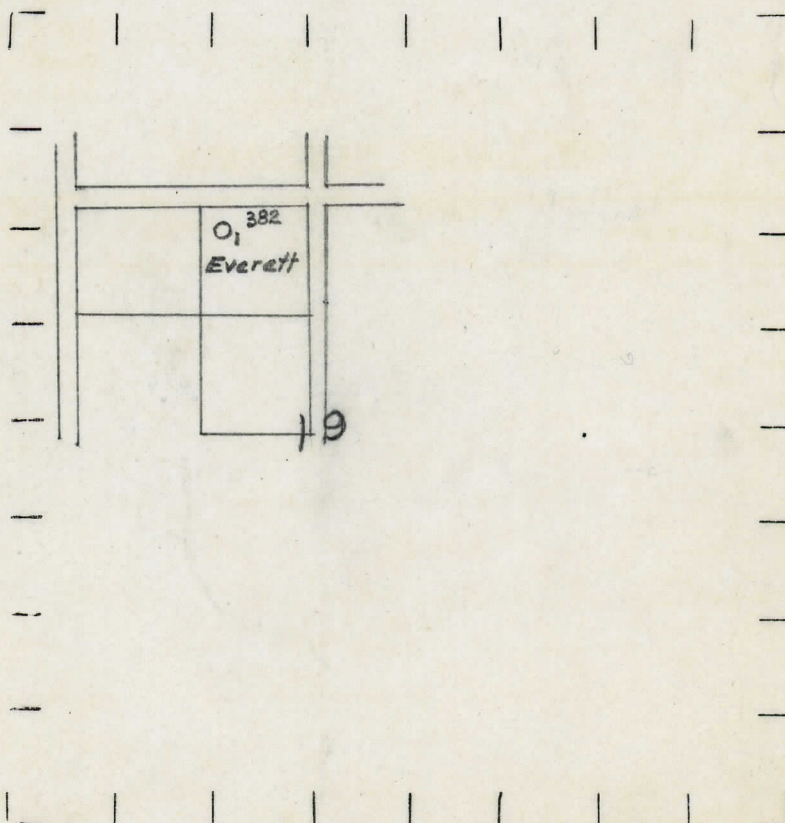

REMARKS:

SIGNED

Superintendent or Foreman.

Signed D. C. Shackelford