



Western Michigan University  
ScholarWorks at WMU

---

Legacy Scout Tickets from Pure Oil Company

---

8-20-2021

**MGRRE\_PureOilScoutTickets\_Crawford, W S & E  
H\_8\_21129061720000**

MGRRE  
*Western Michigan University*

Follow this and additional works at: <https://scholarworks.wmich.edu/pure>



Part of the Geology Commons

---

#### WMU ScholarWorks Citation

MGRRE, "MGRRE\_PureOilScoutTickets\_Crawford, W S & E H\_8\_21129061720000" (2021). *Legacy Scout Tickets from Pure Oil Company*. 8075.  
<https://scholarworks.wmich.edu/pure/8075>

This Document is brought to you for free and open access via ScholarWorks at WMU. It has been accepted for inclusion in Legacy Scout Tickets from Pure Oil Company by an authorized administrator of ScholarWorks at WMU. See the National Digital Catalogue - Science Base Catalogue for more collections submitted by MGRRE.



---

**MGRRE\_PureOilScoutTickets\_Crawford, W S & E H\_8\_21129061720000**

API 21129061720000

Permit Number 6172

Lease Name Crawford, W S & E H

Well Number 8

County Ogemaw

Township 22N

Range 02E

Section 28

2021 DEQ or Pure co\_name Marathon Oil Company

Pure Number 385

Latitude 44.26308

Longitude -84.18632

THE PURE OIL COMPANY  
COMPLETION RECORD OF WELLS DRILLED BY OTHER OPERATORS  
LOCATION REPORT

DATE May 18, 1939

No. 385

STATE Michigan COUNTY Ogemaw DIST. West Branch TWP. West Branch SEC. 28 TOWN 22 N RANGE 2 E

WELL No. 8 (SERIAL No. 385) FARM W. S. Crawford ACRES

NAME OF STREAM OR WATERS QUADRANGLE SE SE SE

OPERATOR Weber Oil Company Map West Branch, Township, Ogemaw County  
Weber Oil Co. West Branch - Oge.

Feet from North Line of Farm

33330 " " East " " "  
33330 " " South " " "  
" " West " " "

Feet from North Line of Section

32330 " " East " " "  
33330 " " South " " "  
" " West " " "

LEGEND

- |                  |                      |
|------------------|----------------------|
| ○ LOCATION       | ⊕ DRY HOLE           |
| ① RIG            | ⊕ DRY SHOWING OIL    |
| ⊕ DRILLING       | ⊕ DRY SHOWING GAS    |
| ⊕ GAS WELL       | ⊕ ABANDONED LOCATION |
| ● OIL WELL       | ⊕ ABANDONED GAS WELL |
| ⊕ SMALL OIL WELL | ⊕ ABANDONED OIL WELL |

NOTE: Below make tracing from map, (when no map is obtainable make sketch) showing farm, center of section, this location with measurements and also wells, dry holes, or other locations in the vicinity of this location.

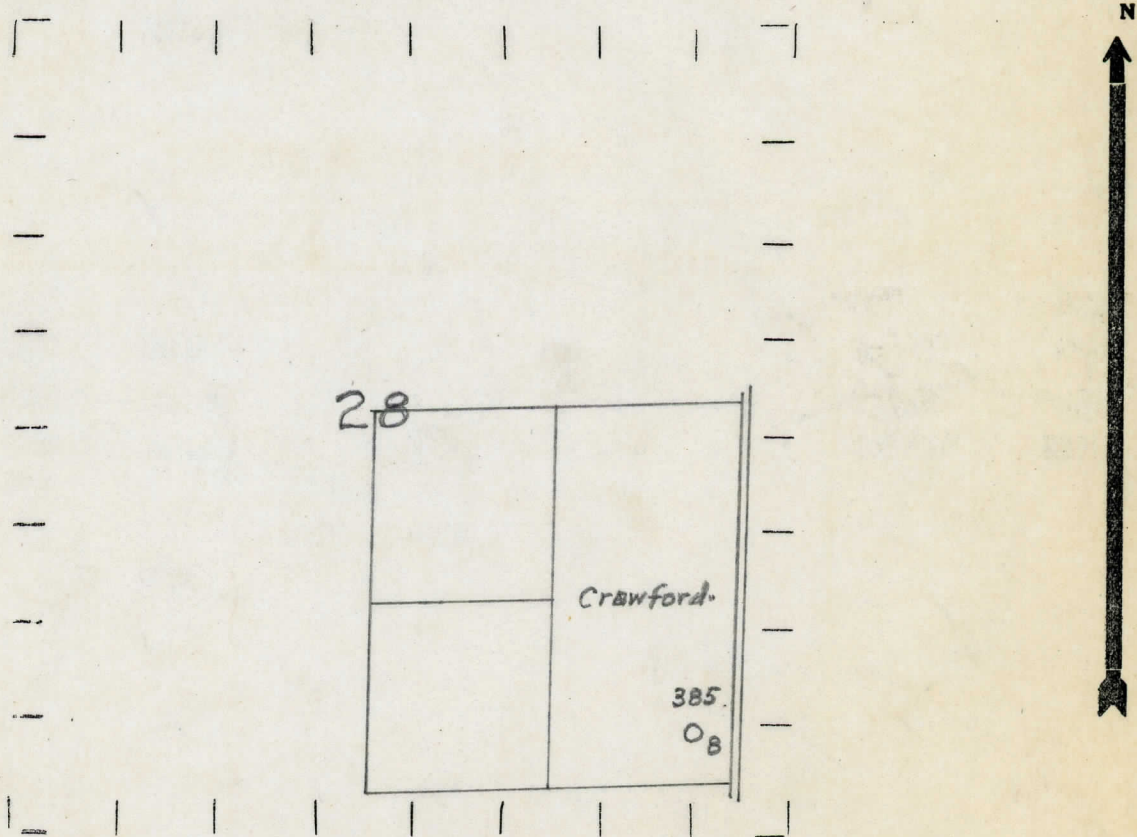

REMARKS:

SIGNED

Superintendent or Foreman.



D. C. Shackelford