



Western Michigan University
ScholarWorks at WMU

Legacy Scout Tickets from Pure Oil Company

8-20-2021

MGRRE_PureOilScoutTickets_Estey, F_4_21129080640000

MGRRE

Western Michigan University

Follow this and additional works at: <https://scholarworks.wmich.edu/pure>



Part of the Geology Commons

WMU ScholarWorks Citation

MGRRE, "MGRRE_PureOilScoutTickets_Estey, F_4_21129080640000" (2021). *Legacy Scout Tickets from Pure Oil Company*. 8084.

<https://scholarworks.wmich.edu/pure/8084>

This Document is brought to you for free and open access via ScholarWorks at WMU. It has been accepted for inclusion in Legacy Scout Tickets from Pure Oil Company by an authorized administrator of ScholarWorks at WMU. See the National Digital Catalogue - Science Base Catalogue for more collections submitted by MGRRE.



MGRRE_PureOilScoutTickets_Estey, F_4_21129080640000

API 21129080640000

Permit Number 8064

Lease Name Estey, F

Well Number 4

County Ogemaw

Township 22N

Range 02E

Section 28

2021 DEQ or Pure co_name Muskegon Development Company

Pure Number 394

Latitude 44.2685864

Longitude -84.1966539

THE PURE OIL COMPANY

DATE October 2, 1940

LOCATION REPORT

No. 394STATE MichiganCOUNTY OgemawDIST. West BranchTWP. West BranchSEC. 28TOWN 22 NRANGE 2 EWELL No. 47 (SERIAL No. 394) FARMPREC. Frank Estey

ACRES

NAME OF STREAM OR WATERS

QUADRANGLE NE NE SWOPERATOR Weber Oil CompanyMap West Branch Township, Ogemaw County330 330 Feet from North Line of Farm330 330 " " East " " "

" " South " " "

" " West " " "

330 330 Feet from North Line of Section 1/4330 330 " " East " " "

" " South " " "

" " West " " "

LEGEND

○ LOCATION

① RIG

⊕ DRILLING

☼ GAS WELL

● OIL WELL

◆ SMALL OIL WELL

⊙ DRY HOLE

◆ DRY SHOWING OIL

⊙ DRY SHOWING GAS

⊙ ABANDONED LOCATION

☼ ABANDONED GAS WELL

◆ ABANDONED OIL WELL

NOTE: Below make tracing from map, (when no map is obtainable make sketch) showing farm, center of section, this location with measurements and also wells, dry holes, or other locations in the vicinity of this location.

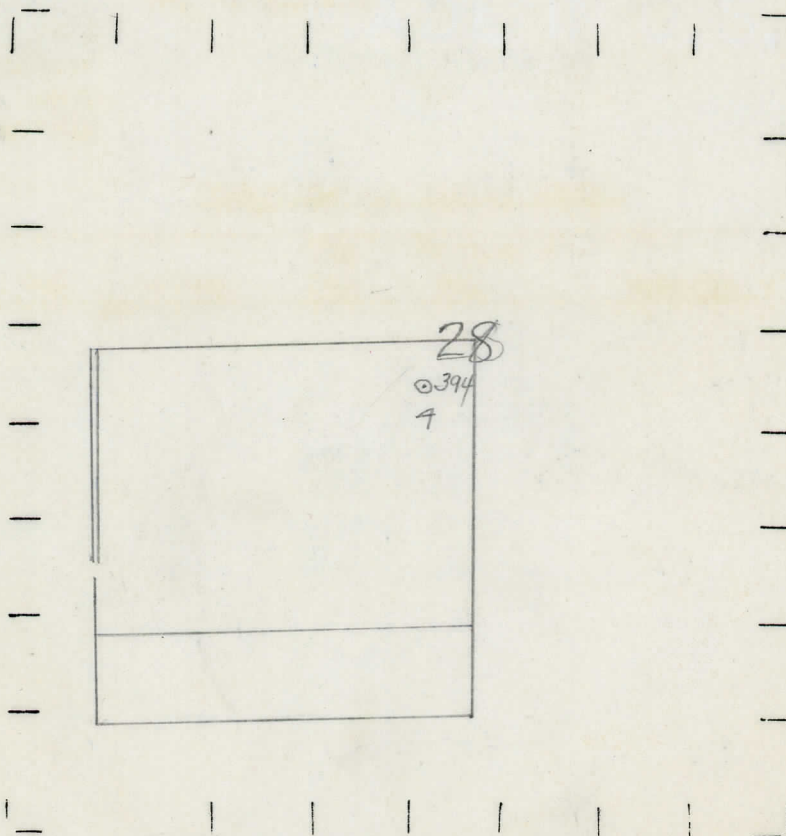

N

REMARKS:

SIGNED

Superintendent or Foreman.

MISPLAN PRODUCTIONS

No. 394

Well No. 4 (County No.) 394 Farm Frank Estey Acres

Operator **Weber Oil Company** By **Scouting Department**
Information secured from

Date well started **10-19-40** Dated well completed **12-10-40** Elevation **938.9**

PRODUCTION RECORD

1st 24 hours natural 9 Barrels (Swabbed)

2nd 24 hours natural

[illegible]

Date of acid 12-13-40 No. of gallons 2000

1st 24 hours after acid 30 Barrels (Swabbed)

2nd 24 hours after acid

FORMATION AND CASING RECORD

Formation	Top	Bottom	Top Pay	Bottom Pay	Remarks	Casing	
						Size	Set at
Sunbury	1185					10"	307
Berea	1212					8-1/4"	688
Antrim	1295					5-3/16"	2532
Traverse Line	1748		1755 1758	1758 1761	Show oil. Show salt water.		
Dundee	2530	S.L.M.	2548	2552			
	940 1593		2655	2666			
Total Depth		2703					

Remarks

Signed **D. C. Shackelford**