



Western Michigan University  
ScholarWorks at WMU

---

Legacy Scout Tickets from Pure Oil Company

---

8-20-2021

## MGRRE\_PureOilScoutTickets\_Burge, A.\_4\_unk

MGRRE

*Western Michigan University*

Follow this and additional works at: <https://scholarworks.wmich.edu/pure>



Part of the Geology Commons

---

### WMU ScholarWorks Citation

MGRRE, "MGRRE\_PureOilScoutTickets\_Burge, A.\_4\_unk" (2021). *Legacy Scout Tickets from Pure Oil Company*. 8126.

<https://scholarworks.wmich.edu/pure/8126>

This Document is brought to you for free and open access via ScholarWorks at WMU. It has been accepted for inclusion in Legacy Scout Tickets from Pure Oil Company by an authorized administrator of ScholarWorks at WMU. See the National Digital Catalogue - Science Base Catalogue for more collections submitted by MGRRE.



---

**MGRRE\_PureOilScoutTickets\_Burge, A.\_4\_unk**

API unk

Permit Number unk

Lease Name Burge, A.

Well Number 4

County Osceola

Township 19N

Range 07W

Section 22

2021 DEQ or Pure co\_name Gibson-Johnson-Borden

Pure Number 4

Latitude 44.0229864

Longitude -85.1377916

THE PURE OIL COMPANY  
THE PURE OIL COMPANY  
LOCATION REPORT

No. **4**

DATE **December 19, 1930.**

STATE **Michigan** COUNTY **Osceola** DIST. **Middle Branch** SEC. **21** TOWN **19 N** RANGE **7 W**

WELL No. **4** (SERIAL No. **4**) FARM **A. Burge** ACRES

NAME OF STREAM OR WATERS QUADRANGLE **NW 1/4 - NE 1/4**

OPERATOR **Gibson-Johnson-Borden** MAP **Middle Branch Twp., Osceola Co.**

**620** Feet from North Line of Farm

**100** " " East " " "

" " South " " "

" " West " " "

**620** Feet from North Line of Section

**1420** " " East " " "

" " South " " "

" " West " " "

LEGEND

- LOCATION
- ⊕ RIG
- ⊕ DRILLING
- ⊙ GAS WELL
- OIL WELL
- ⊕ SMALL OIL WELL
- ⊙ DRY HOLE
- ⊕ DRY SHOWING OIL
- ⊙ DRY SHOWING GAS
- ⊙ ABANDONED LOCATION
- ⊙ ABANDONED GAS WELL
- ⊙ ABANDONED OIL WELL

NOTE: Below make tracing from map, (when no map is obtainable make sketch) showing farm, center of section, this location with measurements and also wells, dry holes, or other locations in the vicinity of this location. Make copy to keep for reference and send original to Columbus office.

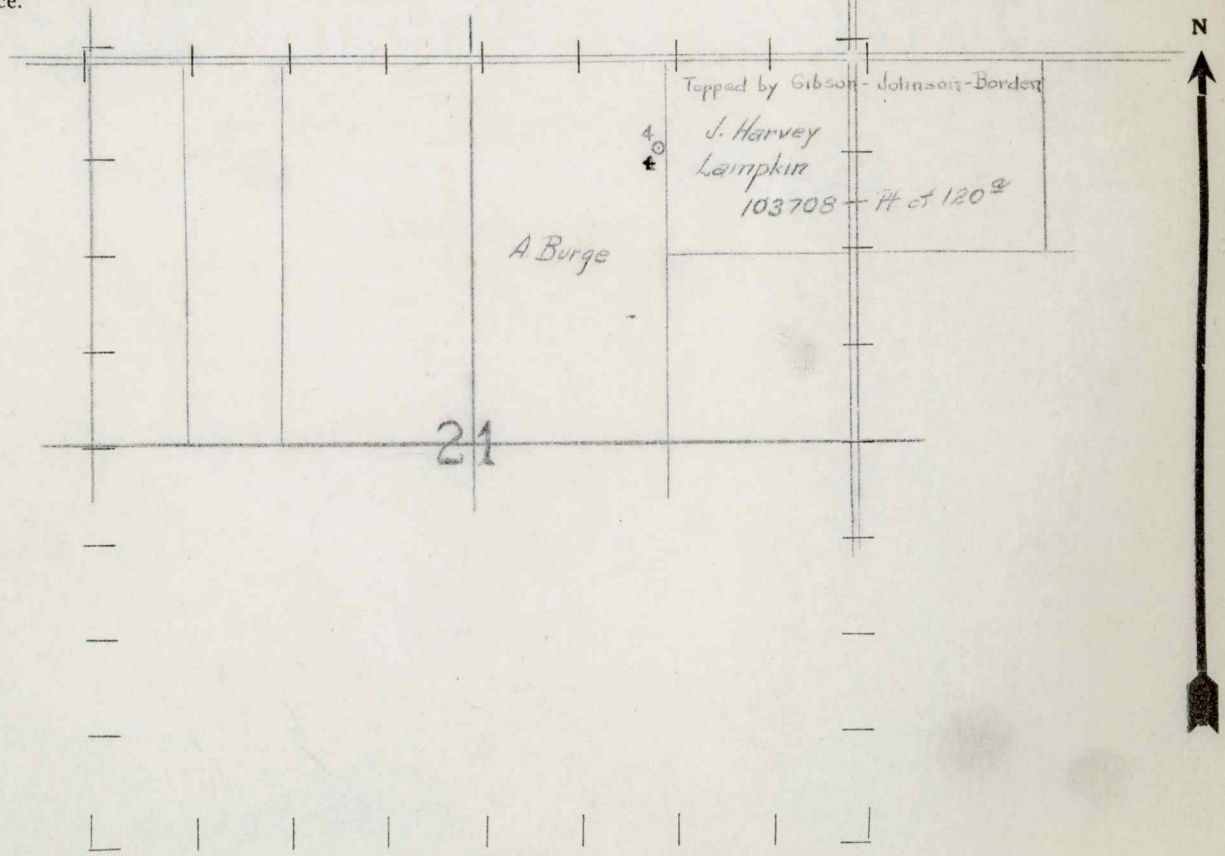

REMARKS: **CORE TEST**

SIGNED

Superintendent or Foreman.

Michigan Producing DIVISION

DATE February 14, 1931. **COMPLETION RECORD** No. - 4 -

STATE Michigan COUNTY Osceola DIST. TWP. Middlebranch SEC. 21 TOWN 19 N RANGE 7 W  
 PREC.

WELL No. 4 (SERIAL No. 4) FARM A. Burge ACRES \_\_\_\_\_

NAME OF STREAM OR WATERS \_\_\_\_\_ QUADRANGLE NW<sup>1</sup> - NE<sup>1</sup>

OPERATOR Gihson-Johnson-Borden MAP Middlebranch Twp., Osceola Co.

LOCATION REPORT SENT IN (DATE) 12-19-30

WELL STARTED (DATE) 12-19-30 WELL COMPLETED (DATE) 2-14-31

OIL WELL
 GAS WELL
 DEWATER
 ABANDONED WELL

CROSS OUT THREE OF THE ABOVE

CORE TEST

WELL RECORD

DATE OF SHOT \_\_\_\_\_ NUMBER OF QUARTS \_\_\_\_\_

1st 24 HOURS PRODUCTION		NUMBER OF QUARTS	BARRELS OR FEET
<u>Dry</u>			
2nd " " "			" " "
3rd " " "			" " "
4th " " "			" " "
5th " " "			" " "

SAND AND CASING

CASING SIZE	WEIGHT	CASING Feet Inches	SAND Name and Nature	TOP	BOTTOM	TOP PAY	BOTTOM PAY	SALT WATER

REMARKS Core test-No inf. available.

\_\_\_\_\_  
 \_\_\_\_\_  
 \_\_\_\_\_  
 \_\_\_\_\_