



Western Michigan University
ScholarWorks at WMU

Legacy Scout Tickets from Pure Oil Company

8-20-2021

**MGRRE_PureOilScoutTickets_Fleming, Wm.
O._1_21133017950000**

MGRRE
Western Michigan University

Follow this and additional works at: <https://scholarworks.wmich.edu/pure>



Part of the Geology Commons

WMU ScholarWorks Citation

MGRRE, "MGRRE_PureOilScoutTickets_Fleming, Wm. O._1_21133017950000" (2021). *Legacy Scout Tickets from Pure Oil Company*. 8130.
<https://scholarworks.wmich.edu/pure/8130>

This Document is brought to you for free and open access via ScholarWorks at WMU. It has been accepted for inclusion in Legacy Scout Tickets from Pure Oil Company by an authorized administrator of ScholarWorks at WMU. See the National Digital Catalogue - Science Base Catalogue for more collections submitted by MGRRE.



MGRRE_PureOilScoutTickets_Fleming, Wm. O._1_21133017950000

API 21133017950000

Permit Number 1795

Lease Name Fleming, Wm. O.

Well Number 1

County Osceola

Township 17N

Range 08W

Section 5

2021 DEQ or Pure co_name Oryx Energy Company

Pure Number 8

Latitude 43.89593

Longitude -85.29714

THE PURE OIL COMPANY

DATE November 9, 1933

LOCATION REPORT

No. 8

STATE Michigan COUNTY Osceola DIST. Ewart TWP. Ewart SEC. 5 TOWN 17 N RANGE 8 W

WELL No. 1 (SERIAL No. 8) FARM Wm. C. Fleming ACRES

NAME OF STREAM OR WATERS QUADRANGLE NE-SE-NW

OPERATOR Sun Oil Company MAP Ewart Township, Osceola County

----- Feet from North Line of Farm
245 " " East " " "
920 " " South " " "
 " " West " " "
1720 Feet from North Line of Section
 " " East " " "
 " " South " " "
2395 " " West " " "

LEGEND

- LOCATION
- ⊙ RIG
- ⊕ DRILLING
- ⊛ GAS WELL
- OIL WELL
- ⊙ SMALL OIL WELL
- ⊛ DRY HOLE
- ⊛ DRY SHOWING OIL
- ⊛ DRY SHOWING GAS
- ⊙ ABANDONED LOCATION
- ⊛ ABANDONED GAS WELL
- ⊙ ABANDONED OIL WELL

NOTE: Below make tracing from map, (when no map is obtainable make sketch) showing farm, center of section, this location with measurements and also wells, dry holes, or other locations in the vicinity of this location. Make copy to keep for reference and send original to Columbus office.

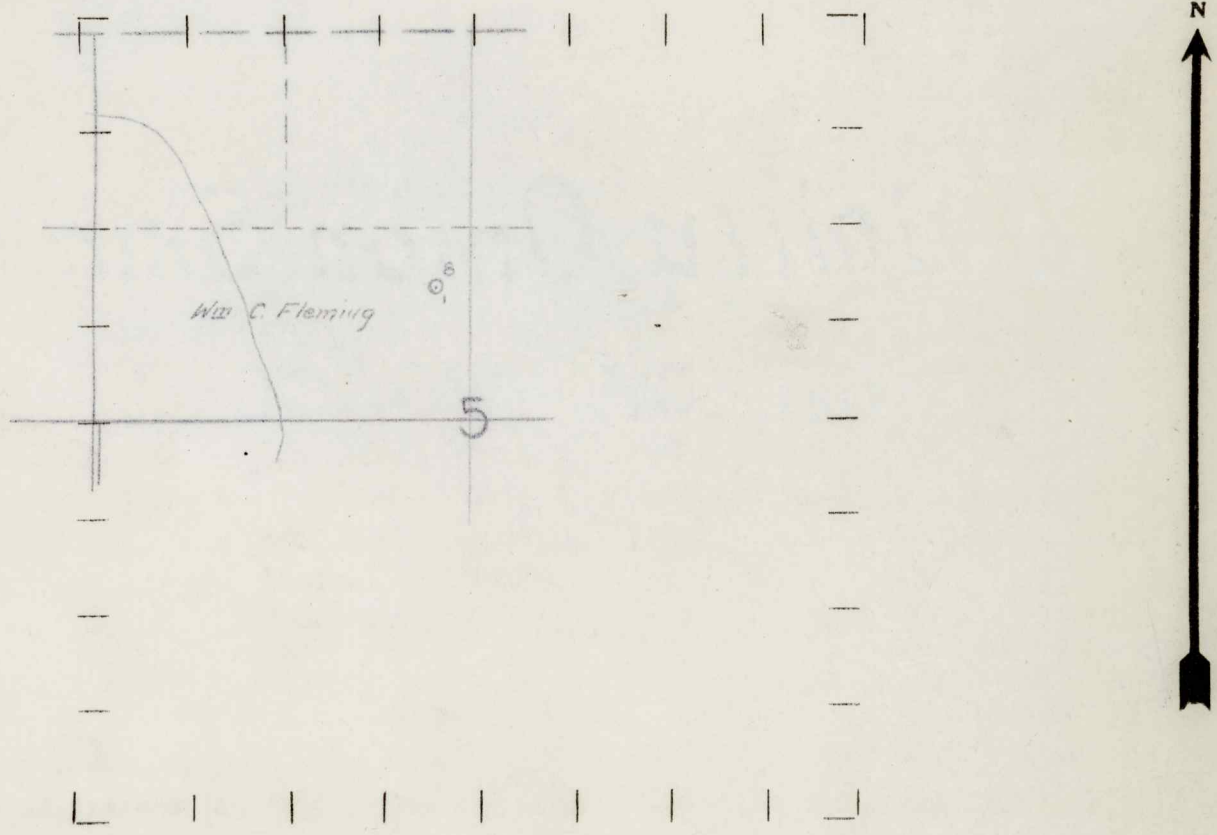

REMARKS:

SIGNED R. L. Yeager
 Superintendent or Foreman.

THE PURE OIL COMPANY
MICHIGAN PRODUCING DIVISION

No. 8

DATE March 16, 1934

COMPLETION RECORD

No. 8

STATE Michigan COUNTY Osceola DIST. TWP. Ewart SEC. 5 TOWN 17 N RANGE 8 W
PREC.

WELL No. 1 (SERIAL No. 8) FARM Wm. C. Fleming ACRES

NAME OF STREAM OR WATERS QUADRANGLE NE-SE-NW

OPERATOR Sun Oil Company MAP Ewart Township, Osceola County

LOCATION REPORT SENT IN (DATE) 11/9/33

WELL STARTED (DATE) 11/24/33 WELL COMPLETED (DATE) 3/10/34

~~XXXXXXXXXX~~ ~~XXXXXXXXXX~~ DRY HOLE ~~XXXXXXXXXXXXXXXXXXXX~~

Elevation 1023.8 CROSS OUT THREE OF THE ABOVE
WELL RECORD

DATE OF SHOT	NUMBER OF QUARTS
1st 24 HOURS PRODUCTION <u>Dry Hole</u>	BARRELS OR FEET
2nd " " "	" " "
3rd " " "	" " "
4th " " "	" " "
5th " " "	" " "

SAND AND CASING

CASING SIZE	WEIGHT	CASING Feet Inches	SAND Name and Nature	TOP	BOTTOM	TOP PAY	BOTTOM PAY	SALT WATER
14"		35	Drift	0	564			
10		599	Marshall	1396	1692	(Upper & Lower)		
8 1/4		1125	Antrim	2850	3115			
6-5/8"		1712	Trav. Form.	3115	3148			
5-3/16"		3275	" Lime	3148	3702	3185 Oil & Salt Water		3276
			Bell Shale	3702	3757			
			Dundee	3757			H.F.	3773
			Total Depth		3773			

REMARKS Oil in Traverse at 3185' - Swabbed total of 75 bbls. in 4 days. Oil exhausted and hole filled with Salt Water.

Complete log attached.