



Western Michigan University
ScholarWorks at WMU

Legacy Scout Tickets from Pure Oil Company

8-20-2021

MGRRE_PureOilScoutTickets_Marble, Clara_1_21133020800000

MGRRE

Western Michigan University

Follow this and additional works at: <https://scholarworks.wmich.edu/pure>



Part of the Geology Commons

WMU ScholarWorks Citation

MGRRE, "MGRRE_PureOilScoutTickets_Marble, Clara_1_21133020800000" (2021). *Legacy Scout Tickets from Pure Oil Company*. 8131.

<https://scholarworks.wmich.edu/pure/8131>

This Document is brought to you for free and open access via ScholarWorks at WMU. It has been accepted for inclusion in Legacy Scout Tickets from Pure Oil Company by an authorized administrator of ScholarWorks at WMU. See the National Digital Catalogue - Science Base Catalogue for more collections submitted by MGRRE.



MGRRE_PureOilScoutTickets_Marble, Clara_1_21133020800000

API 21133020800000

Permit Number 2080

Lease Name Marble, Clara

Well Number 1

County Osceola

Township 17N

Range 08W

Section 8

2021 DEQ or Pure co_name Oryx Energy Company

Pure Number 9

Latitude 43.87387

Longitude -85.29891

THE PURE OIL COMPANY

LOCATION REPORT

No. 9

DATE July 6, 1934

STATE Michigan COUNTY Osceola DIST. Twp. Ewart SEC. 8 TOWN 17N RANGE 8W

WELL No. 1 (SERIAL No. 19) FARM Clara Marble ACRES

NAME OF STREAM OR WATERS QUADRANGLE CN¹-SE-SW

OPERATOR Sun Oil Company MAP Ewart Township, Osceola County

Feet from North Line of Farm

660 " " East " " "

822 " " South " " "

660 " " West " " "

Feet from North Line of Section

" " East " " "

820 " " South " " "

1980 " " West " " "

LEGEND

- LOCATION
- ⊙ RIG
- ⊕ DRILLING
- ⊛ GAS WELL
- OIL WELL
- ⊖ SMALL OIL WELL
- ◇ DRY HOLE
- ◆ DRY SHOWING OIL
- ⊙ DRY SHOWING GAS
- ⊖ ABANDONED LOCATION
- ⊛ ABANDONED GAS WELL
- ⊖ ABANDONED OIL WELL

NOTE: Below make tracing from map, (when no map is obtainable make sketch) showing farm, center of section, this location with measurements and also wells, dry holes, or other locations in the vicinity of this location. Make copy to keep for reference and send original to Columbus office.

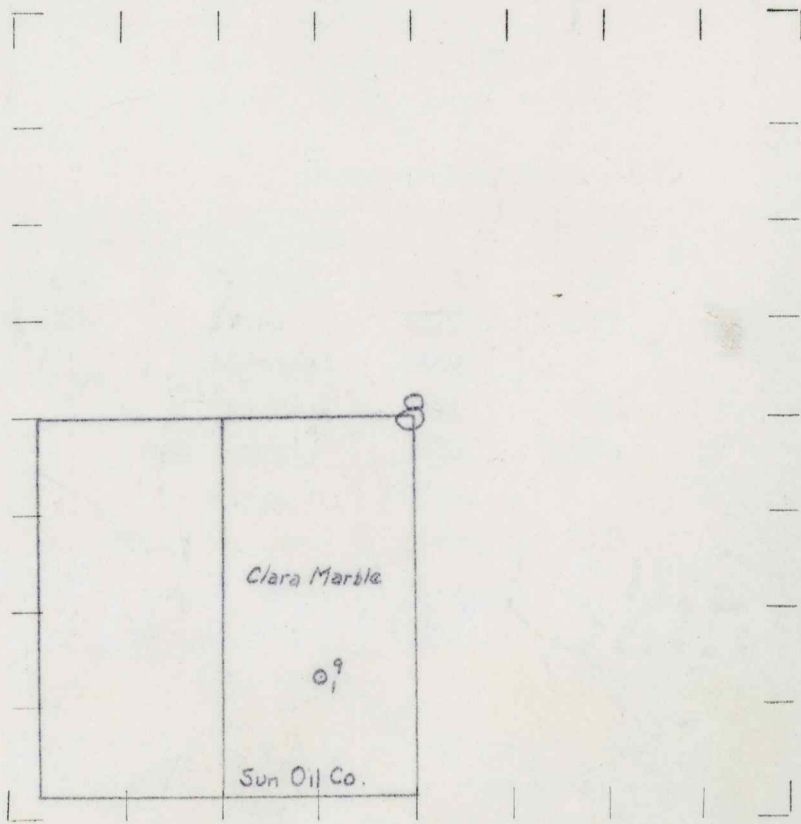

REMARKS:

SIGNED

R. H. Yager

Superintendent or Foreman.

Per. # 2080

COMPLETION RECORD

Michigan Producing DIVISION
 DATE 9/20/34 No. 9
 STATE Michigan COUNTY Osceola DIST. TWP. Ewart SEC. 8 TOWN 17N RANGE 8W
 PREC.
 WELL No. 1 (SERIAL No. 9) FARM Clara Marble ACRES
 NAME OF STREAM OR WATERS QUADRANGLE SE-SW
 OPERATOR Sun Oil Company MAP Ewart Township, Osceola County

LOCATION REPORT SENT IN (DATE) 7/5/34

WELL STARTED (DATE) 7/17/34 WELL COMPLETED (DATE) 9/14/34

OIL WELL GAS WELL DRY HOLE ABANDONED WELL

Elevation 1068.5'

CROSS OUT THREE OF THE ABOVE

WELL RECORD

DATE OF SHOT	NUMBER OF QUARTS	BARRELS OR FEET
1st 24 HOURS PRODUCTION	DRY HOLE	
2nd " " "		" " "
3rd " " "		" " "
4th " " "		" " "
5th " " "		" " "

SAND AND CASING

CASING SIZE	WEIGHT	CASING Feet Inches	SAND Name and Nature	TOP	BOTTOM	TOP PAY	BOTTOM PAY	SALT WATER
8 1/2		1146	Drift	0	-565			
6-5/8		1315	Stray	1375	1392			
5-3/16		3663	Marshall	1447				
			Red Rock	1521	1740			
			Sunbury	2480	2574			
			Berea	2574				
			Traverse Form.	3184	3218			
			" Lime	3218				3264
			Dundee	3808				
			Total Depth		3858			Blk. 3840-3854

REMARKS Scum Oil 3264'

NOTE - MAKE COPY TO KEEP FOR REFERENCE AND SEND ORIGINAL TO CHICAGO OFFICE. LIST MATERIAL CHARGEABLE TO WELL ON OTHER SIDE.

SIGNED J.H. Bell SUPT. OR FOREMAN