



Western Michigan University
ScholarWorks at WMU

Legacy Scout Tickets from Pure Oil Company

8-20-2021

MGRRE_PureOilScoutTickets_Davis and Whiteside_1_21133611367000

MGRRE

Western Michigan University

Follow this and additional works at: <https://scholarworks.wmich.edu/pure>



Part of the Geology Commons

WMU ScholarWorks Citation

MGRRE, "MGRRE_PureOilScoutTickets_Davis and Whiteside_1_21133611367000" (2021). *Legacy Scout Tickets from Pure Oil Company*. 8142.

<https://scholarworks.wmich.edu/pure/8142>

This Document is brought to you for free and open access via ScholarWorks at WMU. It has been accepted for inclusion in Legacy Scout Tickets from Pure Oil Company by an authorized administrator of ScholarWorks at WMU. See the National Digital Catalogue - Science Base Catalogue for more collections submitted by MGRRE.



MGRRE_PureOilScoutTickets_Davis and Whiteside_1_21133611367000

API 21133611367000

Permit Number None

Lease Name Davis and Whiteside

Well Number 1

County Osceola

Township 20N

Range 08W

Section 24

2021 DEQ or Pure co_name Pure Oil Company

Pure Number 20

Latitude 44.1095159

Longitude -85.2162408

THE PURE OIL COMPANY

LOCATION REPORT

No. 20

DATE Jan. 10, 1938

STATE Mich. COUNTY Osceola DIST. Highland SEC. 24 TOWN 20 N. RANGE 8W

WELL No. 1 (SERIAL No. 20) FARM Viola Davis & Carrie M. Whiteside ACRES

NAME OF STREAM OR WATERS _____ QUADRANGLE SW-SW-SE

OPERATOR Pure Oil Co. (Core Test) Map Highland - Osceola Co.

Feet from North Line of Farm
 " " East " " "
 " " South " " "
 " " West " " "

Feet from North Line of Section
 " " East " " "
410 " " South " " "
320 " " West " " $\frac{1}{4}$ "

LEGEND

- LOCATION
- ⊕ RIG
- ⊕ DRILLING
- ☀ GAS WELL
- OIL WELL
- ⊕ SMALL OIL WELL
- ⊕ DRY HOLE
- ⊕ DRY SHOWING OIL
- ⊕ DRY SHOWING GAS
- ⊕ ABANDONED LOCATION
- ☀ ABANDONED GAS WELL
- ⊕ ABANDONED OIL WELL

NOTE: Below make tracing from map, (when no map is obtainable make sketch) showing farm, center of section, this location with measurements and also wells, dry holes, or other locations in the vicinity of this location.

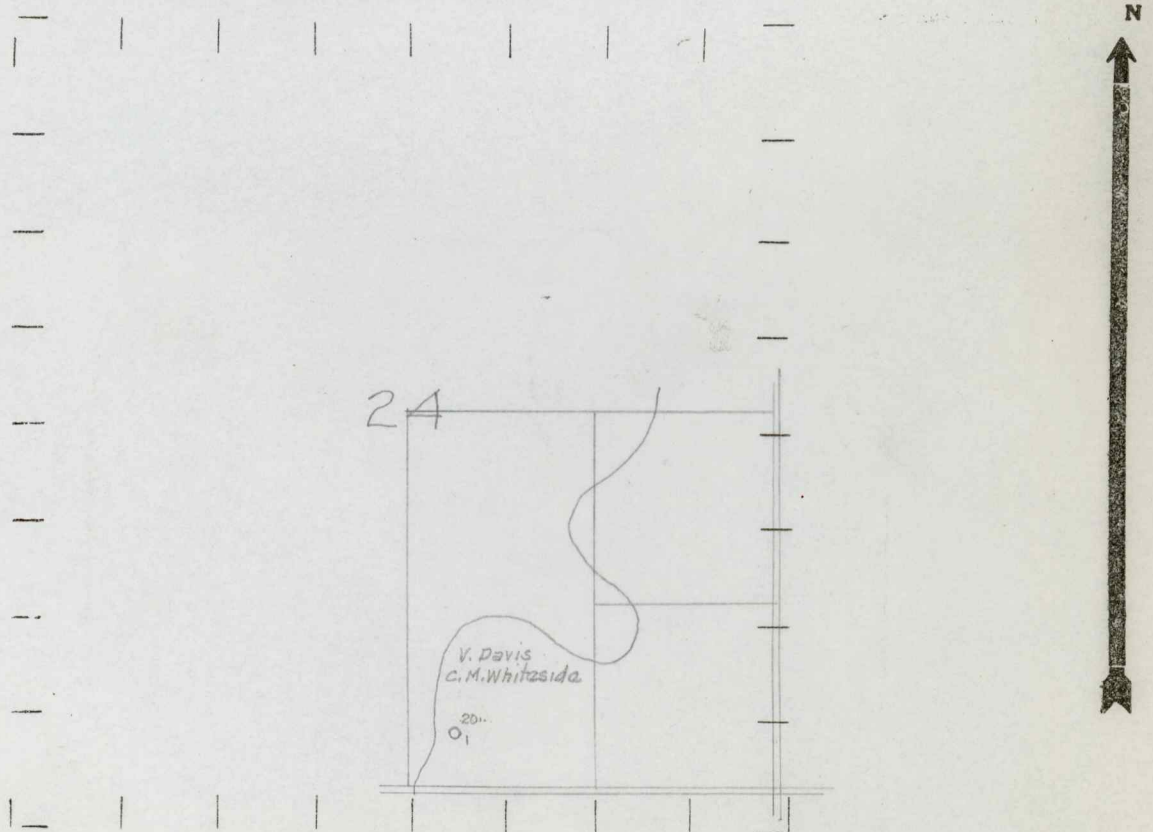

REMARKS:

SIGNED

Superintendent or Foreman.