



Western Michigan University  
ScholarWorks at WMU

---

Legacy Scout Tickets from Pure Oil Company

---

8-20-2021

**MGRRE\_PureOilScoutTickets\_Ealy, Harry Est.\_1\_21133037450000**

MGRRE

*Western Michigan University*

Follow this and additional works at: <https://scholarworks.wmich.edu/pure>



Part of the Geology Commons

---

#### **WMU ScholarWorks Citation**

MGRRE, "MGRRE\_PureOilScoutTickets\_Ealy, Harry Est.\_1\_21133037450000" (2021). *Legacy Scout Tickets from Pure Oil Company*. 8144.

<https://scholarworks.wmich.edu/pure/8144>

This Document is brought to you for free and open access via ScholarWorks at WMU. It has been accepted for inclusion in Legacy Scout Tickets from Pure Oil Company by an authorized administrator of ScholarWorks at WMU. See the National Digital Catalogue - Science Base Catalogue for more collections submitted by MGRRE.



---

**MGRRE\_PureOilScoutTickets\_Ealy, Harry Est.\_1\_21133037450000**

API 21133037450000

Permit Number 3745

Lease Name Ealy, Harry Est.

Well Number 1

County Osceola

Township 20N

Range 08W

Section 30

2021 DEQ or Pure co\_name Clapsaddle and Harris

Pure Number 22

Latitude 44.10145

Longitude -85.31492

The Pure Oil Company  
THE PURE OIL COMPANY

ASSOCIATION OF MINING ENGINEERS AND OTHER OPERATORS

DATE May 26, 1938

LOCATION REPORT

No. 22

STATE Michigan COUNTY Osceola DIST. Highland SEC. 30 TOWN 20 N. RANGE 8 W.

WELL No. 1 (SERIAL No. 22) FARM Harry Ealy, Estate ACRES \_\_\_\_\_

NAME OF STREAM OR WATERS \_\_\_\_\_ QUADRANGLE NW-NW-NE

OPERATOR Champion Devel. Company Map Highland Township, Osceola County  
Champion Devel. Co. Highland-Osc.

330 330 Feet from North Line of Farm

" " East " " "

" " South " " "

330 330 " " West " " "

330 330 Feet from North Line of Section

" " East " " "

" " South " " "

330 330 " " West " " 1/4

*Low*

LEGEND

- LOCATION
- ⊙ RIG
- ⊕ DRILLING
- ☀ GAS WELL
- OIL WELL
- ⊙ SMALL OIL WELL

- ⊙ DRY HOLE
- ⊙ DRY SHOWING OIL
- ⊙ DRY SHOWING GAS
- ⊙ ABANDONED LOCATION
- ☀ ABANDONED GAS WELL
- ⊙ ABANDONED OIL WELL

NOTE: Below make tracing from map, (when no map is obtainable make sketch) showing farm, center of section, this location with measurements and also wells, dry holes, or other locations in the vicinity of this location.

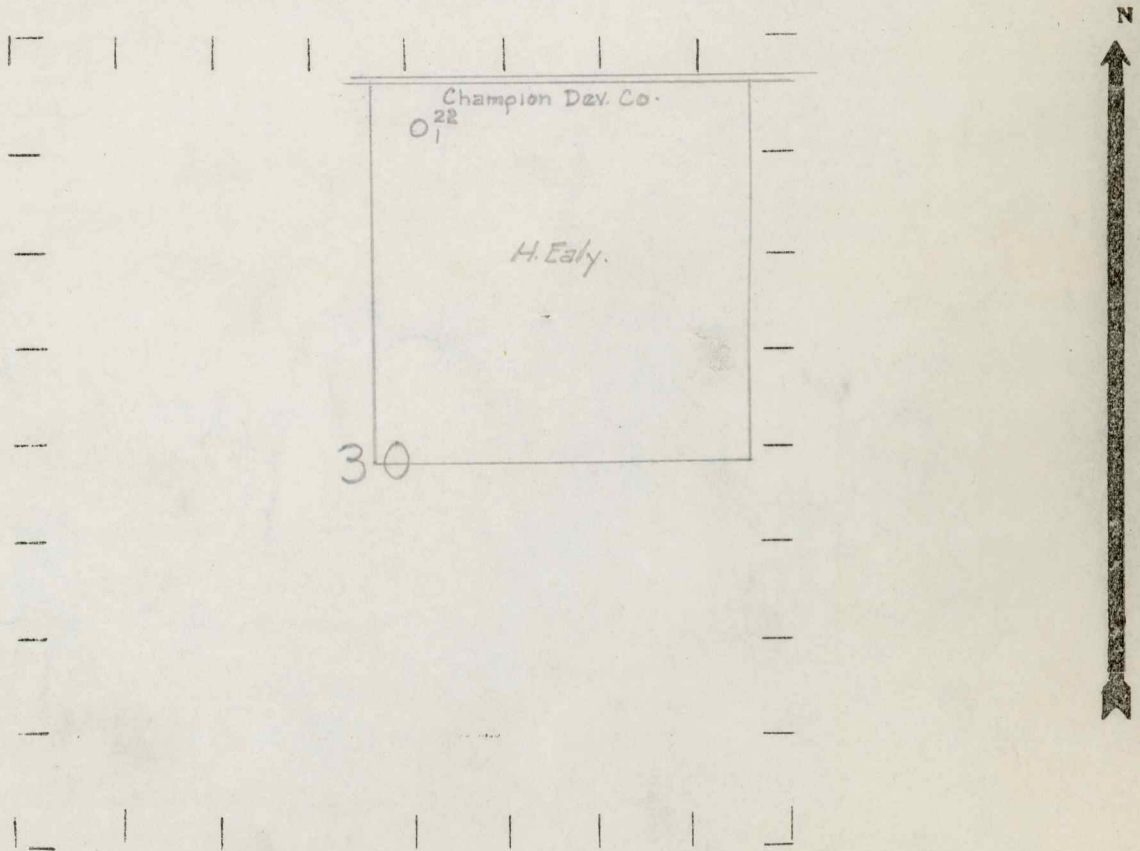

REMARKS:

\_\_\_\_\_  
\_\_\_\_\_  
\_\_\_\_\_

SIGNED

*R. L. Fryer*

Superintendent or Foreman.



