



Western Michigan University
ScholarWorks at WMU

Legacy Scout Tickets from Pure Oil Company

8-20-2021

**MGRRE_PureOilScoutTickets_Richardson, Wm
H_1_21133063610000**

MGRRE
Western Michigan University

Follow this and additional works at: <https://scholarworks.wmich.edu/pure>



Part of the Geology Commons

WMU ScholarWorks Citation

MGRRE, "MGRRE_PureOilScoutTickets_Richardson, Wm H_1_21133063610000" (2021). *Legacy Scout Tickets from Pure Oil Company*. 8150.
<https://scholarworks.wmich.edu/pure/8150>

This Document is brought to you for free and open access via ScholarWorks at WMU. It has been accepted for inclusion in Legacy Scout Tickets from Pure Oil Company by an authorized administrator of ScholarWorks at WMU. See the National Digital Catalogue - Science Base Catalogue for more collections submitted by MGRRE.



MGRRE_PureOilScoutTickets_Richardson, Wm H_1_21133063610000

API 21133063610000

Permit Number 6361

Lease Name Richardson, Wm H

Well Number 1

County Osceola

Township 18N

Range 09W

Section 23

2021 DEQ or Pure co_name Oryx Energy Company

Pure Number 28

Latitude 43.9307

Longitude -85.34616

THE PURE OIL COMPANY

DATE June 22, 1939

LOCATION REPORT

No. 28

STATE Michigan COUNTY Osceola DISTRICT Cedar TWP. Cedar SEC. 23 TOWN 18 N RANGE 9 W
WELL No. 1 (SERIAL No. 28) FARM W. H. Richardson ACRES

NAME OF STREAM OR WATERS _____ QUADRANGLE SE SE SE

OPERATOR Sun Oil Company Map Cedar Township, Osceola County

Sun Oil Co. Feet from North Line of Farm _____ Cedar-Osceola

165 1650 " " East " " "
165 1650 " " South " " "
" " West " " "

Feet from North Line of Section
330 330 " " East " " "
330 330 " " South " " "
" " West " " "

- LEGEND
- LOCATION
 - ⊕ RIG
 - ⊕ DRILLING
 - ☀ GAS WELL
 - OIL WELL
 - ⊕ SMALL OIL WELL
 - ⊕ DRY HOLE
 - ⊕ DRY SHOWING OIL
 - ⊕ DRY SHOWING GAS
 - ⊕ ABANDONED LOCATION
 - ☀ ABANDONED GAS WELL
 - ⊕ ABANDONED OIL WELL

NOTE: Below make tracing from map, (when no map is obtainable make sketch) showing farm, center of section, this location with measurements and also wells, dry holes, or other locations in the vicinity of this location.

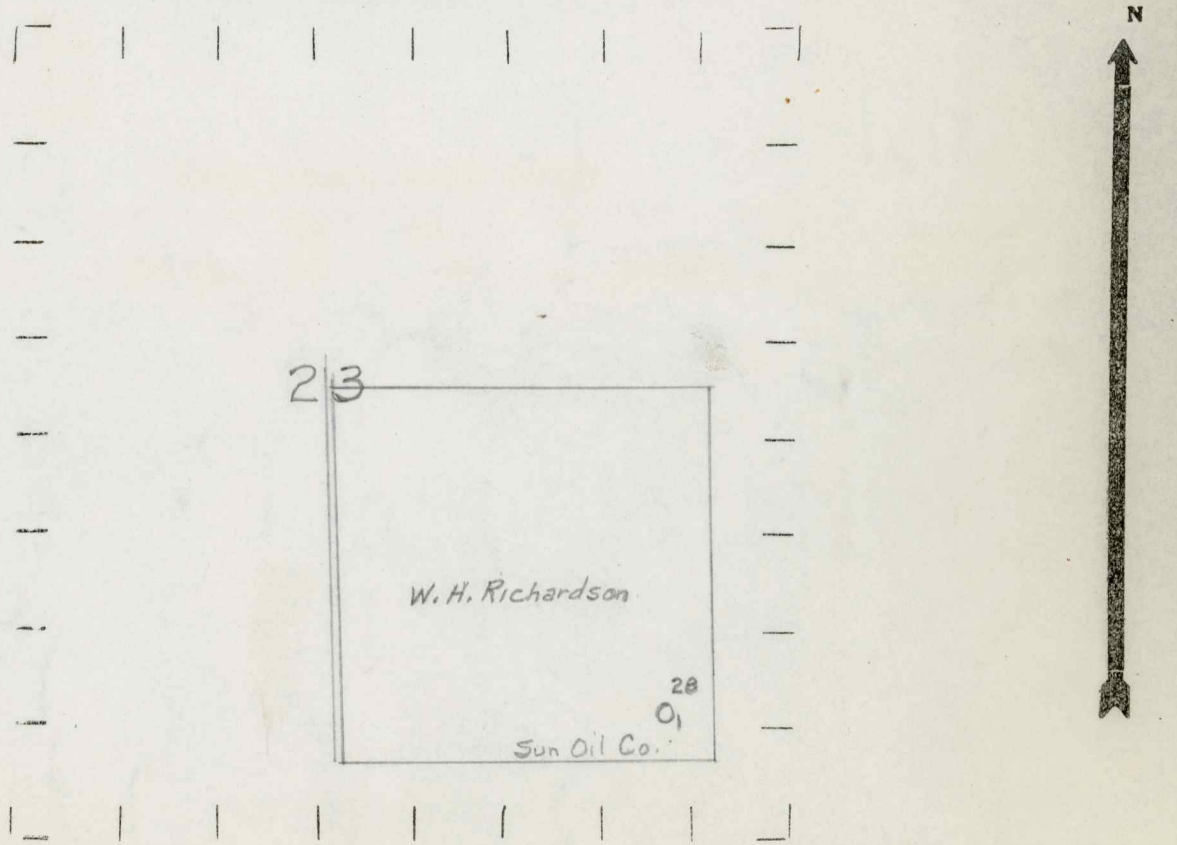

REMARKS: _____

SIGNED

Superintendent or Foreman.

COMPLETION RECORD OF WELLS DRILLED BY OTHER OPERATORS

Michigan Producing Division

Date September 14, 1939 No. 28
 State Mich. County Osceola Dist. Cedar Twp. 23 Sec. 18N Rge. 9W
 (Serial No.)
 Well No. 1 (County No.) 28 Farm W. H. Richardson Acres
 Operator Sun Oil Company Information secured from Scouting Department By
 Date well started 7/7/39 Dated well completed 9/9/39 Elevation 1275.5

PRODUCTION RECORD

1st 24 hours natural Dry Hole
 2nd 24 hours natural
 Date of shot No. of quarts From to From to
 Date of acid No. of gallons
 shot
 1st 24 hours after acid
 shot
 2nd 24 hours after acid

FORMATION AND CASING RECORD

Formation	Top	Bottom	Top Pay	Bottom Pay	Remarks	Casing	
						Size	Set at
Marshall	1634	SLM				10"	838
Red Rock	1830	1916				6-5/8"	1935
Sunbury	2645	2718				5-3/16"	3550
Antrim	3075	3356					
Traverse Line	3366			3418	S. Water		
Dundee	3975	SLM	4046	4066	2000'S.W. - 24 hrs.		
Total Depth		4066					

Remarks: Show water 865 - 878; H.F.W. 1162-72

Signed D. C. Shackelford