



Western Michigan University
ScholarWorks at WMU

Legacy Scout Tickets from Pure Oil Company

8-20-2021

MGRRE_PureOilScoutTickets_Perro-Gibson_42_21133080130000

MGRRE

Western Michigan University

Follow this and additional works at: <https://scholarworks.wmich.edu/pure>



Part of the Geology Commons

WMU ScholarWorks Citation

MGRRE, "MGRRE_PureOilScoutTickets_Perro-Gibson_42_21133080130000" (2021). *Legacy Scout Tickets from Pure Oil Company*. 8159.

<https://scholarworks.wmich.edu/pure/8159>

This Document is brought to you for free and open access via ScholarWorks at WMU. It has been accepted for inclusion in Legacy Scout Tickets from Pure Oil Company by an authorized administrator of ScholarWorks at WMU. See the National Digital Catalogue - Science Base Catalogue for more collections submitted by MGRRE.



MGRRE_PureOilScoutTickets_Perro-Gibson_42_21133080130000

API 21133080130000

Permit Number 8013

Lease Name Perro-Gibson

Well Number 42

County Osceola

Township 20N

Range 07W

Section 24

2021 DEQ or Pure co_name Taggart Brothers Company

Pure Number 43

Latitude 44.10608

Longitude -85.10248

THE PURE OIL COMPANY

DATE September 18, 1940

LOCATION RECORD OF LOCATION REPORT OTHER OPERATORS

No. 43 *

STATE Michigan COUNTY Osceola DISTRICT Marion TWP. Marion SEC. 24 TOWN 20 N RANGE 7 W
WELL No. 42 (SERIAL No. 43) FARM Perro-Gibson ACRES

NAME OF STREAM OR WATERS _____ QUADRANGLE C SW SW

OPERATOR Taggart Brothers Company Map Marion Township, Osceola County
Taggart Bros. Co. Marion - Osceola

Feet from North Line of Farm
1320 1320 " " East " " "
1320 1320 " " South " " "
" " West " " "
Feet from North Line of Section 1/4
1320 1320 " " East " " "
" " South " " "
1320 1320 " " West " " "

see road by 9-15-40
9" 445

LEGEND

- LOCATION
- ⊕ RIG
- ⊕ DRILLING
- ☀ GAS WELL
- OIL WELL
- SMALL OIL WELL
- ⊖ DRY HOLE
- ⊖ DRY SHOWING OIL
- ⊖ DRY SHOWING GAS
- ⊖ ABANDONED LOCATION
- ⊖ ABANDONED GAS WELL
- ⊖ ABANDONED OIL WELL

NOTE: Below make tracing from map. (when no map is obtainable make sketch) showing farm, center of section, this location with measurements and also wells, dry holes, or other locations in the vicinity of this location.

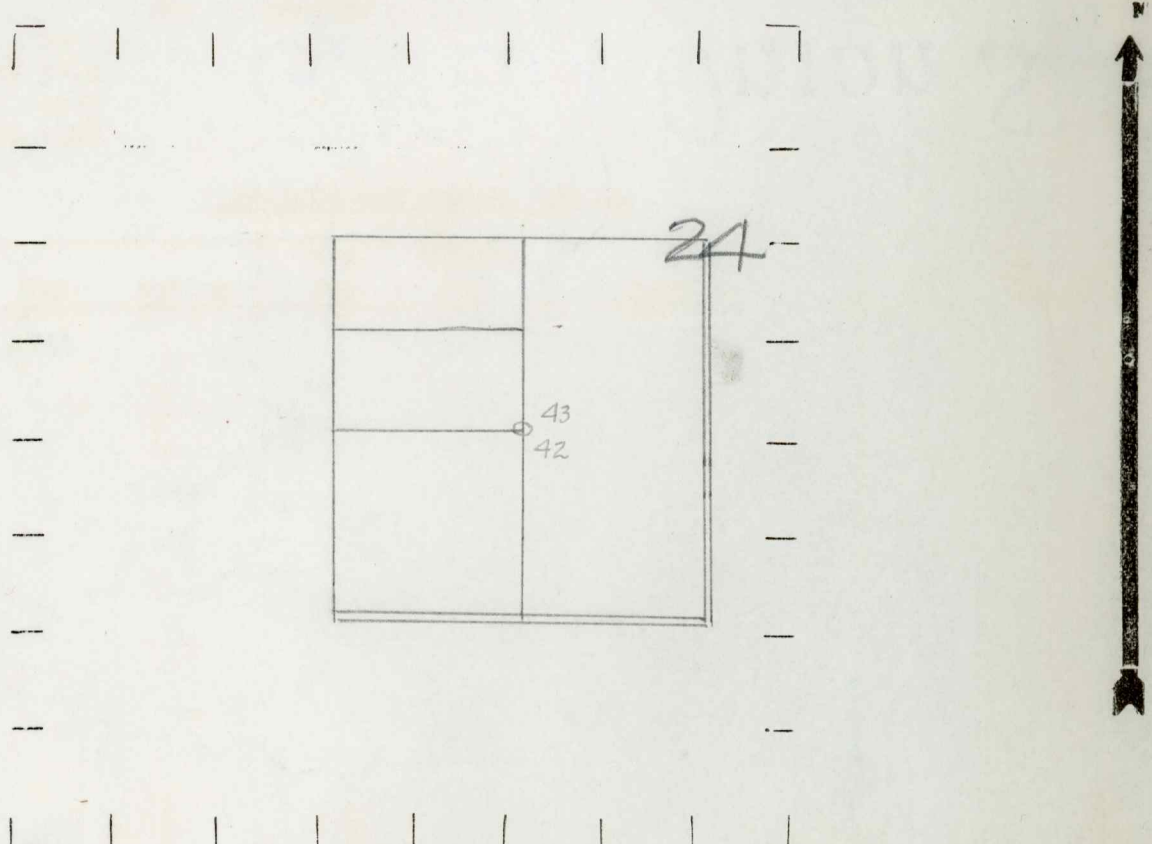

REMARKS:

SIGNED

W

Superintendent or Foreman.

Date September 25, 1940 No. 43
 State Mich. County Osceola District Marion Twp. 24 Twp. 20 N Rge. 7 W
 Well No. 42 (Serial No.) 43 Farm Perro-Gibson Acres _____
 Operator Taggart Brothers Company Information secured from Scouting Department
 Date well started 9-15-40 Dated well completed 9-21-40 Elevation 1129.0

PRODUCTION RECORD

1st 24 hours natural Dry Hole
 2nd 24 hours natural _____
 Date of shot _____ No. of quarts _____ From _____ to _____ From _____ to _____
 Date of acid _____ No. of gallons _____
 1st 24 hours after acid shot _____
 2nd 24 hours after acid shot _____

FORMATION AND CASING RECORD

Formation	Top	Bottom	Top Pay	Bottom Pay	Remarks	Casing	
						Size	Set at
Stray	1383			1383	Show oil and gas.	9"	445
				1391	Gauged: ^{124,000} cu. ft. gas.	5-3/16"	1356
				1400	Water.		
Total Depth		1402					

Remarks _____

Signed D. C. Shackelford