



Western Michigan University  
ScholarWorks at WMU

---

Legacy Scout Tickets from Pure Oil Company

---

8-20-2021

**MGRRE\_PureOilScoutTickets\_Riggs Sherer\_15\_21133085530000**

MGRRE

*Western Michigan University*

Follow this and additional works at: <https://scholarworks.wmich.edu/pure>



Part of the Geology Commons

---

#### **WMU ScholarWorks Citation**

MGRRE, "MGRRE\_PureOilScoutTickets\_Riggs Sherer\_15\_21133085530000" (2021). *Legacy Scout Tickets from Pure Oil Company*. 8177.

<https://scholarworks.wmich.edu/pure/8177>

This Document is brought to you for free and open access via ScholarWorks at WMU. It has been accepted for inclusion in Legacy Scout Tickets from Pure Oil Company by an authorized administrator of ScholarWorks at WMU. See the National Digital Catalogue - Science Base Catalogue for more collections submitted by MGRRE.



---

**MGRRE\_PureOilScoutTickets\_Riggs Sherer\_15\_21133085530000**

API 21133085530000

Permit Number 8553

Lease Name Riggs Sherer

Well Number 15

County Osceola

Township 18N

Range 10W

Section 19

2021 DEQ or Pure co\_name Mid Michigan Gas well in Stray. Stratigraphic and production data.  
orage Company

Pure Number 64

Latitude 43.9373175

Longitude -85.5471161

WELL REPORT - OUTSIDE OPERATIONS

SERIAL NO. 64

STATE Michigan ~~PSH~~ Osceola  
CO.

OPERATOR Michigan Consolidated Gas Company

FARM Riggs - Sharer WELL NO. 15

~~TWP~~ Lincoln S. 19 T. 18N R. 10W  
SURVEY

LOC. C E<sub>2</sub>

WILDCAT  FIELD  FIELD NAME \_\_\_\_\_

MAP NO. \_\_\_\_\_ CO-ORD. \_\_\_\_\_ ELEV. \_\_\_\_\_

STATUS \_\_\_\_\_

Operator's name changed from:  
Taggart Brothers Company

NORTH

DATE 12-5-49 SCOUT H. J. G.

DATE April 23, 1941

LOCATION REPORT

No. 64

STATE Michigan COUNTY Osceola DIST Lincoln TWP Lincoln SEC 19 TOWN 18 N RANGE 10 W  
WELL No. 15 (SERIAL No. 64) FARM Riggs-Sharer Sharer ACRES

NAME OF STREAM OR WATERS QUADRANGLE E 1/2

OPERATOR Taggart Brothers Company Map Lincoln Township, Osceola County

Taggart Bros Co  
Feet from North Line of Farm

1320 1320 " " East " " "

1320 1320 " " South " " "

1320 1320 " " West " " "

0 0 Feet from North Line of Section 1/4 X

1320 1320 " " East " " "

" " South " " "

" " West " " "

LEGEND

- LOCATION
- ⊕ RIG
- ⊕ DRILLING
- ☀ GAS WELL
- OIL WELL
- SMALL OIL WELL
- ⊙ DRY HOLE
- DRY SHOWING OIL
- ☀ DRY SHOWING GAS
- ⊙ ABANDONED LOCATION
- ☀ ABANDONED GAS WELL
- ABANDONED OIL WELL

NOTE: Below make tracing from map. (when no map is obtainable make sketch) showing farm, center of section, this location with measurements and also wells, dry holes, or other locations in the vicinity of this location.

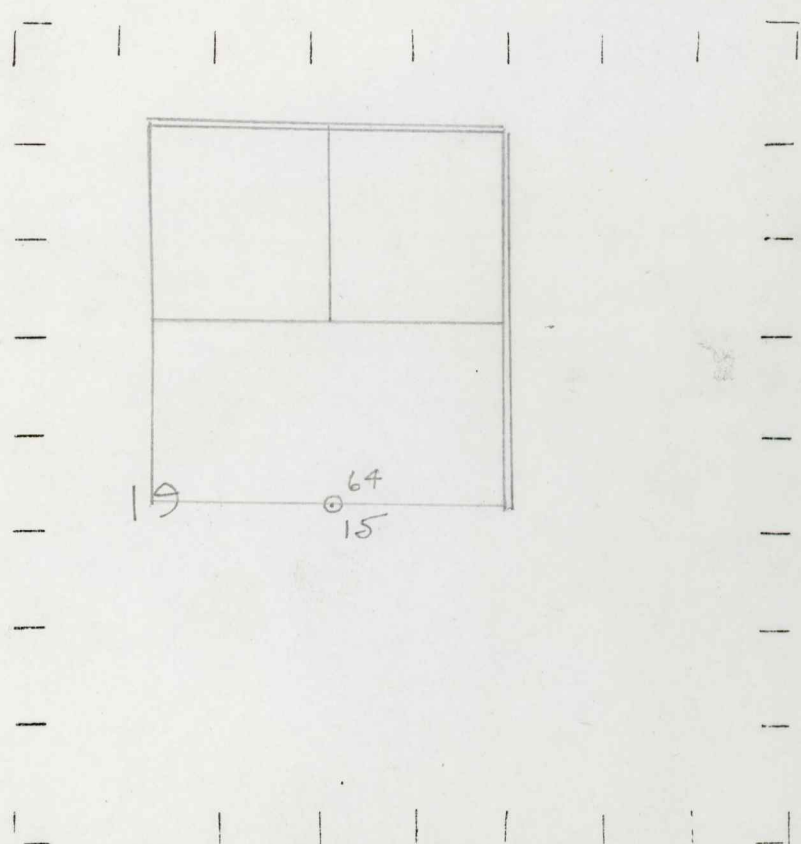

REMARKS:

.....  
.....  
.....

SIGNED

*W*

Superintendent or Foreman.

