



Western Michigan University
ScholarWorks at WMU

Legacy Scout Tickets from Pure Oil Company

8-20-2021

**MGRRE_PureOilScoutTickets_Reber-Pratt-
Nelson_19_21133085950000**

MGRRE
Western Michigan University

Follow this and additional works at: <https://scholarworks.wmich.edu/pure>



Part of the Geology Commons

WMU ScholarWorks Citation

MGRRE, "MGRRE_PureOilScoutTickets_Reber-Pratt-Nelson_19_21133085950000" (2021). *Legacy Scout Tickets from Pure Oil Company*. 8182.
<https://scholarworks.wmich.edu/pure/8182>

This Document is brought to you for free and open access via ScholarWorks at WMU. It has been accepted for inclusion in Legacy Scout Tickets from Pure Oil Company by an authorized administrator of ScholarWorks at WMU. See the National Digital Catalogue - Science Base Catalogue for more collections submitted by MGRRE.



MGRRE_PureOilScoutTickets_Reber-Pratt-Nelson_19_21133085950000

API 21133085950000

Permit Number 8595

Lease Name Reber-Pratt-Nelson

Well Number 19

County Osceola

Township 18N

Range 10W

Section 32

2021 DEQ or Pure co_name Taggart Brothers Company

Pure Number 69

Latitude 43.91264

Longitude -85.5277

THE PURE OIL COMPANY

DATE May 7, 1941

The LOCATION REPORT

No. 69

COMPLETION RECORD OF WELLS DRILLED BY OTHER OPERATORS

STATE Michigan COUNTY Osceola DIST. Lincoln TWP. Lincoln SEC. 32 TOWN 18 N RANGE 10 W
WELL No. 19 (SERIAL No. 69) FARM Heber-Pratt-Nelson ACRES

NAME OF STREAM OR WATERS _____ QUADRANGLE C NE 1/4

OPERATOR Taggart Brothers Company Map Lincoln Township, Osceola Co

13701320 Feet from North Line of Farm
13701320 " " East " " "
" " South " " "
" " West " " "
Feet from North Line of Section
" " East " " "
13701320 " " South " 1/4 "
13701320 " " West " 1/4 "

LEGEND

- LOCATION
- ⊕ RIG
- ⊕ DRILLING
- ☀ GAS WELL
- OIL WELL
- ◆ SMALL OIL WELL
- ⊙ DRY HOLE
- DRY SHOWING OIL
- ⊙ DRY SHOWING GAS
- ⊙ ABANDONED LOCATION
- ☀ ABANDONED GAS WELL
- ABANDONED OIL WELL

NOTE: Below make tracing from map. (when no map is obtainable make sketch) showing farm, center of section, this location with measurements and also wells, dry holes, or other locations in the vicinity of this location.

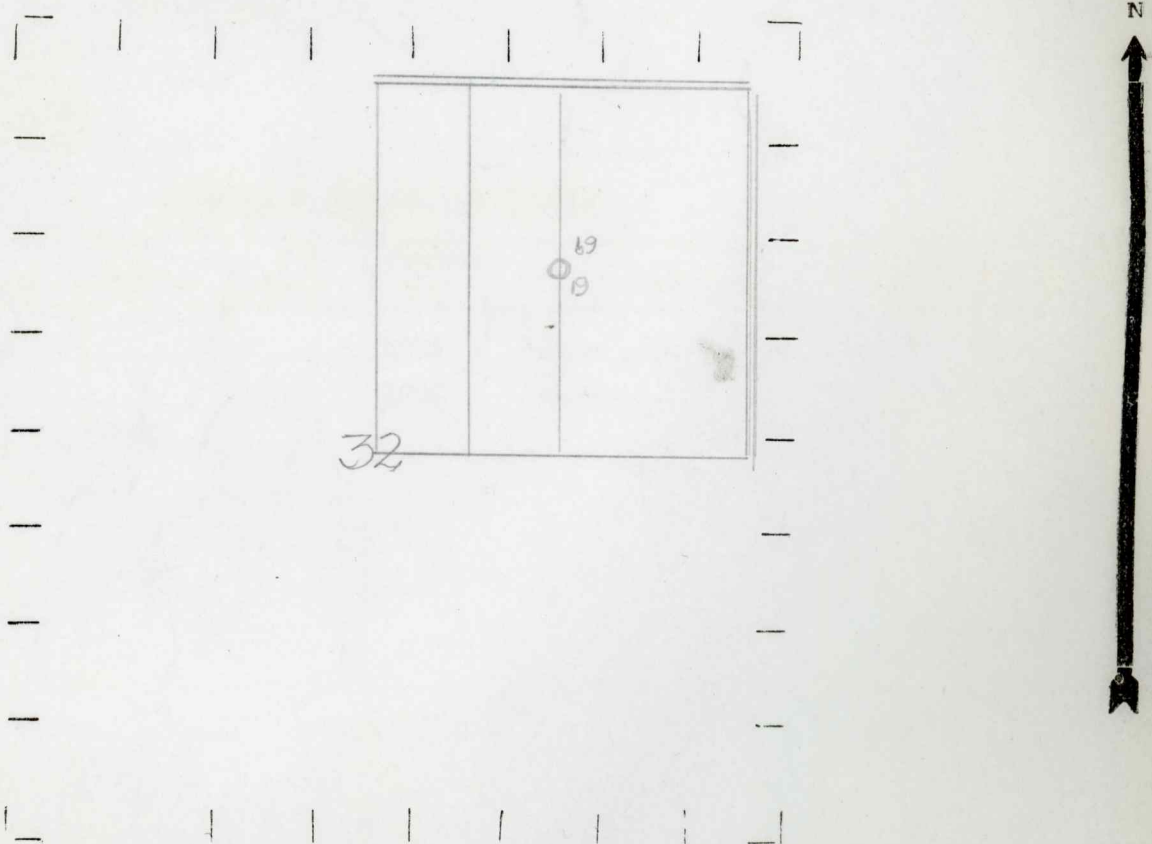

REMARKS:

SIGNED

Superintendent or Foreman.

Michigan Producing Division

Date May 21, 1941 No. 69
 State Mich. County Osceola Dist. Lincoln Twp. 18 N Rge. 10 W
 Well No. 19 (Serial No.) 69 Farm Reber-Pratt-Nelson Acres _____
 Operator Taggart Brothers Company Information secured By Scouting Department
 Date well started 5-7-41 Date well completed 5-14-41 Elevation 1096.7

PRODUCTION RECORD

1st 24 hours natural Dry Hole
 2nd 24 hours natural _____
 Date of shot _____ No. of quarts _____ From _____ to _____ From _____ to _____
 Date of acid _____ No. of gallons _____
 1st 24 hours after acid shot _____
 2nd 24 hours after acid shot _____

FORMATION AND CASING RECORD

Formation	Top	Bottom	Top Pay	Bottom Pay	Remarks	Casing	
						Size	Set at
<u>Stray</u>	<u>1205</u>			<u>1208</u>	<u>Show gas.</u>	<u>8-1/4"</u>	<u>344</u>
				<u>1208</u>	<u>Water.</u>	<u>5-3/16"</u>	<u>1190</u>
<u>Total Depth</u>		<u>1208</u>					

Remarks _____

Signed D. C. Shackelford