



Western Michigan University
ScholarWorks at WMU

Legacy Scout Tickets from Pure Oil Company

8-20-2021

MGRRE_PureOilScoutTickets_Henry_1_21133086640000

MGRRE

Western Michigan University

Follow this and additional works at: <https://scholarworks.wmich.edu/pure>



Part of the Geology Commons

WMU ScholarWorks Citation

MGRRE, "MGRRE_PureOilScoutTickets_Henry_1_21133086640000" (2021). *Legacy Scout Tickets from Pure Oil Company*. 8189.

<https://scholarworks.wmich.edu/pure/8189>

This Document is brought to you for free and open access via ScholarWorks at WMU. It has been accepted for inclusion in Legacy Scout Tickets from Pure Oil Company by an authorized administrator of ScholarWorks at WMU. See the National Digital Catalogue - Science Base Catalogue for more collections submitted by MGRRE.



MGRRE_PureOilScoutTickets_Henry_1_21133086640000

API 21133086640000

Permit Number 8664

Lease Name Henry

Well Number 1

County Osceola

Township 18N

Range 10W

Section 31

2021 DEQ or Pure co_name Mid Michigan Gas well in Stray. Stratigraphic and production data.
orage Company

Pure Number 78

Latitude 43.9152807

Longitude -85.5540315

WELL REPORT - OUTSIDE OPERATIONS

SERIAL NO. 78

STATE Michigan ~~XBSM~~ CO. Osceola

OPERATOR Gulf Refining Co. EPD

FARM Henry WELL NO. 1

TWP. SURVEY Lincoln S. 31 T. 18N R. 10W

LOC. NE NE NW

WILDCAT FIELD FIELD NAME _____

MAP NO. _____ CO-ORD. _____ ELEV. _____

STATUS _____

Fl. 150 B0 + 20 BSW NTD 4653

To deepen to approx. 4655' to test Richfield zone.

NORTH

DATE 6-21-54 SCOUT JEC

DATE June 11, 1941

LOCATION REPORT

No. 78 *

COMPLETION RECORD OF WELLS DRILLED BY OTHER OPERATORS

STATE Michigan

COUNTY Osceola

DIST Lincoln
TWP Lincoln
PREC Henry

SEC 31

TOWN 18 N

RANGE 10 W

WELL No. 1 (SERIAL No. 78) FARM

ACRES

NAME OF STREAM OR WATERS

QUADRANGLE NE-NE NW

OPERATOR Gulf Refining Company

Map Lincoln Township, Osceola County

330 330 Feet from North Line of Farm

370 370 " " East " " "

" " South " " "

" " West " " "

330 330 Feet from North Line of Section

370 370 " " East " " "

" " South " " "

" " West " " "

1335
Sp 6-5-41
10" 85
Y 20 +
1145
Y 7m Ad
1250
Y 4m Ad
1285

LEGEND

○ LOCATION

⊕ RIG

⊕ DRILLING

☀ GAS WELL

● OIL WELL

⬇ SMALL OIL WELL

⊖ DRY HOLE

⬆ DRY SHOWING OIL

⊖ DRY SHOWING GAS

⊖ ABANDONED LOCATION

☀ ABANDONED GAS WELL

⬆ ABANDONED OIL WELL

NOTE: Below make tracing from map. (when no map is obtainable make sketch) showing farm, center of section, this location with measurements and also wells, dry holes, or other locations in the vicinity of this location.

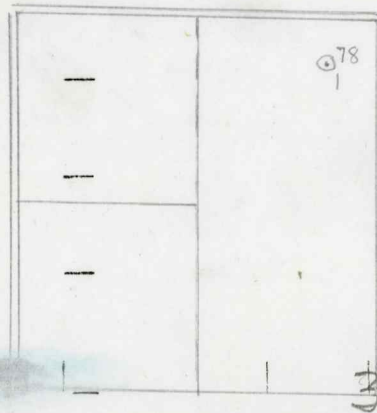

REMARKS:

SIGNED

W

Superintendent or Foreman.

OBSERVATION Gulf Refining Company
 NAME OF SURVEYOR OR MALEERS
 WELL NO. 1 (SERIAL NO. 78) (COUNTY NO. 78) DIST. LINCOLN TWP. 18 N RGE. 10 W

Date July 16, 1941 No. 78
 State Mich. County Osceola Dist. Lincoln Sec. 31 Twp. 18 N Rge. 10 W
 Well No. 1 (Serial No.) 78 Farm Henry Acres
 Operator Gulf Refining Company Information secured By Scouting Department
 Date well started 6-5-41 Date well completed 7-11-41 Elevation 1168.7

PRODUCTION RECORD

1st 24 hours natural Flowed est. 6000 Barrels.
 2nd 24 hours natural
 Date of shot No. of quarts From to From to
 Date of acid No. of gallons
 1st 24 hours after acid shot
 2nd 24 hours after acid shot

FORMATION AND CASING RECORD

Formation	Top	Bottom	Top Pay	Bottom Pay	Remarks	Casing	
						Size	Set at
Stray	1250					7"	1529
Marshall	1285					5-3/16"	3613
Antrim	2635			2975	Show gas.		
Traverse Lime	2955			2980	Hole full water.		
Dundee	3524	S.L.M.					
Monroe	3601			3629	Show oil and gas.		
			3638	3640			
Total Depth		3640					

Remarks 3525' C.T.M. equals 3509' S.L.M.

Signed D. C. Shackelford