



Western Michigan University
ScholarWorks at WMU

Legacy Scout Tickets from Pure Oil Company

8-20-2021

**MGRRE_PureOilScoutTickets_Stedman, Paul
N_1_21133087670000**

MGRRE
Western Michigan University

Follow this and additional works at: <https://scholarworks.wmich.edu/pure>



Part of the Geology Commons

WMU ScholarWorks Citation

MGRRE, "MGRRE_PureOilScoutTickets_Stedman, Paul N_1_21133087670000" (2021). *Legacy Scout Tickets from Pure Oil Company*. 8208.
<https://scholarworks.wmich.edu/pure/8208>

This Document is brought to you for free and open access via ScholarWorks at WMU. It has been accepted for inclusion in Legacy Scout Tickets from Pure Oil Company by an authorized administrator of ScholarWorks at WMU. See the National Digital Catalogue - Science Base Catalogue for more collections submitted by MGRRE.



MGRRE_PureOilScoutTickets_Stedman, Paul N_1_21133087670000

API 21133087670000

Permit Number 8767

Lease Name Stedman, Paul N

Well Number 1

County Osceola

Township 18N

Range 10W

Section 29

2021 DEQ or Pure co_name Mid Michigan Gas well in Stray. Stratigraphic and production data.
orage Company

Pure Number 104

Latitude 43.9276111

Longitude -85.5400233

WELL REPORT - OUTSIDE OPERATIONS

SERIAL NO. 104

104

STATE Michigan ^{XPS} _{CO.} Osceola

OPERATOR The Ohio Oil Co.

FARM Paul N. Stedman WELL NO. 1

TWP. Lincoln S. 29 T. 18N R. 10W

LOC. C S $\frac{1}{2}$ NW NW

WILDCAT FIELD FIELD NAME _____

MAP NO. _____ CO-ORD. _____ ELEV. _____

STATUS To Plug off Reed City Zone, Perf.
opposite Traverse Lime, Acidize & Test.

AIP: Pump 10 B O & STW/D

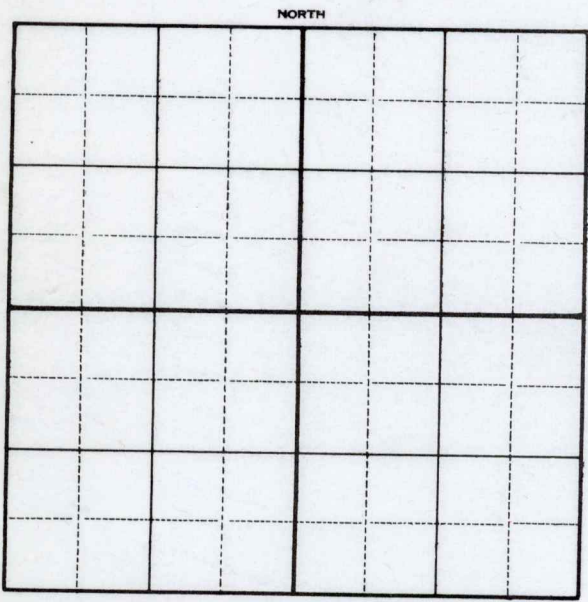

DATE 6-18-56 SCOUT RFP

SERVICE NO. 107 OIL COMPANY

DATE July 16, 1941 LOCATION RECORD OF LOCATION REPORT OTHER OPERATORS

No. 104

STATE Michigan COUNTY Osceola DISTRICT Osceola Division TWP Lincoln SEC. 29 TOWN 18 N RANGE 10 W

WELL No. 1 (SERIAL No. 104) FARM Paul N. Stedman ACRES

NAME OF STREAM OR WATERS QUADRANGLE C S 2 NW NW

OPERATOR The Ohio Oil Company Map Lincoln Township, Osceola County
The Ohio Oil Co. Lincoln - Osceola

		Feet from North Line of Farm			
		East			
330	320	South			
660	660	West			
		Feet from North Line of Section			
		East			
		South			
660	660	West			



LEGEND

- LOCATION
- ⊕ RIG
- ⊕ DRILLING
- ☀ GAS WELL
- OIL WELL
- ⬮ SMALL OIL WELL
- ⊙ DRY HOLE
- ⬮ DRY SHOWING OIL
- ⊙ DRY SHOWING GAS
- ⊙ ABANDONED LOCATION
- ☀ ABANDONED GAS WELL
- ⬮ ABANDONED OIL WELL

NOTE: Below make tracing from map. (when no map is obtainable make sketch) showing farm, center of section, this location with measurements and also wells, dry holes, or other locations in the vicinity of this location.

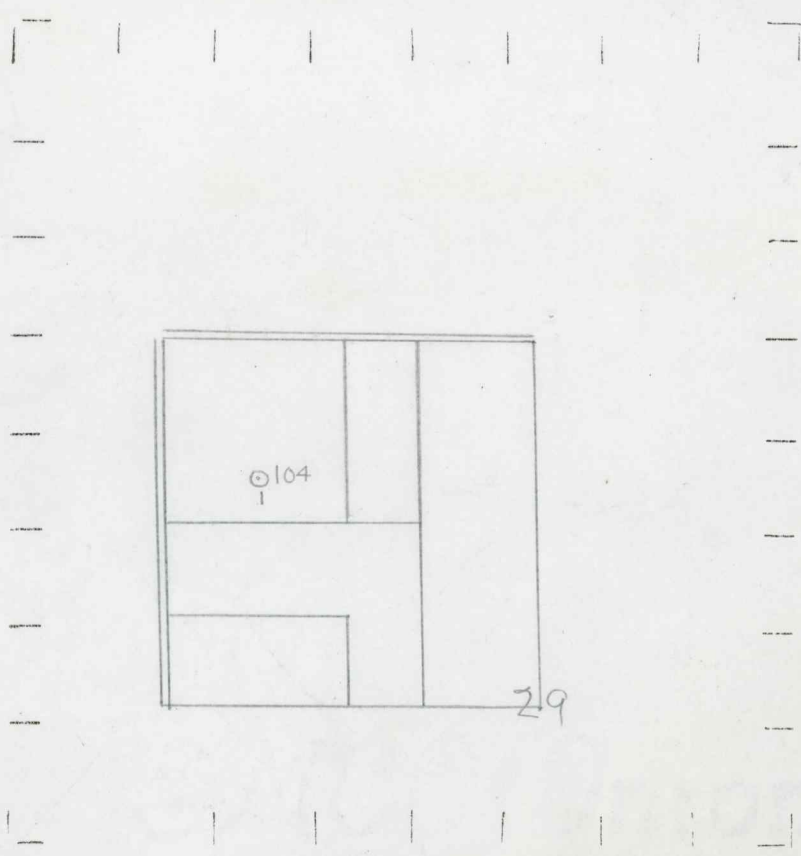

REMARKS:

SIGNED

W

Superintendent or Foreman.

REF FROM NORTH LINE OF EARTH

OBSERVATOR THE OHIO OIL COMPANY

WELL THE OHIO OIL COMPANY

NAME OF SURVEYOR OR MAJORS

DATE OF SURVEY

WELL NO. 1 (SERIAL NO. 104)

DATE OF SURVEY

Date September 4, 1941

No. 104

State Mich. County Osceola

Dist. Lincoln

Twp. Lincoln

Sec. 29

Twp. 18 N

Rge. 10 W

Well No. 1 (Serial No. 104)

Farm Paul N. Stedman

Acres

Operator The Ohio Oil Company

Information secured from Scouting Department

Date well started 7-17-41

Date well completed 8-29-41

Elevation 1130.1

PRODUCTION RECORD

1st 24 hours natural 7800 Barrels

2nd 24 hours natural

Date of shot No. of quarts From to From to

Date of acid No. of gallons

1st 24 hours after acid shot

2nd 24 hours after acid shot

FORMATION AND CASING RECORD

Formation	Top	Bottom	Top Pay	Bottom Pay	Remarks	Casing	
						Size	Set at
Brown Dolomite	1090					10"	300
Stray	1185					8-1/4"	400
Red Rock		1475				7"	1566
Goldw. Red Rock	2078	2085				5-3/16"	3541
Antrim	2575						
Traverse Lime	2898	C.T.M.		2905	Show oil and gas.		
Dundee	3464	S.L.M.	3464	2955	H.F.S.W.		
Monroe	3534 ?		3557	3474			
			3565	3558	Gas.		
			3573	3566			
			3582	3573			
				3584			
Total Depth		3584					

Remarks

Signed D. C. Shackelford