



Western Michigan University
ScholarWorks at WMU

Legacy Scout Tickets from Pure Oil Company

8-20-2021

MGRRE_PureOilScoutTickets_Clark, H J_2_21133088320000

MGRRE

Western Michigan University

Follow this and additional works at: <https://scholarworks.wmich.edu/pure>



Part of the Geology Commons

WMU ScholarWorks Citation

MGRRE, "MGRRE_PureOilScoutTickets_Clark, H J_2_21133088320000" (2021). *Legacy Scout Tickets from Pure Oil Company*. 8220.

<https://scholarworks.wmich.edu/pure/8220>

This Document is brought to you for free and open access via ScholarWorks at WMU. It has been accepted for inclusion in Legacy Scout Tickets from Pure Oil Company by an authorized administrator of ScholarWorks at WMU. See the National Digital Catalogue - Science Base Catalogue for more collections submitted by MGRRE.



MGRRE_PureOilScoutTickets_Clark, H J_2_21133088320000

API 21133088320000

Permit Number 8832

Lease Name Clark, H J

Well Number 2

County Osceola

Township 18N

Range 10W

Section 30

2021 DEQ or Pure co_name Mid Michigan Gas well in Stray. Stratigraphic and production data.
orage Company

Pure Number 120

Latitude 43.9258934

Longitude -85.545065

THE PURE OIL COMPANY

DATE August 13, 1941

LOCATION REPORT

No. 120

STATE Michigan COUNTY Osceola DIST. Lincoln TWP. Lincoln SEC. 30 TOWN 18 N RANGE 10 W
 WELL No. 22 (SERIAL No. 120) FARM H. J. Clark ACRES _____

NAME OF STREAM OR WATERS _____ QUADRANGLE 0 1/2 SE NE - NE

OPERATOR Weber Oil Company Map Lincoln Township, Osceola County

330 330 Ohio Weber Oil Co
 Feet from North Line of Farm

660 660 " " East " " "

" " South " " "

" " West " " "

Feet from North Line of Section

660 660 " " East " " 1/4

990 990 " " South " " "

" " West " " "

h.p. wacs - 65/8
Sp 8-3-41
10" 420
Y Bu +
1145
Y m ss
1240

LEGEND

- LOCATION
- ⊕ RIG
- ⊕ DRILLING
- ☀ GAS WELL
- OIL WELL
- SMALL OIL WELL
- ⊖ DRY HOLE
- ◆ DRY SHOWING OIL
- ⊖ DRY SHOWING GAS
- ⊖ ABANDONED LOCATION
- ☀ ABANDONED GAS WELL
- ABANDONED OIL WELL

NOTE: Below make tracing from map. (when no map is obtainable make sketch) showing farm, center of section, this location with measurements and also wells, dry holes, or other locations in the vicinity of this location.

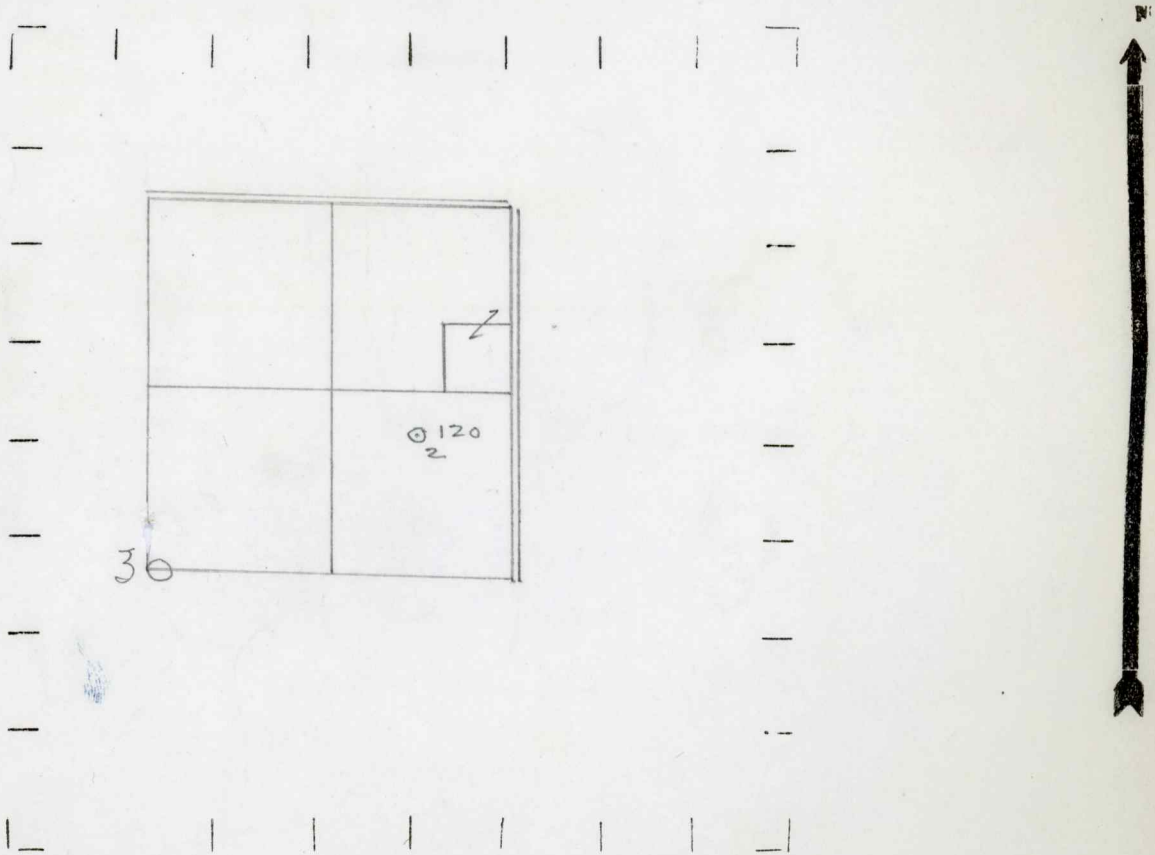

REMARKS:

SIGNED

Superintendent or Foreman.

OK

LOCATION
 DISTRICT
 No. 120
 State Mich. County Osceola Dist. Lincoln Sec. 30 Twp. 18 N Rge. 10 W
 Well No. 2 (Serial No.) 120 Farm H. J. Clark Acres
 Operator Weber Oil Company Information secured from Scouting Department
 Date well started 8-3-41 Date well completed 9-12-41 Elevation 1173.8

PRODUCTION RECORD

1st 24 hours natural 145 Barrels
 2nd 24 hours natural
 Date of shot 9-17-41 and 9-19-41 No. of quarts From to From to
 Date of acid 9-19-41 No. of gallons 1200
 1st 24 hours after acid 300 Barrels
 2nd 24 hours after acid

FORMATION AND CASING RECORD

Formation	Top	Bottom	Top Pay	Bottom Pay	Remarks	Casing	
						Size	Set at
Brown Dolomite Stray	1145					10"	420
Antrim	2620	2909				6-5/8"	1575
Traverse Lime	2944	S.L.M.		2964 ?	Oil, gas, water.	5-3/16"	3585
Dundee	3515	"	3518				
Monroe	3585		3618	3620			
			3630	3633			
			3654	3656	Water.		
Total Depth		3656					
Plugged back:		3646					

Remarks

Signed D. C. Shackelford