



Western Michigan University  
ScholarWorks at WMU

---

Legacy Scout Tickets from Pure Oil Company

---

8-20-2021

**MGRRE\_PureOilScoutTickets\_Lomp, Mary\_1\_21133088710000**

MGRRE

*Western Michigan University*

Follow this and additional works at: <https://scholarworks.wmich.edu/pure>



Part of the Geology Commons

---

#### **WMU ScholarWorks Citation**

MGRRE, "MGRRE\_PureOilScoutTickets\_Lomp, Mary\_1\_21133088710000" (2021). *Legacy Scout Tickets from Pure Oil Company*. 8229.

<https://scholarworks.wmich.edu/pure/8229>

This Document is brought to you for free and open access via ScholarWorks at WMU. It has been accepted for inclusion in Legacy Scout Tickets from Pure Oil Company by an authorized administrator of ScholarWorks at WMU. See the National Digital Catalogue - Science Base Catalogue for more collections submitted by MGRRE.



---

**MGRRE\_PureOilScoutTickets\_Lomp, Mary\_1\_21133088710000**

API 21133088710000

Permit Number 8871

Lease Name Lomp, Mary

Well Number 1

County Osceola

Township 18N

Range 10W

Section 32

2021 DEQ or Pure co\_name Mid Michigan Gas well in Stray. Stratigraphic and production data.  
orage Company

Pure Number 133

Latitude 43.9133357

Longitude -85.540161

WELL REPORT - OUTSIDE OPERATIONS THE PURE OIL COMPANY

DATE August 20, 1947

SERIAL NO. 133

WELL REPORT

No. 133

STATE Michigan <sup>BSM</sup> CO. Osceola

OPERATOR Gulf Refining Co.

FARM Mary Lomp WELL NO. 1

TWP. Lincoln S. 32 T. 18N R. 10W

LOC. C S<sup>1</sup>/<sub>2</sub> NW NW

WILDCAT  FIELD  FIELD NAME Reed City

MAP NO. CO-ORD. ELEV.

STATUS Plugged and abandoned \* March 17, 1953

Total Depth -.3623'

NORTH

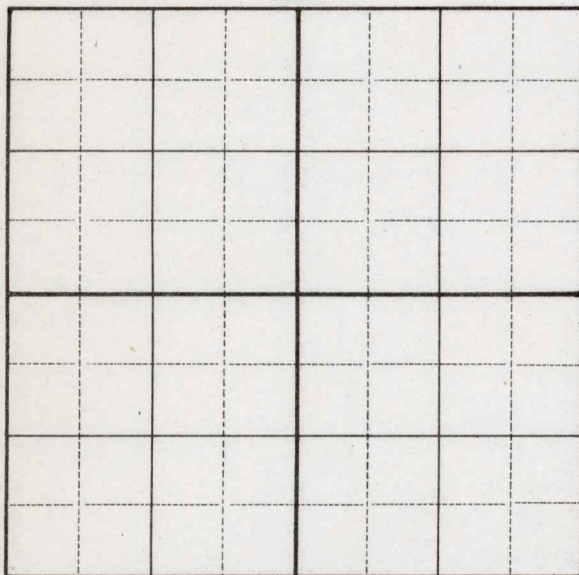

DATE 4-29-53 SCOUT JEC

STATE Michigan COUNTY Osceola DIST. Lincoln TWP. Lincoln SEC. 32 TOWN 18 N RANGE 10 W  
 WELL No. 1 (SERIAL No. 133) FARM Mary Tompkins ACRES  
 NAME OF STREAM OR WATERS QUADRANGLE E 3/4 NW NW

OPERATOR Gulf Refining Company Map Lincoln Township, Osceola County  
 Gulf Refining Co. Lincoln - Osceola

Feet from North Line of Farm  
 660 660 " " East " " "  
 330 330 " " South " " "  
 660 660 " " West " " "  
 990 990 Feet from North Line of Section 1/4 1/4  
 " " East " " "  
 " " South " " "  
 660 660 " " West " " "

- LEGEND**
- LOCATION
  - ⊙ RIG
  - ⊕ DRILLING
  - ☀ GAS WELL
  - OIL WELL
  - SMALL OIL WELL
  - ⊙ DRY HOLE
  - ◆ DRY SHOWING OIL
  - ⊙ DRY SHOWING GAS
  - ⊙ ABANDONED LOCATION
  - ☀ ABANDONED GAS WELL
  - ABANDONED OIL WELL

NOTE: Below make tracing from map. (when no map is obtainable make sketch) showing farm, center of section, this location with measurements and also wells, dry holes, or other locations in the vicinity of this location.

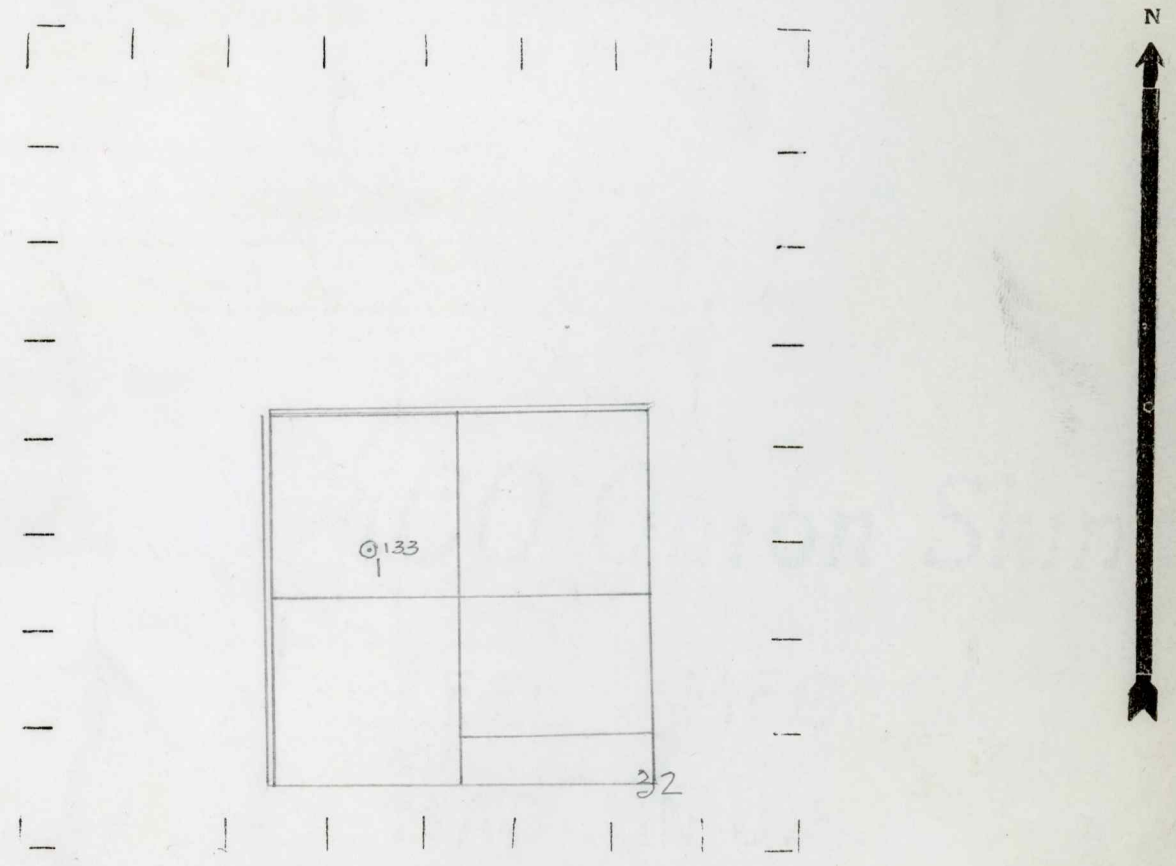

REMARKS:  
 \_\_\_\_\_  
 \_\_\_\_\_  
 \_\_\_\_\_

SIGNED \_\_\_\_\_  
 Superintendent or Foreman.

Date **September 24, 1941** No. **133**  
 State **Mich.** County **Osceola** ~~Dist.~~ **Lincoln** Sec. **32** Twp. **18 N** Rge. **10 W**  
 Well No. **1** (Serial No.) **133** Farm **Mary Lomp** Acres \_\_\_\_\_  
 Operator **Gulf Refining Company** Information secured ~~from~~ **By Scouting Department**  
 Date well started **8-16-41** Date well completed **9-18-41** Elevation **1144.6**  
 (Second hole) **8-30-41**

PRODUCTION RECORD

1st 24 hours natural **3600 Barrels**  
 2nd 24 hours natural \_\_\_\_\_  
 Date of shot \_\_\_\_\_ No. of quarts \_\_\_\_\_ From \_\_\_\_\_ to \_\_\_\_\_ From \_\_\_\_\_ to \_\_\_\_\_  
 Date of acid \_\_\_\_\_ No. of gallons \_\_\_\_\_  
 1st 24 hours after acid shot \_\_\_\_\_  
 2nd 24 hours after acid shot \_\_\_\_\_

FORMATION AND CASING RECORD

Formation	Top	Bottom	Top Pay	Bottom Pay	Remarks	Casing	
						Size	Set at
Brown Dolomite	1135					10"	409
Stray	1240						
Antrim	2650	2905				8-1/4"	1515
Traverse Lime	2940					5-3/16"	3593
Dundee	3511						
Monroe	3584		3605 1/2	3609 1/2			
			3616	3621			
Total Depth		3623					

Remarks \_\_\_\_\_