



Western Michigan University
ScholarWorks at WMU

Legacy Scout Tickets from Pure Oil Company

8-20-2021

**MGRRE_PureOilScoutTickets_Campbell, Fred
B_2_21133089320000**

MGRRE
Western Michigan University

Follow this and additional works at: <https://scholarworks.wmich.edu/pure>



Part of the Geology Commons

WMU ScholarWorks Citation

MGRRE, "MGRRE_PureOilScoutTickets_Campbell, Fred B_2_21133089320000" (2021). *Legacy Scout Tickets from Pure Oil Company*. 8242.
<https://scholarworks.wmich.edu/pure/8242>

This Document is brought to you for free and open access via ScholarWorks at WMU. It has been accepted for inclusion in Legacy Scout Tickets from Pure Oil Company by an authorized administrator of ScholarWorks at WMU. See the National Digital Catalogue - Science Base Catalogue for more collections submitted by MGRRE.



MGRRE_PureOilScoutTickets_Campbell, Fred B_2_21133089320000

API 21133089320000

Permit Number 8932

Lease Name Campbell, Fred B

Well Number 2

County Osceola

Township 18N

Range 10W

Section 19

2021 DEQ or Pure co_name Mid Michigan Gas well in Stray. Stratigraphic and production data.
orage Company

Pure Number 148

Latitude 43.9334627

Longitude -85.5599178

DATE September 4, 1941

LOCATION REPORT

No. 148 *

STATE Michigan COUNTY Osceola DIST. Lincoln TWP. Lincoln SEC. 19 TOWN 18 N RANGE 10 W
WELL No. 2 (SERIAL No. 148) FARM Fred B. Campbell ACRES

NAME OF STREAM OR WATERS _____ QUADRANGLE C N 3/4 SW SW

OPERATOR Gulf Refining Company Map Lincoln Township, Osceola County

329 329 Feet from North Line of Farm
667 667 " " East " " "
" " South " " "
" " West " " "
Feet from North Line of Section
984 984 " " South " 1/4
670 670 " " West " " "

405
Sp 8-30-41
10" 25P
405

LEGEND

- LOCATION
- ⊕ RIG
- ⊕ DRILLING
- ☀ GAS WELL
- OIL WELL
- SMALL OIL WELL
- ⊙ DRY HOLE
- ◆ DRY SHOWING OIL
- ⊙ DRY SHOWING GAS
- ⊙ ABANDONED LOCATION
- ☀ ABANDONED GAS WELL
- ABANDONED OIL WELL

NOTE: Below make tracing from map. (when no map is obtainable make sketch) showing farm, center of section, this location with measurements and also wells, dry holes, or other locations in the vicinity of this location.

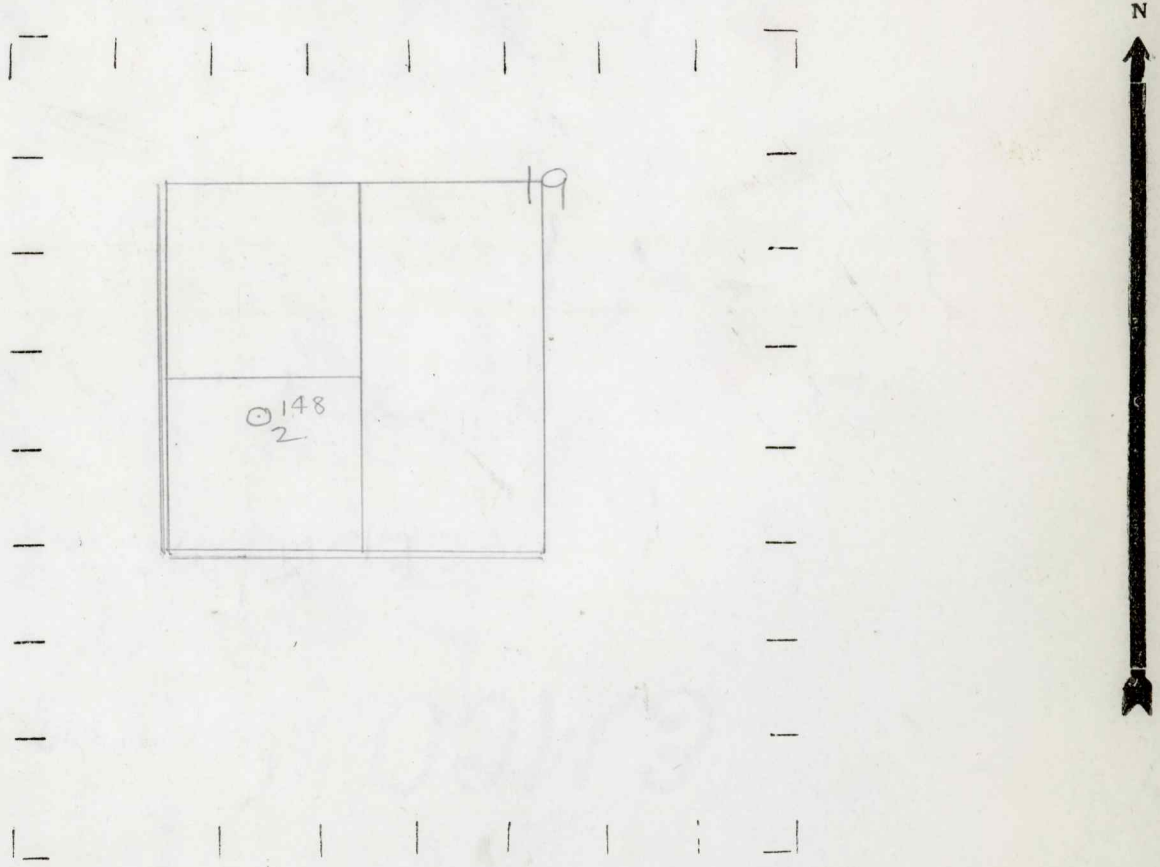

REMARKS: _____

SIGNED W
Superintendent or Foreman.

358
 OBEYVLOB GULF REFINING COMPANY
 NAME OF OPERATOR OF WELLS
 WELL NO. (SERIAL NO. 148) FURN

Date **10-1-41** No. **148**
 State **Mich.** County **Osceola** Dist. **Lincoln** Twp. **19** Sec. **19** Twp. **18 N** Rge. **10 W**
 Well No. **2** (Serial No.) **148** Farm **Fred B. Campbell** Acres
 Operator **Gulf Refining Company** Information secured ~~from~~ **Scouting Department**
 Date well started **8-30-41** Date well completed **9-21-41** Elevation **1148.6**

PRODUCTION RECORD

15
 1st ~~24~~ hours natural **238 Barrels**
 2nd 24 hours natural
 Date of shot No. of quarts From to From to
 Date of acid **9-23-41** No. of gallons **500**
~~shot~~
 1st 24 hours after acid **2664 Barrels**
 shot
 2nd 24 hours after acid

FORMATION AND CASING RECORD

Formation	Top	Bottom	Top Pay	Bottom Pay	Remarks	Casing	
						Size	Set at
Brown Dolomite	1130					10"	405
Stray	1220					8-1/4"	1536
Antrim	2588	2900				5-3/16"	3598
Traverse Lime	2930						
Dundee	3513						
Monroe	3588		3605 1/2	3608 1/2			
			3615 1/2	3621 1/2			
Total Depth		3623					

Remarks

Signed **D. C. Shackelford**