



Western Michigan University  
ScholarWorks at WMU

---

Legacy Scout Tickets from Pure Oil Company

---

8-20-2021

**MGRRE\_PureOilScoutTickets\_Kremmin,  
Minnie\_1\_21133089390000**

MGRRE  
*Western Michigan University*

Follow this and additional works at: <https://scholarworks.wmich.edu/pure>



Part of the Geology Commons

---

#### **WMU ScholarWorks Citation**

MGRRE, "MGRRE\_PureOilScoutTickets\_Kremmin, Minnie\_1\_21133089390000" (2021). *Legacy Scout Tickets from Pure Oil Company*. 8243.  
<https://scholarworks.wmich.edu/pure/8243>

This Document is brought to you for free and open access via ScholarWorks at WMU. It has been accepted for inclusion in Legacy Scout Tickets from Pure Oil Company by an authorized administrator of ScholarWorks at WMU. See the National Digital Catalogue - Science Base Catalogue for more collections submitted by MGRRE.



---

**MGRRE\_PureOilScoutTickets\_Kremmin, Minnie\_1\_21133089390000**

API 21133089390000

Permit Number 8939

Lease Name Kremmin, Minnie

Well Number 1

County Osceola

Township 18N

Range 10W

Section 8

2021 DEQ or Pure co\_name Mid Michigan Gas well in Stray. Stratigraphic and production data.  
orage Company

Pure Number 155

Latitude 43.9599721

Longitude -85.5252067

DATE September 10, 1941

LOCATION REPORT

No. 155

STATE Michigan COUNTY Osceola DIST. Lincoln TWP. Lincoln SEC. 88 TOWN 18 N RANGE 10 W  
WELL No. 1 (SERIAL No. 155) FARM Minnie Kremmin ACRES

NAME OF STREAM OR WATERS \_\_\_\_\_ QUADRANGLE C 3 1/2 SESE

OPERATOR W. Spencer Cook & Voorhees Drlg. Co. Map Lincoln Township, Osceola County  
W. Spencer Cook & Voorhees Drlg Co. Lincoln - Osceola

Feet from North Line of Farm  
660 660 " " East " " "  
330 330 " " South " " "  
660 660 " " West " " "

Feet from North Line of Section  
660 660 " " East " 1/4  
330 330 " " South " " "  
" " West " " "

LEGEND

- LOCATION
- ⊕ RIG
- ⊕ DRILLING
- ☀ GAS WELL
- OIL WELL
- ⬮ SMALL OIL WELL
- ⊖ DRY HOLE
- ⬮ DRY SHOWING OIL
- ☀ DRY SHOWING GAS
- ⊖ ABANDONED LOCATION
- ☀ ABANDONED GAS WELL
- ⬮ ABANDONED OIL WELL

NOTE: Below make tracing from map, (when no map is obtainable make sketch) showing farm, center of section, this location with measurements and also wells, dry holes, or other locations in the vicinity of this location.

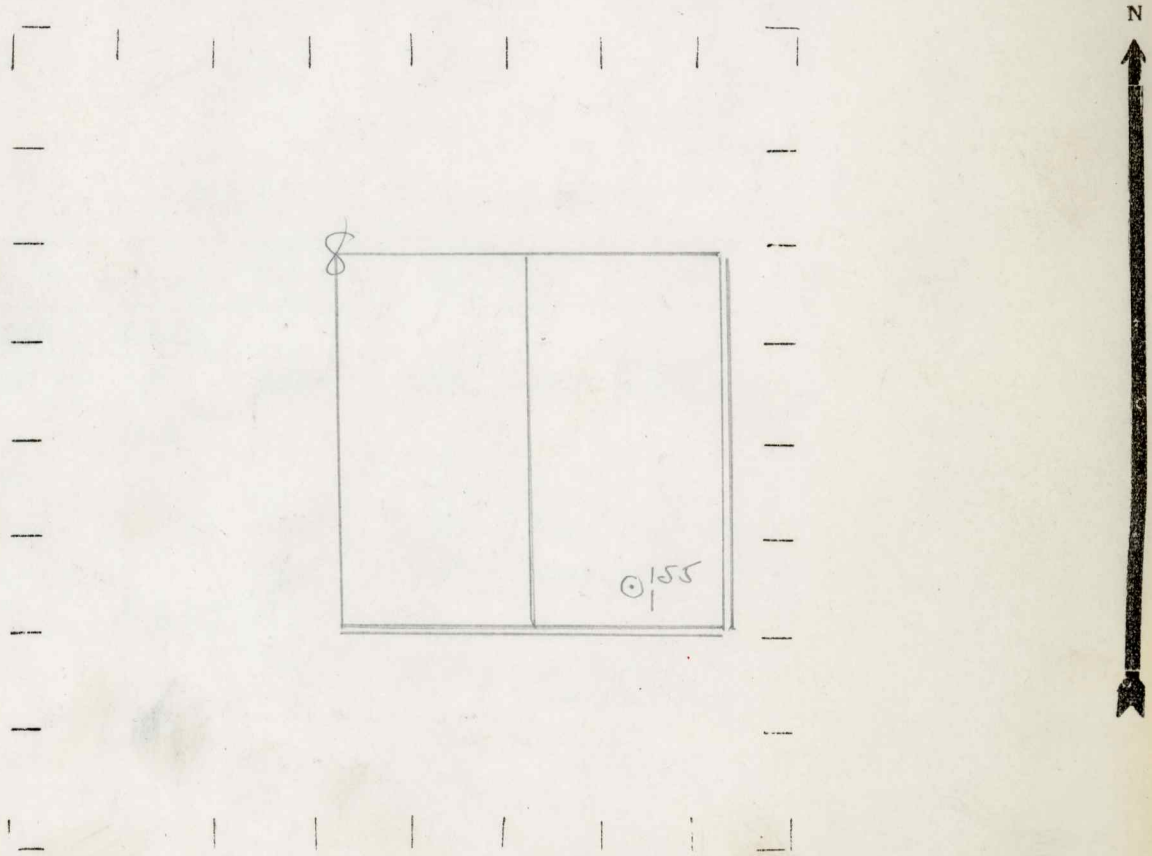

REMARKS:

\_\_\_\_\_  
\_\_\_\_\_  
\_\_\_\_\_

SIGNED

W

Superintendent or Foreman.



