



Western Michigan University
ScholarWorks at WMU

Legacy Scout Tickets from Pure Oil Company

8-20-2021

MGRRE_PureOilScoutTickets_Fatum, Emma_3_21133089440000

MGRRE

Western Michigan University

Follow this and additional works at: <https://scholarworks.wmich.edu/pure>



Part of the Geology Commons

WMU ScholarWorks Citation

MGRRE, "MGRRE_PureOilScoutTickets_Fatum, Emma_3_21133089440000" (2021). *Legacy Scout Tickets from Pure Oil Company*. 8245.

<https://scholarworks.wmich.edu/pure/8245>

This Document is brought to you for free and open access via ScholarWorks at WMU. It has been accepted for inclusion in Legacy Scout Tickets from Pure Oil Company by an authorized administrator of ScholarWorks at WMU. See the National Digital Catalogue - Science Base Catalogue for more collections submitted by MGRRE.



MGRRE_PureOilScoutTickets_Fatum, Emma_3_21133089440000

API 21133089440000

Permit Number 8944

Lease Name Fatum, Emma

Well Number 3

County Osceola

Township 18N

Range 10W

Section 30

2021 DEQ or Pure co_name Mid Michigan Gas well in Stray. Stratigraphic and production data.
orage Company

Pure Number 157

Latitude 43.9186275

Longitude -85.5452395

WELL REPORT - OUTSIDE OPERATIONS THE PURE OIL COMPANY

157

SERIAL NO. 157

STATE Michigan ^{PSI} CO. Osceola

OPERATOR The Ohio Oil Co.

FARM Emma Fatum WELL NO. 3

TWP. Lincoln SURVEY S. 30 T. 18N R. 10W

LOC. C N 1/2 SE SE

WILDCAT FIELD FIELD NAME

MAP NO. CO-ORD. ELEV.

STATUS To deepen Reed City Zone producing well approx. 1100' to test the richfield zone.

SW 6 1/4 Fl. Bd. - NET. - 24 hrs.

NORTH

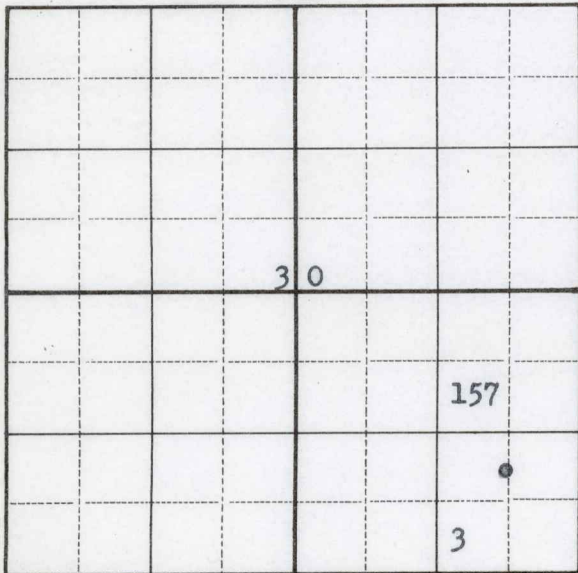

DATE 5-31-55 SCOUT JEC

DATE September 10, 1941 LOCATION REPORT
 STATE Michigan COUNTY Osceola DIST. Lincoln TWP. Lincoln SEC. 30 TOWN 18 N RANGE 10 W
 WELL No. 3 (SERIAL No. 157) FARM Edna Fatum ACRES _____
 No. 157

NAME OF STREAM OR WATERS _____ QUADRANGLE C 1/2 SESE

OPERATOR Weber Oil Company Map Lincoln Township, Osceola County

330 330 Feet from North Line of Farm
660 " " East " " "

" " South " " "
 " " West " " "

Feet from North Line of Section
660 660 " " East 1/4 1/4

990 990 " " South " " "
 " " West " " "

- LEGEND**
- LOCATION
 - ⊕ RIG
 - ⊕ DRILLING
 - ☀ GAS WELL
 - OIL WELL
 - ⬇ SMALL OIL WELL
 - ⊙ DRY HOLE
 - DRY SHOWING OIL
 - ☀ DRY SHOWING GAS
 - ⊙ ABANDONED LOCATION
 - ☀ ABANDONED GAS WELL
 - ABANDONED OIL WELL

NOTE: Below make tracing from map. (when no map is obtainable make sketch) showing farm, center of section, this location with measurements and also wells, dry holes, or other locations in the vicinity of this location.

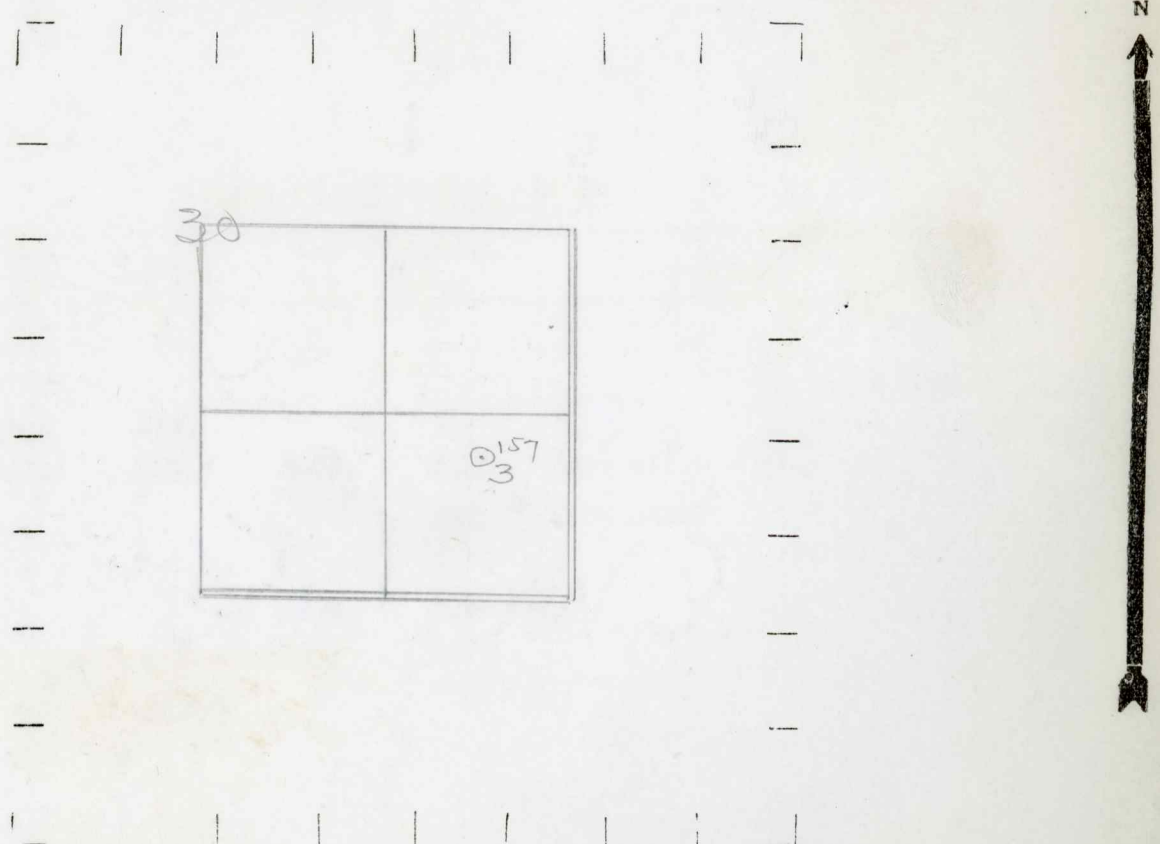

REMARKS: _____

SIGNED W
 Superintendent or Foreman.

890
330
OBERVALOV
Mepel Oil Company
330 Mepel Oil Company

MSB
LINCOLN
OSCEOLA COUNTY
OSCEOLA COUNTY
VCLES

Date November 19, 1941 No. 157
State Mich. County Osceola Dist. Lincoln
Twp. Lincoln Sec. 30 Twp. 18 N Rge. 10 W
Well No. 3 (Serial No.) 157 Farm Emma Fatum Acres _____
Operator Weber Oil Company Information secured By Scouting Department
Date well started 10-9-41 Date well completed 11-15-41 Elevation 1084.4

PRODUCTION RECORD

1st 24 hours natural 2460 Barrels
2nd 24 hours natural _____
Date of shot _____ No. of quarts _____ From _____ to _____ From _____ to _____
Date of acid _____ No. of gallons _____
1st 24 hours after acid shot _____
2nd 24 hours after acid shot _____

FORMATION AND CASING RECORD

Formation	Top	Bottom	Top Pay	Bottom Pay	Remarks	Casing	
						Size	Set at
Brown Dolomite	1178					10"	405
Stray	1280					6-5/8"	1500
Antrim	2642	2820				5-3/16"	3512
Traverse Lime	2850	G.T.M.	2855	2865	Show oil and gas.		
				2880	Salt water.		
Dundee	3442	S.L.M.					
Monroe	3514		3530	3534			
			3538	3539			
Total Depth		3539					

Remarks 3414' CTM equals 3412' SLM.

Signed D. C. Shackelford