



Western Michigan University
ScholarWorks at WMU

Legacy Scout Tickets from Pure Oil Company

8-20-2021

MGRRE_PureOilScoutTickets_Gas Unit No 3_1_21133090390000

MGRRE

Western Michigan University

Follow this and additional works at: <https://scholarworks.wmich.edu/pure>



Part of the Geology Commons

WMU ScholarWorks Citation

MGRRE, "MGRRE_PureOilScoutTickets_Gas Unit No 3_1_21133090390000" (2021). *Legacy Scout Tickets from Pure Oil Company*. 8259.

<https://scholarworks.wmich.edu/pure/8259>

This Document is brought to you for free and open access via ScholarWorks at WMU. It has been accepted for inclusion in Legacy Scout Tickets from Pure Oil Company by an authorized administrator of ScholarWorks at WMU. See the National Digital Catalogue - Science Base Catalogue for more collections submitted by MGRRE.



MGRRE_PureOilScoutTickets_Gas Unit No 3_1_21133090390000

API 21133090390000

Permit Number 9039

Lease Name Gas Unit No 3

Well Number 1

County Osceola

Township 19N

Range 08W

Section 25

2021 DEQ or Pure co_name Turner Petroleum Corporation

Pure Number 176

Latitude 44.01182

Longitude -85.22647

THE PURE OIL COMPANY

DATE 10-8-41

LOCATION REPORT

No. 1767

COMPLETION RECORD OF WELLS DRILLED BY OTHER OPERATORS

STATE Michigan COUNTY Osceola DISTRICT Hartwick TWP Hartwick SEC 25 TOWN 19 N RANGE 8 W

WELL No. 33 (SERIAL No. 176) FARM PREC. Gas Unit

NAME OF STREAM OR WATERS QUADRANGLE NW SW NW

OPERATOR Turner Petroleum Corporation Map Hartwick Township, Osceola County

Turner Pet Corp

Hartwick - Osceola

Feet from North Line of Farm

1120 1120 " " East " " "

1120 1120 " " South " " "

" " West " " "

Feet from North Line of Section

" " East " " "

1120 1120 " " South " 1/4 1/4 "

50 50 " " West " " "

1470
Sp 10-2-41
8 1/4 299

LEGEND

O LOCATION

⊖ DRY HOLE

⊕ RIG

⊖ DRY SHOWING OIL

⊕ DRILLING

⊖ DRY SHOWING GAS

☀ GAS WELL

⊖ ABANDONED LOCATION

● OIL WELL

☀ ABANDONED GAS WELL

● SMALL OIL WELL

● ABANDONED OIL WELL

NOTE: Below make tracing from map. (when no map is obtainable make sketch) showing farm, center of section, this location with measurements and also wells, dry holes, or other locations in the vicinity of this location.

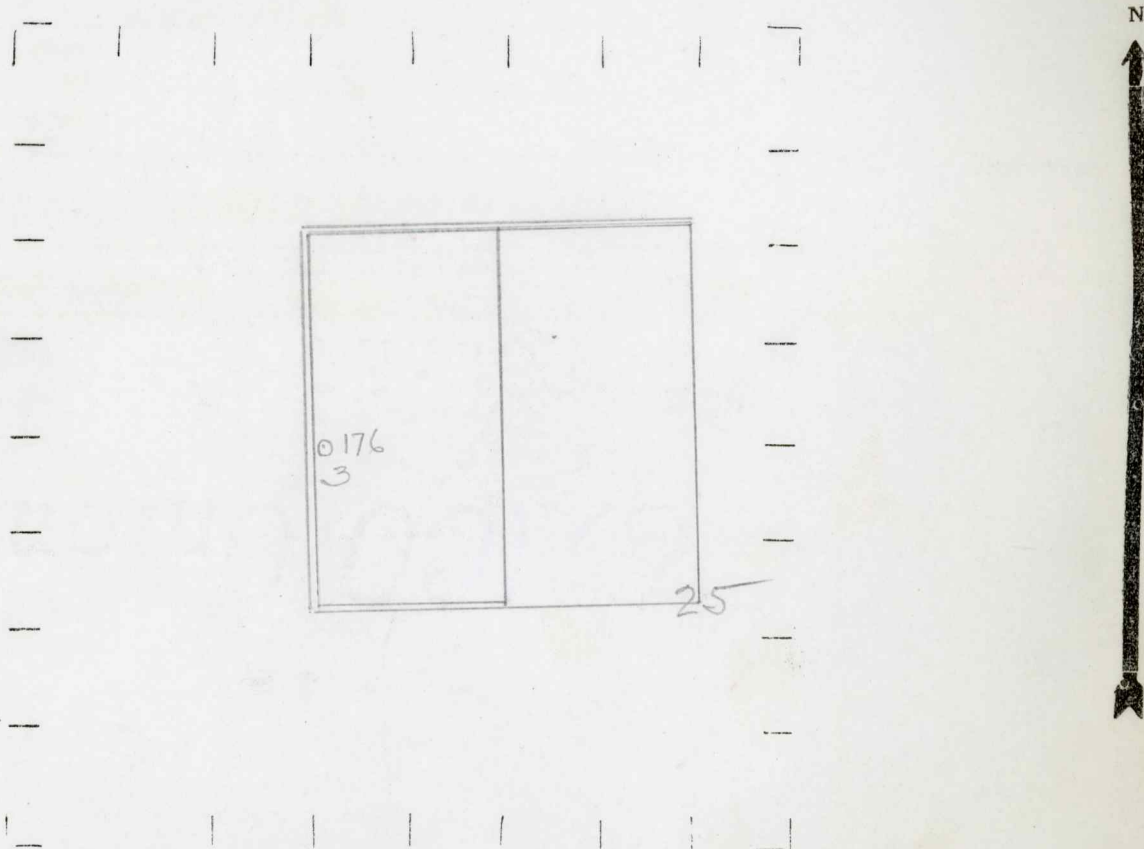

REMARKS:

SIGNED

W

Superintendent or Foreman.

J

Keep from bottom line of page

OBSERVER Turner Petroleum Corporation

WSP Hartwick - Osceola County

NAME OF STREAM OR WATERS

BLVDKVIAGRE

Date 10-22-41

No. 176

State Mich. County Osceola Dist. Twp. Hartwick Sec. 25 Twp. 19-N Rge. 8-W

Well No. 3 (Serial No.) (County No.) 176 Farm Gas Unit Acres

Operator Turner Petroleum Corp. Information secured By Scouting Dept.

Date well started 10-2-41 Date well completed 10-14-41 Elevation 1186.7

PRODUCTION RECORD

1st 24 hours natural Dry Hole

2nd 24 hours natural

Date of shot No. of quarts From to From to

Date of acid No. of gallons

1st 24 hours after acid shot

2nd 24 hours after acid shot

FORMATION AND CASING RECORD

Formation	Top	Bottom	Top Pay	Bottom Pay	Remarks	Casing	
						Size	Set at
Brown Dolomite	1503					8-5/8"	299'
Mich. Stray	1618				Small Show oil 1633-36	5-3/16"	1590'
					Show S.W. 1639-40		
Total Depth		1640					

Remarks

Signed Dean C. Shackelford