



Western Michigan University
ScholarWorks at WMU

Legacy Scout Tickets from Pure Oil Company

8-20-2021

**MGRRE_PureOilScoutTickets_Johnson, Richard, &
Eichenberg_25_21133090500000**

MGRRE

Western Michigan University

Follow this and additional works at: <https://scholarworks.wmich.edu/pure>



Part of the Geology Commons

WMU ScholarWorks Citation

MGRRE, "MGRRE_PureOilScoutTickets_Johnson, Richard, & Eichenberg_25_21133090500000" (2021).

Legacy Scout Tickets from Pure Oil Company. 8261.

<https://scholarworks.wmich.edu/pure/8261>

This Document is brought to you for free and open access via ScholarWorks at WMU. It has been accepted for inclusion in Legacy Scout Tickets from Pure Oil Company by an authorized administrator of ScholarWorks at WMU. See the National Digital Catalogue - Science Base Catalogue for more collections submitted by MGRRE.



**MGRRE_PureOilScoutTickets_Johnson, Richard, &
Eichenberg_25_21133090500000**

API 21133090500000

Permit Number 9050

Lease Name Johnson, Richard, & Eichenberg

Well Number 25

County Osceola

Township 18N

Range 10W

Section 17

2021 DEQ or Pure co_name Mid Michigan Gas well in Stray. Stratigraphic and production data.
orage Company

Pure Number 178

Latitude 43.948166

Longitude -85.5374062

THE PURE OIL COMPANY

No. 178*

DATE 10-8-41

Date February 25, 1944

LOCATION REPORT

A.F.E. No. _____

Division Mich. Producing District _____ Lease Johnson-Richard-Eichenberg

Acres _____ Lease No. _____ Elevation _____ Well No. 25 (Serial No. 178)

Quadrangle C SW Sec. 17 Twp. 18 N Rge. 10 W ^{Block} _{District} Twp. Lincoln

Survey _____ County Osceola State Michigan

Operator Taggart Brothers Company Map Lincoln Township, Osceola County

____ Feet from North Line of Lease
 ____ " " East " " "
 ____ " " South " " "
 ____ " " West " " "
 ____ Feet from North Line of Section
 ____ " " East " " "
 ____ " " South " " "
 ____ " " West " " "

LEGEND

- Location
- ☀ Gas Well
- Oil Well
- ☀ Gas - Distillate Well
- ∅ or ○ Dry Hole
- Dry Showing Oil
- ☀ Dry Showing Gas
- ⊗ Abandoned Location
- ☀ or ☀ Abandoned Gas Well
- or ● Abandoned Oil Well
- or ○ Input Well

N



See plat No. 178 -
 Plugged and abandoned 1-19-44.
 Total Depth 1243'.

Scale _____

Remarks: _____

Submitted by _____ Civil Engineer Approved by _____ Division Manager

Approved by _____ Vice-President - General Manager

Date February 27 1944 STATE Michigan COUNTY Osceola DISTRICT Lincoln TWP. Lincoln SEC. 17 TOWN 18 N RANGE 10 W
WELL No. 25 (SERIAL No. 178) FARM Johnson-Richard-Eichenberg ACRES _____

NAME OF STREAM OR WATERS _____ QUADRANGLE OSW

OPERATOR Taggart Brothers Company Map Lincoln Township, Osceola County
Taggart Bros Co. Lincoln - Osceola

1320 1320 Feet from North Line of Farm
1320 1320 " " East " " "
" " South " " "
" " West " " "
Feet from North Line of Section
" " East " " "
1320 1320 " " South " 1/4 "
1320 1320 " " West " " "

re 400
Sp 10-5-41
8 1/4 400

- LOCATION
- ⊕ RIG
- ⊕ DRILLING
- ☀ GAS WELL
- OIL WELL
- SMALL OIL WELL

- LEGEND**
- ⊙ DRY HOLE
 - DRY SHOWING OIL
 - ☀ DRY SHOWING GAS
 - ⊙ ABANDONED LOCATION
 - ☀ ABANDONED GAS WELL
 - ABANDONED OIL WELL

NOTE: Below make tracing from map. (when no map is obtainable make sketch) showing farm, center of section, this location with measurements and also wells, dry holes, or other locations in the vicinity of this location.

1-19-44

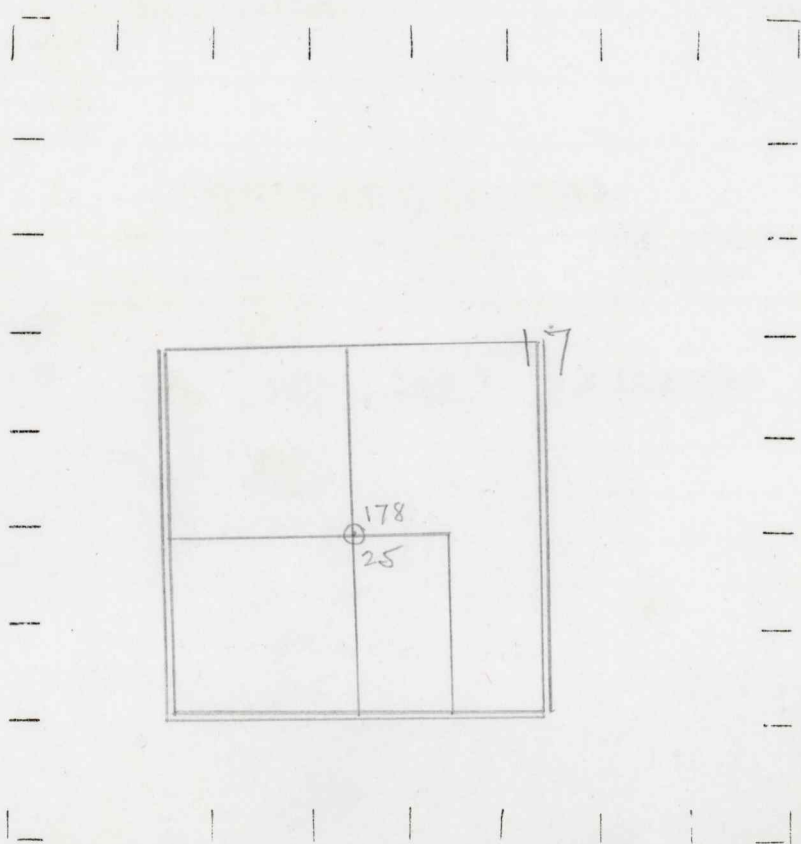

REMARKS: _____

SIGNED _____
Superintendent or Foreman.

J

T350 1330
T350 1330
OБЪЕКТОВЪ ПЕРСОНАЛЬНОСТИ КОМПАНИИ

OSCEOLA COUNTY

Date **October 22, 1941** No. **178**
State **Mich.** County **Osceola** Dist. _____
Twp. **Lincoln** Sec. **17** Twp. **18-N** Rge. **10-W**
Well No. **25** (County No.) **178** Farm **Johnson-Richard-Eichenberg** Acres _____
Operator **Taggart Brothers Co.** Information secured from **Scouting Department**
Date well started **10-5-41** Date well completed **10-11-41** Elevation **1141.3**

PRODUCTION RECORD

1st 24 hours natural **1,230,000 cu. ft. of gas**
2nd 24 hours natural _____
Date of shot _____ No. of quarts _____ From _____ to _____ From _____ to _____
Date of acid _____ No. of gallons _____
1st 24 hours after acid shot _____
2nd 24 hours after acid shot _____

FORMATION AND CASING RECORD

Formation	Top	Bottom	Top Pay	Bottom Pay	Remarks	Casing	
						Size	Set at
Brown Dolomite	1132					8-1/4"	400
Mich. Stray	1230		1235	1239	S.W. 1240-1243	5-3/16"	1232
Total Depth		1243					
Plugged back		1239					

Remarks _____

Signed **Dean C. Shackelford**