



Western Michigan University
ScholarWorks at WMU

Legacy Scout Tickets from Pure Oil Company

8-20-2021

MGRRE_PureOilScoutTickets_Auten, Fern L_3_21133090780000

MGRRE

Western Michigan University

Follow this and additional works at: <https://scholarworks.wmich.edu/pure>



Part of the Geology Commons

WMU ScholarWorks Citation

MGRRE, "MGRRE_PureOilScoutTickets_Auten, Fern L_3_21133090780000" (2021). *Legacy Scout Tickets from Pure Oil Company*. 8269.

<https://scholarworks.wmich.edu/pure/8269>

This Document is brought to you for free and open access via ScholarWorks at WMU. It has been accepted for inclusion in Legacy Scout Tickets from Pure Oil Company by an authorized administrator of ScholarWorks at WMU. See the National Digital Catalogue - Science Base Catalogue for more collections submitted by MGRRE.



MGRRE_PureOilScoutTickets_Auten, Fern L_3_21133090780000

API 21133090780000

Permit Number 9078

Lease Name Auten, Fern L

Well Number 3

County Osceola

Township 18N

Range 10W

Section 29

2021 DEQ or Pure co_name Mid Michigan Gas well in Stray. Stratigraphic and production data.
orage Company

Pure Number 189

Latitude 43.925773

Longitude -85.5351914

THE PURE OIL COMPANY

DATE 10-15-41

COMPLETION RECORD LOCATION REPORT OTHER OPERATORS

No. 189

STATE Michigan COUNTY Osceola DIST. Michigan TWP. Lincoln Division SEC. 29 TOWN 18 N RANGE 10 W

WELL No. 3 (SERIAL No. 189) FARM Fern L. Auten (Comm.) ACRES

NAME OF STREAM OR WATERS QUADRANGLE C N 1/2 SE NW

OPERATOR The Ohio Oil Company Map Lincoln Township, Osceola County

Feet from North Line of Farm

660 " " East " " "

990 " " South " " "

660 " " West " " "

Feet from North Line of Section

660 " " East " 1/4 "

990 " " South " " "

" " West " " "

LEGEND

- LOCATION
- ⊕ RIG
- ⊕ DRILLING
- ☀ GAS WELL
- OIL WELL
- ⊙ SMALL OIL WELL
- ⊙ DRY HOLE
- ⊙ DRY SHOWING OIL
- ⊙ DRY SHOWING GAS
- ⊙ ABANDONED LOCATION
- ☀ ABANDONED GAS WELL
- ⊙ ABANDONED OIL WELL

NOTE: Below make tracing from map, (when no map is obtainable make sketch) showing farm, center of section, this location with measurements and also wells, dry holes, or other locations in the vicinity of this location.

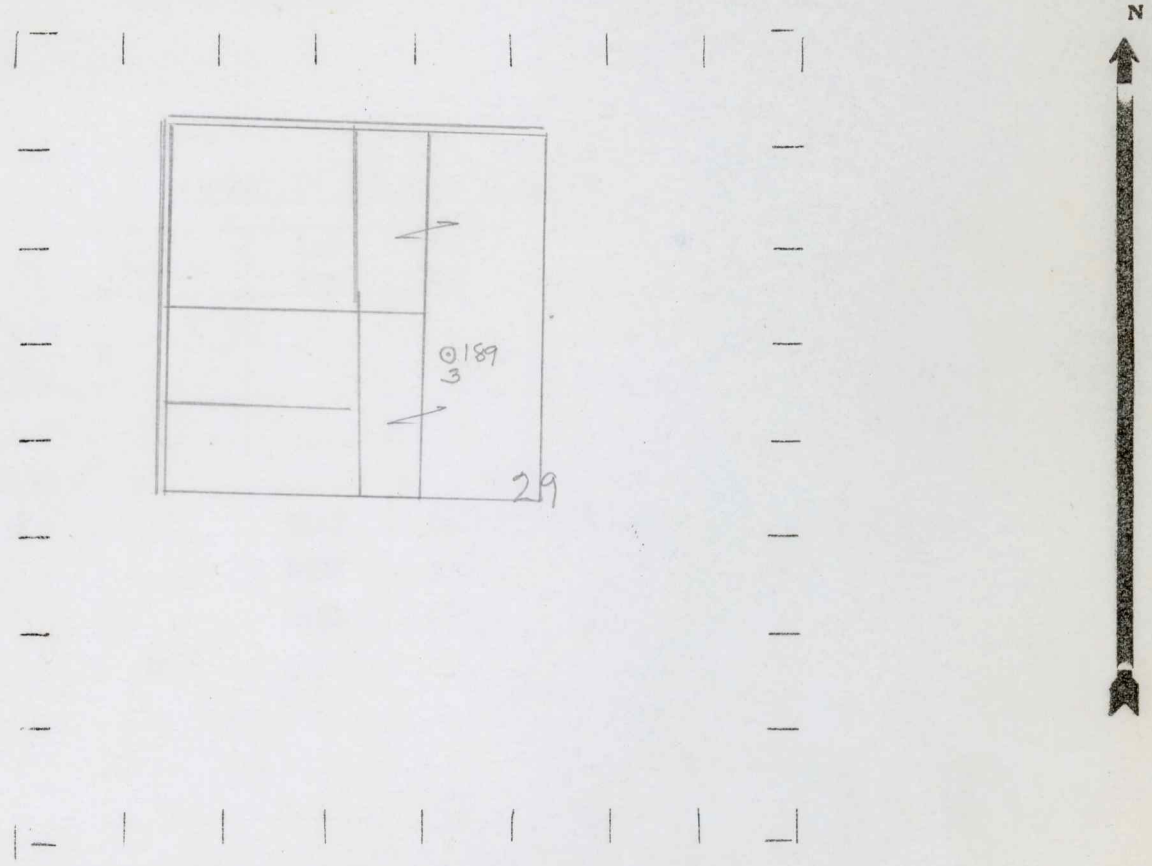

REMARKS:

.....

SIGNED

W

Subintendent or Foreman.

J

ОБЪЕКТОВЪ НА ОИТО ОИТЪ КОМПАНИА
 NAME OF ALKHEM OR MALENS
 WERT NO. 3 (SERIAL NO. 189) ELEVATION
 FIELD NO. 189 (COUNTY NO.)
 FIELD NO. 189 (COUNTY NO.)
 STATE OF OHIO OIL COMPANY
 DISTRICT OF OSCEOLA COUNTY
 ОУДАВАНІЕ С ИТЪ СЕ ИИ
 YOKER

Date December 10, 1941 No. 189
 State Mich. County Osceola Dist. Lincoln Sec. 29 Twp. 18 N Rge. 10 W
 (Serial No.)
 Well No. 3 (County No.) 189 Farm Fern L. Auten (Comm.) Acres _____
 Operator The Ohio Oil Company Information secured ~~from~~ Scouting Department
 By _____
 Date well started 10-24-41 Date well completed 12-2-41 Elevation 1082.2

PRODUCTION RECORD

1st 24 hours natural 2064 Barrels (Est.)
 2nd 24 hours natural _____
 Date of shot _____ No. of quarts _____ From _____ to _____ From _____ to _____
 Date of acid _____ No. of gallons _____
 shot _____
 1st 24 hours after acid _____
 shot _____
 2nd 24 hours after acid _____

FORMATION AND CASING RECORD

Formation	Top	Bottom	Top Pay	Bottom Pay	Remarks	Casing	
						Size	Set at
Brown Dolomite	1058					10"	660
Stray	1157					8-1/4"	1485
Traverse Line	2867					5-3/16"	3516
Dundee	3434						
Monroe	3508		3527	3529	(1500 ft. oil in 14 hrs.)		
			3538	3540			
			3554	3555			
Total Depth		3555					
Plugged Back		3547 1/2					

Remarks _____

Signed D. C. Shackelford