



Western Michigan University
ScholarWorks at WMU

Legacy Scout Tickets from Pure Oil Company

8-20-2021

**MGRRE_PureOilScoutTickets_Auten, Fern L
Comm_4_21133090790000**

MGRRE
Western Michigan University

Follow this and additional works at: <https://scholarworks.wmich.edu/pure>



Part of the Geology Commons

WMU ScholarWorks Citation

MGRRE, "MGRRE_PureOilScoutTickets_Auten, Fern L Comm_4_21133090790000" (2021). *Legacy Scout Tickets from Pure Oil Company*. 8270.
<https://scholarworks.wmich.edu/pure/8270>

This Document is brought to you for free and open access via ScholarWorks at WMU. It has been accepted for inclusion in Legacy Scout Tickets from Pure Oil Company by an authorized administrator of ScholarWorks at WMU. See the National Digital Catalogue - Science Base Catalogue for more collections submitted by MGRRE.



MGRRE_PureOilScoutTickets_Auten, Fern L Comm_4_21133090790000

API 21133090790000

Permit Number 9079

Lease Name Auten, Fern L Comm

Well Number 4

County Osceola

Township 18N

Range 10W

Section 29

2021 DEQ or Pure co_name Mid Michigan Gas well in Stray. Stratigraphic and production data.
orage Company

Pure Number 190

Latitude 43.92406

Longitude -85.5351

DATE 10-15-41

LOCATION REPORT

No. 190

STATE Michigan COUNTY Osceola TWP. Lincoln SEC. 29 TOWN 18 N RANGE 10 W

WELL No. 4 (SERIAL No. 190) FARM Fern L. Auten (Comm.) ACRES

NAME OF STREAM OR WATERS QUADRANGLE C S 1/2 SE NW

OPERATOR The Ohio Oil Company Map Lincoln Township, Osceola County

Feet from North Line of Farm

660 " " East " " "

330 " " South " " "

660 " " West " " "

Feet from North Line of Section

660 " " East " 1/4 "

330 " " South " " "

" " West " " "

LEGEND

○ LOCATION

⊕ RIG

⊕ DRILLING

☀ GAS WELL

● OIL WELL

● SMALL OIL WELL

⊖ DRY HOLE

● DRY SHOWING OIL

⊖ DRY SHOWING GAS

⊖ ABANDONED LOCATION

☀ ABANDONED GAS WELL

● ABANDONED OIL WELL

NOTE: Below make tracing from map, (when no map is obtainable make sketch) showing farm, center of section, this location with measurements and also wells, dry holes, or other locations in the vicinity of this location.

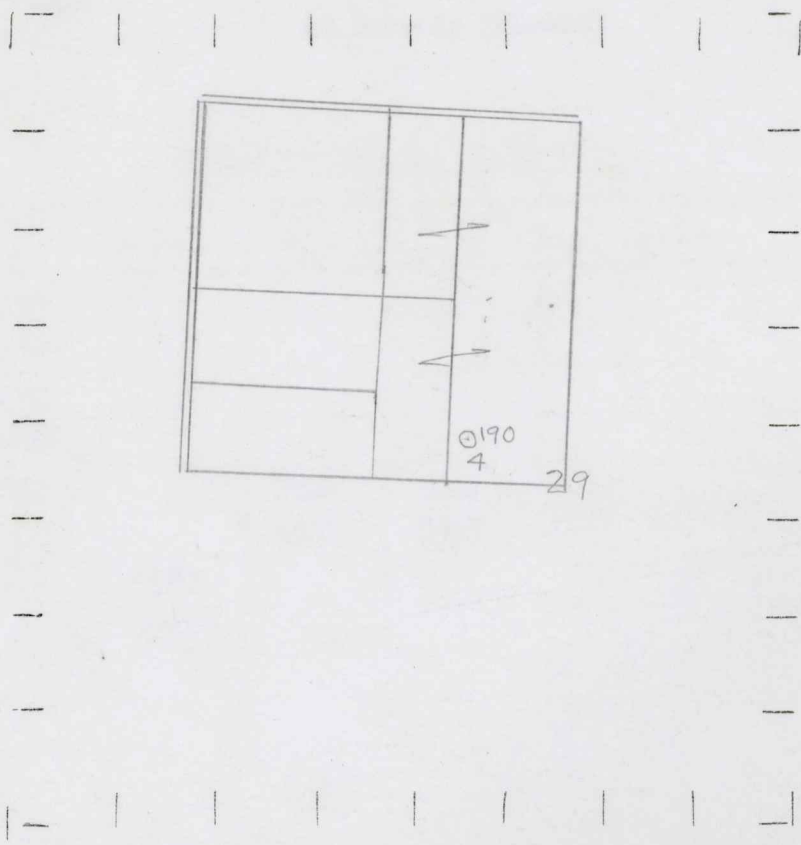

REMARKS:

SIGNED

W

Superintendent or Foreman.

g

